

CLASS OF SERVICE	SYMBOL
Telegram	
Day Letter	Blue
Night Message	Nite
Night Letter	N L

If none of these three symbols appears after the check (number of words) this is a telegram. Otherwise its character is indicated by the symbol appearing after the check.

WESTERN UNION TELEGRAM

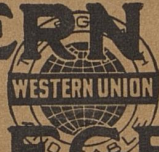

NEWCOMB CARLTON, PRESIDENT

GEORGE W. E. ATKINS, FIRST VICE-PRESIDENT

CLASS OF SERVICE	SYMBOL
Telegram	
Day Letter	Blue
Night Message	Nite
Night Letter	N L

If none of these three symbols appears after the check (number of words) this is a telegram. Otherwise its character is indicated by the symbol appearing after the check.

KW 96 DPR

RECEIVED AT

LOUISVILLE KY 325PM MAY 7 1920

MISS LAURA CLAY

LEXINGTON KY.

INSTRUCTIONS APPLIED TO YOU BY THE STATE CONVENTION WERE QUOTE
 TO VOTE FOR GOV COX OF OHIO UNQUOTE STOP SOME DOUBT HAS BEEN
 EXPRESSED OF BINDING QUALITY OF THIS INSTRUCTION STOP THE TIMES
 WOULD APPRECIATE A FEW WORDS FROM YOU AS TO YOUR CONSTRUCTION OF
 THAN LANGUAGE STOP DOES IT MEAN THAT WHEN YOU HAVE CAST ONE VOTE
 FOR COX YOU ARE ABSOLVED STOP IF SO SHALL YOU FOLLOW THAT COURSE
 STOP OR DOES IT MEAN AN INSTRUCTIONS TO VOTE FOR HIM UNTIL RELEASED
 STOP YOUR COLLEAGUES ARE BEING SENT SIMILAR TELEGRAMS STOP PLEASE
 WIRE COLLECT

THE TIMES

407PM

Telephone No. 3720
 Telephoned to Clay
 Time 4.12
 By C. B. to be

[May 7, 1920]

Form 1206

CLASS OF SERVICE DESIRED	
Telegram	<input type="checkbox"/>
Day Letter	<input type="checkbox"/>
Night Message	<input type="checkbox"/>
Night Letter	<input type="checkbox"/>

Patrons should mark an X opposite the class of service desired; OTHERWISE THE MESSAGE WILL BE TRANSMITTED AS A FULL-RATE TELEGRAM

WESTERN UNION TELEGRAM

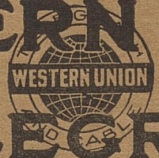

NEWCOMB CARLTON, PRESIDENT

GEORGE W. E. ATKINS, FIRST VICE-PRESIDENT

Receiver's No.
Check
Time Filed

Send the following message, subject to the terms on back hereof, which are hereby agreed to

I cannot undertake to construe ~~the~~ ^{State} instructions of the Convention. I shall vote for Cox according to the instructions of the Eighth District convention. I do not think that I shall be absolved by casting only one vote for Cox.
 Sandra Clay.

ALL MESSAGES TAKEN BY THIS COMPANY ARE SUBJECT TO THE FOLLOWING TERMS:

To guard against mistakes or delays, the sender of a message should order it REPEATED, that is, telegraphed back to the originating office for comparison. For this, one-half the unrepeated message rate is charged in addition. Unless otherwise indicated on its face, THIS IS AN UNREPEATED MESSAGE AND PAID FOR AS SUCH, in consideration whereof it is agreed between the sender of the message and this Company as follows:

1. The Company shall not be liable for mistakes or delays in the transmission or delivery, or for non-delivery, of any UNREPEATED message, beyond the amount received for sending the same; nor for mistakes or delays in the transmission or delivery, or for non-delivery, of any REPEATED message, beyond fifty times the sum received for sending the same, unless specially valued; nor in any case for delays arising from unavoidable interruption in the working of its lines; nor for errors in cipher or obscure messages.

2. In any event the Company shall not be liable for damages for any mistakes or delays in the transmission or delivery, or for the non-delivery, of this message, whether caused by the negligence of its servants or otherwise, beyond the sum of FIFTY DOLLARS, at which amount this message is hereby valued, unless a greater value is stated in writing hereon at the time the message is offered to the Company for transmission, and an additional sum paid or agreed to be paid based on such value equal to one-tenth of one per cent. thereof.

3. The Company is hereby made the agent of the sender, without liability, to forward this message over the lines of any other Company when necessary to reach its destination.

4. Messages will be delivered free within one-half mile of the Company's office in towns of 5,000 population or less, and within one mile of such office in other cities or towns. Beyond these limits the Company does not undertake to make delivery, but will, without liability, at the sender's request, as his agent and at his expense, endeavor to contract for him for such delivery at a reasonable price.

5. No responsibility attaches to this Company concerning messages until the same are accepted at one of its transmitting offices; and if a message is sent to such office by one of the Company's messengers, he acts for that purpose as the agent of the sender.

6. The Company will not be liable for damages or statutory penalties in any case where the claim is not presented in writing within sixty days after the message is filed with the Company for transmission.

7. Special terms governing the transmission of messages under the classes of messages enumerated below shall apply to messages in each of such respective classes in addition to all foregoing terms.

8. No employee of the Company is authorized to vary the foregoing.

THE WESTERN UNION TELEGRAPH COMPANY
INCORPORATED
NEWCOMB CARLTON, PRESIDENT

CLASSES OF SERVICE

TELEGRAMS

A full-rate expedited service.

NIGHT MESSAGES

Accepted up to 2.00 A.M. at reduced rates to be sent during the night and delivered not earlier than the morning of the ensuing business day.

DAY LETTERS

A deferred day service at rates lower than the standard telegram rates as follows: One and one-half times the standard Night Letter rate for the transmission of 50 words or less and one-fifth of the initial rates for each additional 10 words or less.

SPECIAL TERMS APPLYING TO DAY LETTERS:

In further consideration of the reduced rate for this special "Day Letter" service, the following special terms in addition to those enumerated above are hereby agreed to:

A. Day Letters may be forwarded by the Telegraph Company as a deferred service and the transmission and delivery of such Day Letters is, in all respects, subordinate to the priority of transmission and delivery of regular telegrams.

B. Day Letters shall be written in plain English. Code language is not permissible.

C. This Day Letter may be delivered by the Telegraph Company by telephoning the same to the addressee, and such delivery shall be a complete discharge of the obligation of the Telegraph Company to deliver.

D. This Day Letter is received subject to the express understanding and agreement that the Company does not undertake that a Day

Letter shall be delivered on the day of its date absolutely and at all events; but that the Company's obligation in this respect is subject to the condition that there shall remain sufficient time for the transmission and delivery of such Day Letter on the day of its date during regular office hours, subject to the priority of the transmission of regular telegrams under the conditions named above.

No employee of the Company is authorized to vary the foregoing.

NIGHT LETTERS

Accepted up to 2.00 A.M. for delivery on the morning of the ensuing business day, at rates still lower than standard night message rates, as follows: The standard telegram rate for 10 words shall be charged for the transmission of 50 words or less, and one-fifth of such standard telegram rate for 10 words shall be charged for each additional 10 words or less.

SPECIAL TERMS APPLYING TO NIGHT LETTERS:

In further consideration of the reduced rate for this special "Night Letter" service, the following special terms in addition to those enumerated above are hereby agreed to:

A. Night Letters may at the option of the Telegraph Company be mailed at destination to the addressees, and the Company shall be deemed to have discharged its obligation in such cases with respect to delivery by mailing such Night Letters at destination, postage prepaid.

B. Night Letters shall be written in plain English. Code language is not permissible.

No employee of the Company is authorized to vary the foregoing.

E. P. A. Callahan,

189 North Mill Street, Lexington, Kentucky.

May 10th, 1920.

Secretary of Democratic Headquarters,

Louisville, Ky.

Dear Sir:-

I observe that hotel accommodations have been secured for the Kentucky delegation to the national Democratic Convention in San Francisco; so I am writing at once to bespeak a room for myself.

I prefer a small room for one person; preferably with a bath, but I do not consider this essential.

Also, I shall wish to be with the Kentucky delegation on the train; and desire to secure a lower berth.

Any further information you can give me will be gratefully received. What railroad route has been decided upon? Will the terms allow return by a different route? I would like to return by the Canadian Pacific.

How long a time will the tickets be good, and what is approximately the cost of them and of the room at the hotel?

Very respectfully yours,

Willsie Hotel.

Kentucky Equal Rights Association

President
MRS. JOHN GLOVER SOUTH,
State Headquarters, Frankfort

First Vice President
MRS. E. L. HUTCHINSON, Lexington

Second Vice President
MISS LAURA CLAY, Lexington.

Third Vice President
MRS. JAMES A. LEECH, Louisville

Corresponding Secretary
MRS. THOMAS JEFFERSON SMITH,
Louisville.

Recording Secretary
MRS. ROBINSON A. McDOWELL,
Louisville.

Treasurer
MRS. J. B. JUDAH, Louisville

Auditor
MRS. JOSEPH ALDERSON
Middlesboro

State Member National Executive Council
MRS. EDMUND M. POST, Paducah

Chairman of Congressional Work
MRS. SAMUEL HENNING, Louisville

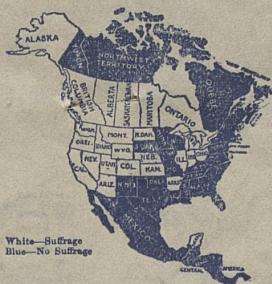

White—Suffrage
Blue—No Suffrage



Advisory Board

MISS LAURA CLAY,
Lexington

MRS. DESHA BEECKINRIDGE,
Lexington

MRS. THOMAS JEFFERSON SMITH,
Louisville

MRS. JAMES BENNETT,
Richmond

MRS. JOHN B. CASTLEMAN,
Louisville

MRS. S. M. HUBBARD,
Hickman

S. R. GLENN
SECRETARY

CHAS. A. HARDIN
CHAIRMAN

MAJA EUDALEY
ASST. SECRETARY

Democratic State Central and Executive Committees

SEELBACH HOTEL

LOUISVILLE, KY. May 10, 1920.

ADMINISTRATIVE COMMITTEE

State at Large

EXECUTIVES

P. H. CALLAHAN,
Louisville, Ky.
JOHNSON N. CAMDEN,
Versailles, Ky.
MRS. S. F. FETTER,
Ashland, Ky.
MRS. JOHN FULTON,
Bardstown, Ky.
CHAS. A. HARDIN,
Harrodsburg, Ky.
HARRY A. SOMMERS,
Elizabethtown, Ky.
MARION E. TAYLOR,
Louisville, Ky.

GENERAL

A. J. A. ALEXANDER,
Springs Station, Ky.
DESHA BRECKINRIDGE,
Lexington, Ky.
JAS. B. BROWN,
Louisville, Ky.
JOHN E. BUCKINGHAM,
Paintsville, Ky.
MRS. JOHN B. CASTLEMAN,
Louisville, Ky.
MRS. SAM'L. T. CASTLEMAN,
Louisville, Ky.
MRS. HARRISON G. FOSTER,
Lexington, Ky.
HARRY HANGER,
Richmond, Ky.
MRS. A. M. HARRISON,
Lexington, Ky.
ALEX P. HUMPHREY,
Louisville, Ky.
MRS. J. C. LAYNE,
Ft. Thomas, Ky.
MISS ALICE LLOYD,
Maysville, Ky.
MRS. EDMUND M. POST,
Paducah, Ky.
MRS. CORA WILSON STEWART,
Frankfort, Ky.
J. W. M. STEWART,
Ashland, Ky.
JAMES UTTERBACK,
Paducah, Ky.

Miss Laura Clay,
Lexington, Ky.

Dear Miss Clay:-

It is a pleasure to congratulate you, as well as the Party, on your election as a delegate to the "Prosperity" Convention at San Francisco.

It is the expectation of a few of us to make up a party which will start from Louisville on Monday June 21st, although we could as well meet each other on the North-Western Union Pacific train leaving Chicago Tuesday evening, June 22nd, which will bring us into San Francisco Friday afternoon.

Arrangements have been made by the National Committee for all of us to stop at the same hotel, and the National Committeeman from California, who is likewise Chairman of the Hotel Committee, is a very close friend of mine and it will be a pleasure for me to make arrangements for any of the delegates from Kentucky.

If the arrangements could be perfected, quite a party could go along together, and in this way break the monotony of a long train ride.

Very truly yours,

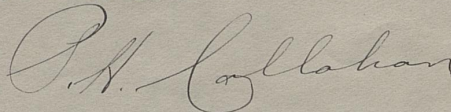

The Bishop's Residence
Lexington, Kentucky

May 11, 1920

Miss Laura Clay,
Lexington, Ky.

My dear Miss Clay:

Mrs. Burton bore to me your inquiry about the status of women in relation to the University of the South.

According to my understanding, the enclosed marked portions of Church papers state the facts in the case.

With very high esteem and respect,

I am

Faithfully yours,

Lewis M. Sutton

NATIONAL WOMEN'S TRADE UNION LEAGUE OF AMERICA

NATIONAL HEADQUARTERS, 64 WEST RANDOLPH STREET, CHICAGO, ILL.

OFFICERS

MRS. RAYMOND ROBINS PRESIDENT
CHICAGO WOMEN'S TRADE UNION LEAGUE
ROSE SCHNEIDERMAN VICE-PRESIDENT
PRES. NEW YORK WOMEN'S TRADE UNION LEAGUE
EMMA STEGHAGEN SECRETARY-TREASURER
BOOT AND SHOE WORKERS' UNION

EXECUTIVE BOARD

ELIZABETH CHRISTMAN GLOVE WORKERS' UNION
JO. COFFIN TYPOGRAPHICAL UNION
MABEL GILLESPIE OFFICE EMPLOYEES' UNION
SARAH GREEN WAITRESSES' UNION
AGNES NESTOR GLOVE WORKERS' UNION
PAULINE NEWMAN PHILADELPHIA WOMEN'S
TRADE UNION LEAGUE
JULIA O'CONNOR TEL. OPERATORS' UNION
HILDA SVENSON BOOKKEEPERS, STENOGRAPHERS
AND ACCOUNTANTS' UNION



LEGISLATIVE HEADQUARTERS
1423 NEW YORK AVENUE
WASHINGTON, D. C.

LEGISLATIVE COMMITTEE

MISS AGNES NESTOR
CHAIRMAN
MISS MARY DREIER
MISS NELLE A. QUICK
MISS ETHEL M. SMITH
SECRETARY

May 12, 1920.

Dear Friend:

This is to ask you for immediate legislative assistance in behalf of an appropriation for the Women's Bureau of the Department of Labor and also for two other services, provision for which was yesterday stricken out of the Sundry Civil Appropriation bill on a point of order.

I. The Women's Bureau. The Appropriations Committee reported to the House an appropriation of \$75,000 for the Women's Bureau, this being an increase of \$35,000 over last year's appropriation, which was \$40,000. The estimates of the Secretary of Labor for this Bureau amounted to \$150,000, and numerous women's organizations had asked for the full amount recommended.

By elimination of this item in the Sundry Civil bill as it passed the House, the entire question is put up to the Senate. Unless that body acts favorably the Women's Bureau will be left without funds to continue after July 1. The Campbell-Kenyon bill, making the Women's Bureau statutory and thereby proof against a point of order on its appropriation, has passed the House but not the Senate, and I am told today by Senator Kenyon, who has charge of the bill, that it will not be possible to get the statute enacted by the Senate until after the Sundry Civil bill is passed, and therefore not in time to protect the appropriation by this means. Therefore we have to look to the Senate Appropriations Committee, not only to make the appropriation, but to protect the item by a special rule, if necessary, in the Senate. If the Senate provides the appropriation in the Sundry Civil bill no point of order can be made against it when the bill goes back to the House.

Our request to you therefore is that you telegraph the Chairman of the Appropriations Committee and as many other members of the Committee as you may be willing to communicate with, asking them to provide the appropriation recommended by the Secretary of Labor for the Women's Bureau of that Department. The amount recommended, as stated above, is \$150,000.

Business Women

The Chairman of the Appropriations Committee is Senator Francis E. Warren of Wyoming. The other members are Senators Reed Smoot of Utah, Wesley L. Jones of Washington, Charles Curtis of Kansas, William S. Kenyon of Iowa, Lawrence Y. Sherman of Illinois, Asle J. Gronna of North Dakota, Frederick Hale of Maine, Selden P. Spencer of Missouri, Lawrence C. Phipps of Colorado, Truman H. Newberry of Michigan, Lee S. Overman of North Carolina, Robert L. Owen of Oklahoma, John Walter Smith of Maryland, Charles A. Culberson of Texas, Oscar W. Underwood of Alabama, Marcus A. Smith of Arizona, Edward J. Gay of Louisiana, William J. Harris of Georgia.

In addition to sending a telegram to the Chairman of the Appropriations Committee, will you please write at once to both Senators from your own State, asking them to support the appropriation when it comes to a vote in the Senate. There is time, except from the far distant states, for a letter to reach the Senators who are not on the Appropriations Committee, because they will not have to consider the matter until it comes to the floor and this probably cannot be sooner than the middle of next week.

II. Division of Negro Economics. An appropriation of \$15,000 for this work was also stricken from the Sundry Civil bill in the House on a point of order, and if this highly important piece of work is to be continued, an appropriation will have to be provided by the Senate.

III. Federal Employment Service. An item of \$225,000 for this Service met the same fate as the Women's Bureau appropriation and the Division of Negro Economics, and this Service therefore, if it is to be continued at all after July 1st, must be provided for in the Sundry Civil bill in the Senate.

If you agree with us that all of these services ought to be continued and are entitled to at least the amount mentioned, will you not include them all in your request to the Chairman of the Appropriations Committee and the Senators from your own State.

Appreciating your cooperation, I am

Sincerely yours,

Etzel M. Smith

Secretary Legislative Committee.

189 N. Mill St., Lexington, Ky.

May 13th, 1920.

Mr. P. H. Callahan,

Louisville, Ky.

Dear Sir:-

Your very kind letter of May 10 was received this morning.

The plan you outline for the Kentucky delegation to go to San Francisco seems to me very pleasant in every particular. I saw in the Louisville paper the clipping I enclose; and as I had made no plans for the trip, I wrote promptly to the secretary of the Democratic Headquarters in Louisville to bespeak a room at the hotel and a lower berth on the train.

I presume the clipping and your letter refer to the same plan; and if that is the case, I shall avail myself with great pleasure of your invitation to join the party in Louisville on June 21. I have not yet received an answer, however, to my letter to the secretary; and unless the clipping refers to your plan it may be the secretary has already acted on my request and made other arrangements for me. If there is no conflict, I accept gratefully your offer to make arrangements for me at the hotel and on the train; and I shall hope to hear further details from you.

Very truly yours,

SIXTY-FOURTH CONGRESS

JAMES C. CANTRILL, KY., CHAIRMAN.
WILLIAM A. JONES, VA.
COURTNEY W. HAMLIN, MO.
ISAAC R. SHERWOOD, OHIO.
EDWARD T. TAYLOR, COLO.
J. WILLARD RAGSDALE, S. C.
JAMES H. DAVIS, TEX.

FRANK P. WOODS, IOWA.
WILLIAM KENT, GAL.
JOHN R. K. SCOTT, PA.
HARRY H. PRATT, N. Y.
NELSON E. MATTHEWS, OHIO.
HENRY W. WATSON, PA.
CHARLES A. NICHOLS, MICH.

JO W. MORRIS, CLERK.

COMMITTEE ON INDUSTRIAL ARTS AND EXPOSITIONS

HOUSE OF REPRESENTATIVES U. S.

WASHINGTON, D. C.

1309 - Kenyon St.
May 14th 1920.

My dear Miss Laura -

To day, I received a communication from the Woman's Bureau of the Democratic National Committee, asking for a photograph & sketch of you - I sent in the names of our three women delegates from the State at large, so you will possibly hear directly from headquarters. I was asked to write & urge you to send in a picture & biographical data - such as complete an account as possible, for use in all Democratic papers of the nation - As, I am leaving Washington in a few days, will ask that you send direct to "Woman's Bureau, Democratic National Committee, - Woodward Building, Washington D.C.

Cordially - Ethel Lett Cantrell

S. R. GLENN
SECRETARY

CHAS. A. HARDIN
CHAIRMAN

MAJA EUDALEY
ASST. SECRETARY

Democratic State Central and Executive Committees

SEELBACH HOTEL



LOUISVILLE, KY. May 15, 1920.

ADMINISTRATIVE COMMITTEE

State at Large

EXECUTIVES

P. H. CALLAHAN,
Louisville, Ky.
JOHNSON N. CAMDEN,
Versailles, Ky.
MRS. S. F. FETTER,
Ashland, Ky.
MRS. JOHN FULTON,
Bardstown, Ky.
CHAS. A. HARDIN,
Harrodsburg, Ky.
HARRY A. SOMMERS,
Elizabethtown, Ky.
MARION E. TAYLOR,
Louisville, Ky.

GENERAL

A. J. A. ALEXANDER,
Springs Station, Ky.
DESHA BRECKINRIDGE,
Lexington, Ky.
JAS. B. BROWN,
Louisville, Ky.
JOHN E. BUCKINGHAM,
Paintsville, Ky.
MRS. JOHN B. CASTLEMAN,
Louisville, Ky.
MRS. SAM'L T. CASTLEMAN,
Louisville, Ky.
MRS. HARRISON G. FOSTER,
Lexington, Ky.
HARRY HANGER,
Richmond, Ky.
MRS. A. M. HARRISON,
Lexington, Ky.
ALEX P. HUMPHREY,
Louisville, Ky.
MRS. J. C. LAYNE,
Ft. Thomas, Ky.
MISS ALICE LLOYD,
Maysville, Ky.
MRS. EDMUND M. POST,
Paducah, Ky.
MRS. CORA WILSON STEWART,
Frankfort, Ky.
J. W. M. STEWART,
Ashland, Ky.
JAMES UTTERBACK,
Paducah, Ky.

Miss Laura Clay,
189 N. Mill St.,
Lexington, Ky.

My dear Miss Clay:-

Replying to your letters of May 10th and 13th, regarding arrangements for the "Prosperity" Convention at San Francisco.

You will observe that we have tentatively made arrangement to leave Louisville the night of Monday, June 21st, and Chicago the following day, and the National Committee has arranged to "billet" the Kentucky delegation at the Wilshire Hotel, which is just across the park from the St. Francis, and will see that you get the kind of accommodations specified.

Have not yet made up my mind as to the return route, but no doubt some of the Kentucky people will wish to return by the Canadian Pacific and stop over a day or so at the wonderful resorts.

Very truly yours,

P. H. Callahan

SHERMAN E. BURROUGHS
1ST DISTRICT NEW HAMPSHIRE

COMMITTEES:
MERCHANT MARINE AND FISHERIES
EDUCATION
REVISION OF THE LAWS
WOMAN SUFFRAGE

House of Representatives U. S.
Washington, D. C.

20 May 1920

Miss Laura Clay,
Lexington, Ky.

My dear Miss Clay:

The letter signed by yourself, Georgie H. B. Burton, and Caroline T. Scott dated May 15, 1920 and relating to H.R. #13,334 with reference to the prohibition of fishing of salmon in the Yukon River for the purpose of canning and export was duly received. I am much interested in this proposed legislation and have been giving considerable time and thought to it. Hearings have already been held by a sub-committee of the Committee on Merchant Marine and Fisheries, of which I am a member, and a report of some sort is expected in the near future.

I was especially pleased at the little personal reference in your letter. I do indeed remember you well and the very great pleasure it gave Mrs. Burroughs and me to have you stay with us during your little visit to our home city. You may be interested to know that my two oldest sons, whom you saw when you were there, are now in Dartmouth College, one a junior and one a freshman. My other two sons are with us here, the older of the two having just passed with very high rank his entrance examinations to the Naval Academy at Annapolis.

I certainly am at a loss to explain to you why New Hampshire has not yet granted presidential suffrage to women. I can think of no other reason than that our people were so positive that the Constitutional Amendment would be adopted in season for this year's elections that they considered further action unnecessary.

It has been very gratifying to me to have an opportunity as a member of Congress, to cast my vote on two separate occasions in favor of submitting this amendment and also to serve as a member of the committee which reported the resolution to the House.

Mrs. Burroughs joins me in warmest regards to you and the hope that if you should ever chance to come our way again you will certainly come to see us.

Very sincerely yours,

Sherman E. Burroughs

S. R. GLENN
SECRETARY

CHAS. A. HARDIN
CHAIRMAN

MAJIA EUDALEY
ASST. SECRETARY

Democratic State Central and Executive Committees

SEELBACH HOTEL

LOUISVILLE, KY. May 20, 1920.

ADMINISTRATIVE COMMITTEE

State at Large

EXECUTIVES

P. H. CALLAHAN,
Louisville, Ky.
JOHNSON N. CAMDEN,
Versailles, Ky.
MRS. S. F. FETTER,
Ashland, Ky.
MRS. JOHN FULTON,
Bardstown, Ky.
CHAS. A. HARDIN,
Harrodsburg, Ky.
HARRY A. SOMMERS,
Elizabethtown, Ky.
MARION E. TAYLOR,
Louisville, Ky.

GENERAL

A. J. A. ALEXANDER,
Springs Station, Ky.
DESHA BRECKINRIDGE,
Lexington, Ky.
JAS. B. BROWN,
Louisville, Ky.
JOHN E. BUCKINGHAM,
Paintsville, Ky.
MRS. JOHN B. CASTLEMAN,
Louisville, Ky.
MRS. SAM'L. T. CASTLEMAN,
Louisville, Ky.
MRS. HARRISON G. FOSTER,
Lexington, Ky.
HARRY HANGER,
Richmond, Ky.
MRS. A. M. HARRISON,
Lexington, Ky.
ALEX P. HUMPHREY,
Louisville, Ky.
MRS. J. C. LAYNE,
Ft. Thomas, Ky.
MISS ALICE LLOYD,
Maysville, Ky.
MRS. EDMUND M. POST,
Paducah, Ky.
MRS. CORA WILSON STEWART,
Frankfort, Ky.
J. W. M. STEWART,
Ashland, Ky.
JAMES UTTERBACK,
Paducah, Ky.

Mr. Jere A. Sullivan,
Richmond,
Ky.

Dear Jere:-

Having some good news-paper connections in San Francisco, would like to give the proper publicity to the prominent personages in the Kentucky delegation who will be attending the "Prosperity" Convention.

Therefore, could you have prepared for me an article of, say, two-hundred words of the "Who's Who" style on Miss Laura Clay, and also a historical sketch of two-hundred words on General Cassius Clay, which would be excellent news-copy under the circumstances.

You might also procure for me a picture of Miss Clay, and hoping this matter will have your very best attention, beg to remain,

Very truly yours,

A. N. Cannon

J. N. CAMDEN.
VERSAILLES, KENTUCKY.

May 21st, 1920.

Miss Laura Clay,
Lexington, Ky.
My dear Madam:-

Please advise me by return mail if possible, or at any rate before June 1st, whether you will attend the Democratic National Convention at San Francisco.

For your information I am enclosing approximate rates furnished me by the Union Pacific System, and also itinerary of the Governor James M. Cox Ohio Booster train, which will reach St. Louis June 20th, and can be joined there if desired, or the trip may be made in less time, (about 70 hours) from Chicago or St. Louis, leaving either place June 22nd. Please state your preference in this respect.

It is my intention to arrange for a special train for the Kentucky Delegation if feasible, so that the trip may be as pleasant and convenient as possible, but to do this it is necessary for me to know definitely and promptly how many delegates and alternates are going, so as to make the necessary arrangements, including hotel accommodations at San Francisco. Twenty-six rooms at the Wiltshire Hotel, San Francisco have already been secured, rates \$3.00 and \$4.00 per day, beginning June 25th.

I hope very much that you will arrange to attend the Convention.

Yours very truly,

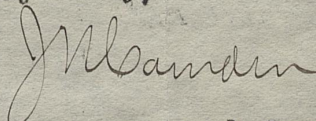

Democratic National Committeeman.

Copy

May 21, 1920.

Mr. J. C. Layne,
Ft. Thomas,
Ky.

My dear Mr. Layne:-

Your letter of May 20th, regarding arrangements for the trip of Mrs. Layne and your son to San Francisco, at hand.

It is our expectation to leave Chicago over the North Western Union Pacific at 7:10 P.M., Tuesday June 22nd, and go straight through.

There is quite a large party of us, including myself, and others, who are going to return by the picturesque Canadian Pacific, making brief stops at Portland, Tacoma, Seattle, Victoria, Vancouver, Lake Louise, Banff, Minneapolis, St. Paul, Chicago, and from there home.

Some of the party, including Mr. McCord, of Springfield, are arranging to return by Los Angeles and The Santa Fe Route, possibly stopping over at Grand Canyon, Kansas City, and St. Louis or Chicago, while Mr. and Mrs. Shields, of Taylorsville, and perhaps some others are going to return by also going down to Los Angeles and then by Salt Lake City and the "Rio Grande" to Denver, and then to Kansas City, St. Louis, or Chicago.

We would be very glad to have Mrs. Layne and your son in our party.

Very truly yours,

(s) P. H. Callahan.

Colorado Points

Colorado Points

LAW OFFICES
OF
J. A. SULLIVAN.
RICHMOND, KY.

May 31st, 1920.

Hon. Miss Laura Clay,
189 North Mill Str.,
Lexington, Ky.

My dear Miss Clay:-

I herewith transmit you a letter I have just received from Col. Callahan.

I would be glad for you to furnish me such information as you regard the most important facts relative to your father, Cassius Clay, and also such facts in your own life that you might care to have referred to in an article I might prepare. I really would rather for you to prepare both articles, and let me supervise them, if you have the time. I think this important.

I also hope you will send to me your photograph, so I can send it to Col. Callahan for the purpose mentioned.

Thanking you for an early answer with the above information, I am

Yours truly,

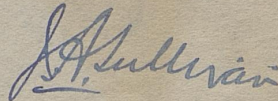

JAS/MBP.

189 N. Mill St., Lexington, Ky.

May 22nd, 1920.

Mr. C. H. Hagerty,

Louisville, Ky.

Dear Sir:-

Your letter of the 21st is at hand, regarding the Democratic National Convention route to San Francisco.

I expect to take the Northern Pacific Canadian route on return trip and possibly via Victoria and Vancouver.

The only side trip I now think I would like in California is to the Yosemite Valley. How had I better arrange that? Can it be taken as a side trip on the ticket by the northern route? or had it better be arranged as a separate trip before I start on the return trip?

Please find enclosed my check for \$17.01, in payment Pullman fares.

I have not yet decided whether to start from Louisville the night of the 21st of June; or to join the party in Chicago on the evening of the 22nd. I will let you know in due time to arrange for a lower berth, if I decide to make the trip on the night train.

Thanking you for the information given, I am

Very respectfully,

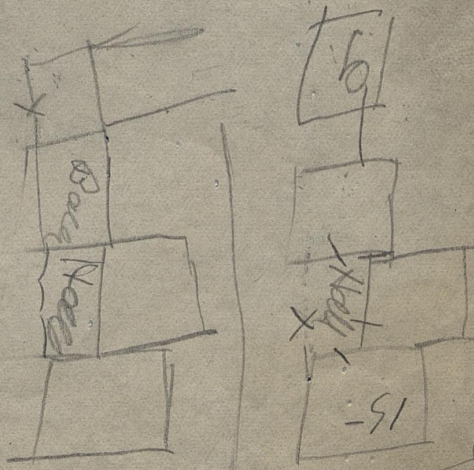

May 24, 1920

OVERLAND LIMITED PARTY

Leaving Chicago at 7:10 P. M., June 22nd
via Chicago North Western - Union Pacific
without change or stop to San Francisco
arriving at 5:30 P. M. Friday, June 25th.

Mr. Desha Breckinridge,
Lexington, Ky.

Mrs. Nora Layne,
Ft. Thomas, Ky.

Mr. John L. Dismukes,
Mayfield, Ky.

Judge J. F. Gordon,
Madisonville, Ky.

Mr. John H. Durham,
Franklin, Ky.

Mr. J. H. McChord,
Springfield, Ky.

Col. P. H. Callahan,
Louisville, Ky.

Mr. S. D. Rouse,
Covington, Ky.

Mr. W. H. Shanks,
Stanford, Ky.

Mr. R. B. Brown,
Warsaw, Ky.

Mrs. Cora Wilson Stewart,
Frankfort, Ky.

Miss Laura Clay,
Lexington, Ky.

Mr. Josh T. Griffith,
Owensboro, Ky.

Mr. W. J. Nesbitt,
Providence, Ky.

Mr. Thos. S. Rhea,
Russellville, Ky.

Mr. R. E. L. Simmerman,
Hartford, Ky.

Mr. Wallace Embry,
Louisville, Ky.

Dr. B. F. Shields,
Taylorsville, Ky.

Mr. A. W. Rhorer,
Middlesboro, Ky.

Mr. G. C. Wells,
Paintsville, Ky.

[May 24, 1920]

The following we have not heard from at all:-

C. W. Mathers,

Carlisle, Ky.

Stanley F. Reid,

Maysville, Ky.

Clarence Duncan,

Monticello, Ky.

R. L. Vincent,

Louisa, Ky.

S. R. GLENN
SECRETARY

CHAS. A. HARDIN
CHAIRMAN

MAJA EUDALEY
ASST. SECRETARY

Democratic State Central and Executive Committees

SEELBACH HOTEL

LOUISVILLE, KY.

May 24th, 1920.

WAYS AND MEANS COMMITTEE

CHARLES A. HARDIN, Chmn.,
Harrodsburg, Ky.

W. C. MONTGOMERY,
Elizabethtown, Ky.

E. M. GATLIFF,
Williamsburg, Ky.

W. N. HIND,
Covington, Ky.

THOMAS TURNER,
Cerulean Springs, Ky.

MARCH 18th CONFERENCE COMMITTEE

P. H. CALLAHAN, Chmn.,
Louisville, Ky.

CHARLES A. HARDIN,
Harrodsburg, Ky.

HARRY A. SOMMERS,
Elizabethtown, Ky.

C. S. NUNN,
Marion, Ky.

E. M. GATLIFF,
Williamsburg, Ky.

Kentucky Delegates,
"Prosperity" Convention,
San Francisco, Calif.

Inasmuch as you are a member of the Delegation, you will be interested in the enclosed data showing routes taken by different members on their way out to San Francisco.

There may still be some additions to the Overland Limited party, which also includes some other Kentuckians that are going along, as well as wives and members of the families of the Delegates.

This is merely sent you as a matter of information.

Yours very truly,

P. H. Callahan.

189 N. Mill St., Lexington, Ky.

May 24th, 1920.

Hon. J. N. Camden,

Versailles, Ky.

Dear Sir:-

In reply to your letter of May 21st I beg to say that it is my intention to go to the Democratic National Convention in San Francisco.

In regard to the R.R. route:- I have received letters from Col. P. H. Callahan, inviting me to join a party of the Ky. delegates who are to start from Louisville on the 21st of June, and from Chicago on the evening of the 22nd. I have accepted this invitation and have secured Pullman reservation for that route. Also, Col. Callahan has kindly undertaken to secure hotel accommodations for me with the Ky. delegation.

Thanking you for the information in your letter, I am

Very truly yours,

Office of

P.H.Callahan

Benedict Elder
J.A.Fregelein
T.J.Knight
W.B.Kuper
R.G.Wulf

Louisville

May 24th, 1920.

Miss Laura Clay,
Lexington,
Ky.

My dear Miss Clay:-

Owing to the various letters you have received, there may be some confusion relative to the arrangements for our trip to San Francisco and thought it best to write you fully and definitely.

You are scheduled to leave Chicago on the Overland Limited Tuesday June 22nd at 7:10 P.M., arriving in San Francisco Friday the 25th at 5:30 P.M., and to be located at the Wiltshire Hotel, where our reservations begin that day.

It was necessary to secure the sleeping-car accommodations some time ago, and they are in my name, and a berth is being held for you in accordance with your instructions until your Railroad ticket is purchased, and in this connection free transportation nor anything but first-class transportation is accepted on this particular train.

At the time you purchase your ticket it will be necessary to make up your mind regarding the return route and am enclosing you herewith copy of a letter written Mr. Layne which will give you some necessary information regarding the return route.

Owing to your location, it will be just as convenient for you to begin your trip in Louisville, therefore, a berth has also been reserved for you on a special-car to leave on the "Pennsylvania" at 10:30 P.M., Monday, June 21st.

If your prefer, you can handle the whole matter through my office by letting me know just how you wish to return and we will do the rest.

Very truly yours,

P.H. Callahan

189 N. Mill St., Lexington, Kentucky.

May 24th, 1920.

Mrs. George Bass,

Woodward Building, Washington, D.C.

Dear Mrs. Bass:-

Some days ago I received from Mrs. J.C. Cantrill a request to send to Democratic Headquarters a photograph of myself; and biographical data-" just as complete an account as possible". Accordingly, I am sending a sketch entirely too long, written in large part by my friend, Alice Stone Blackwell, in 1911, and brought up to date. You can use as much of it as you think proper.

I am also enclosing a photograph of myself.

Today I received a request from Headquarters for names of women to whom to send literature. It was a circular addressed to Katherine F. McCarthy, Lowell, Mass.; but I suppose a similar one was intended for me, and I shall give it my prompt attention. I have been helping to organize some clubs of Democratic women, and can probably help efficiently in this line.

Very truly yours,

189 N. Mill St., Lexington, Ky.

May 24th, 1920.

Hon. J. A. Sullivan,

Richmond, Kentucky.

Dear Sir:-

In accordance with your request in your letter of the 21st, I am enclosing to you a biographical sketch of myself, the larger part of which was written by a newspaper friend, Miss Blackwell. I know it is longer than you require, but I believe you are a better judge than I of and you can select parts from it, which is desired for Mr. Callahan's purposes. I hope you will think it suitable to include my States Rights attitude, as described in the last ten lines.

As to the sketch of my father:- I do not think it would be complete without a reference to his long self-sacrificing efforts for the freedom of the slaves. You might make reference to his service in the war with Mexico.

He was appointed minister to Russia for both terms of President Lincoln's administration. I believe my brother Brutus could give you all the points you might like to speak of better than I can.

I enclose the photograph you ask for.

Thanking you for your kindly interest in me as a Democratic delegate to the San Francisco Convention, and hoping that I may acquit myself to your satisfaction, I am

Very sincerely yours,

The State Journal

PUBLISHED BY

THE STATE JOURNAL COMPANY

INCORPORATED

GRAHAM VREELAND, PRESIDENT

J. L. NEWMAN, SECRETARY

MEMBER ASSOCIATED PRESS

THE STATE JOURNAL BUILDING
FRANKFORT, KENTUCKY

May 28, 1920

Miss Laura Clay,
Lexington, Kentucky.

My dear Miss Clay:

At the request of Mrs. R. C. Browner, President of the Franklin County Democratic Women's Club, I write to ascertain if you will address the Club at our first open meeting after your return from the National Democratic Convention. This meeting will be on July the tenth. An early response will be appreciated.

Very sincerely,

(Mrs. Arch) Atlanta H. Pool

189 N. Mill St., Lexington, Ky.

May 29th, 1920.

Mrs. Arch Pool,

Frankfort, Ky.

Dear Mrs. Pool,

I have just received your letter of the 28th, inviting me to address the Franklin County Democratic Women's Club of July 10th. It would give me pleasure to do so; but I am arranging to stay a few days in California after the national convention, and I am too doubtful about the exact date of my return to make an engagement so early as that.

If at some later date, to be fixed on my return, your Club should desire me to address it, I shall be very glad to do so.

Very sincerely yours,

CLASS OF SERVICE	SYMBOL
Telegram	
Day Letter	Blue
Night Message	Nite
Night Letter	N L

If none of these three symbols appears after the check (number of words) this is a telegram. Otherwise its character is indicated by the symbol appearing after the check.

WESTERN UNION TELEGRAM



I. COMB CARLTON, PRESIDENT

GEORGE W. E. ATKINS, FIRST VICE-PRESIDENT

CLASS OF SERVICE	SYMBOL
Telegram	
Day Letter	Blue
Night Message	Nite
Night Letter	N L

If none of these three symbols appears after the check (number of words) this is a telegram. Otherwise its character is indicated by the symbol appearing after the check.

RECEIVED AT 265CAU 46 BLUE

VALLEJO CALIF MAY 29 1920 150PM

MISS LAURA CLAY

Duncan

CARE MRS SAMUEL BENNETT 437 WEST SECOND ST LEX KY

ABSOLUTELY IMPOSSIBLE OBTAIN HOTEL ACCOMMODATIONS FOR DEMOCRATIC CONVENTION SAN FRANCISCO UNLESS BONAFIDE DELEGATE KENTUCKY DELEGATES RESERVATIONS MADE THROUGH J M CAMDEN VERSAILLES COMMUNICATE IMMEDIATELY WITH HIM I HAVE PERSONAL FRIENDS IN HOTEL BUSINESS THEY ARE UNABLE TO GIVE ROOMS AT ANY PRICE KENTUCKY DELEGATES ASSIGNED HOTEL WILTSHIRE

A W ASHBROOK

44 3PM

861

Transmitted by

Delivered to

Time

to No

3220
Miss L.C.
25 6.07