

Setcher Circuit Court.
H.C. Boatwright -
vs.
L. & E. Railway Co.

Blond Boatwright

(About 6 or 800 ft
from P.R. to Point of
Damage.)

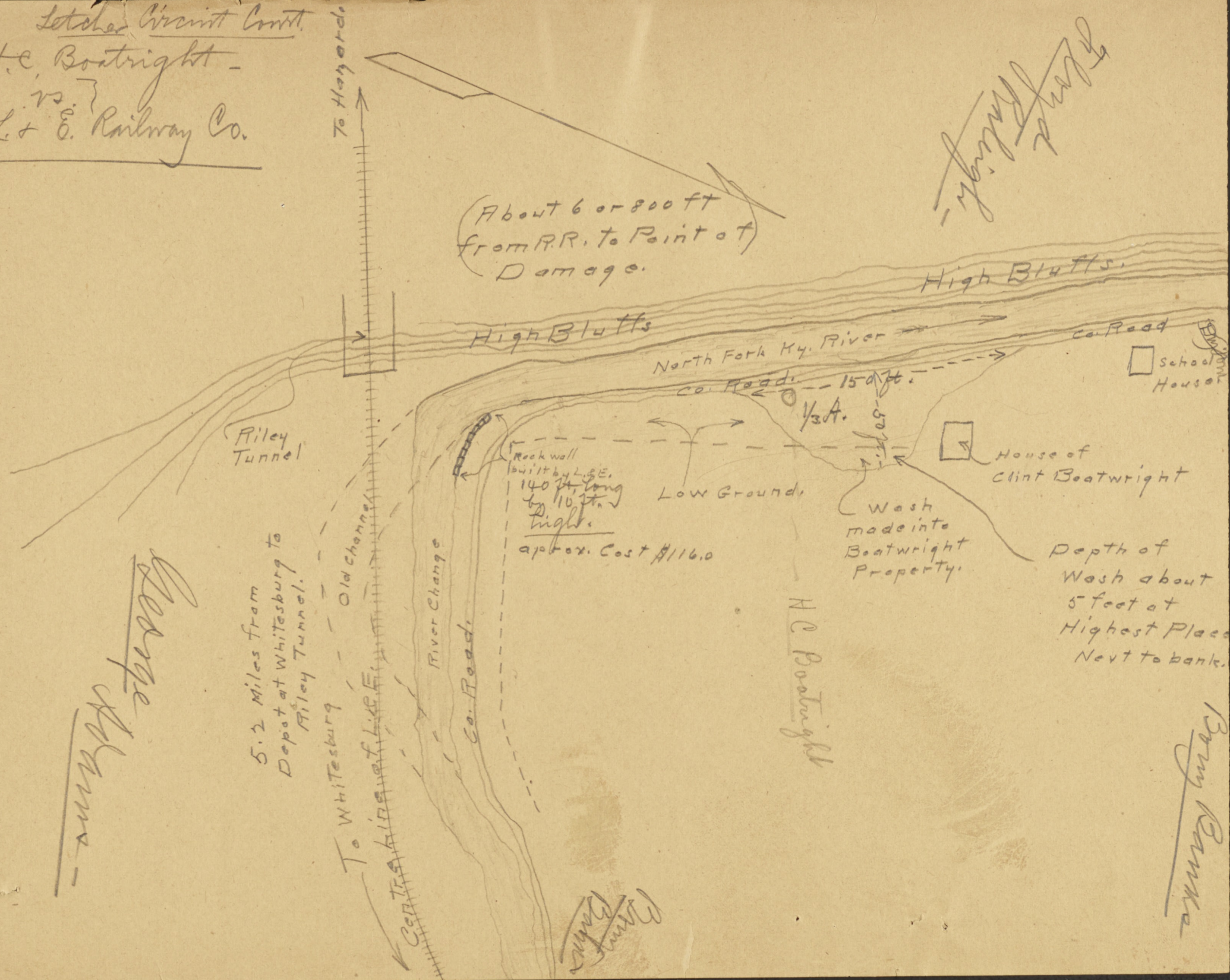

George Schuman

5.2 Miles from
Depot at Whitesburg to
Riley Tunnel.

To Whitesburg

To Whitesburg

River Change

Co. Road

Rock wall
built by L. & E.
140 ft. long
by 10 ft.
high.
approx. Cost \$116.0

Low Ground

H.C. Boatwright

House of
Clint Boatwright

Depth of
Wash about
5 feet at
Highest Place
Next to bank.

Berry Banks

Berry Banks