

DAVID T. BEALS, President.
F. P. NEAL, Vice-President.

GEO. D. FORD, 2d Vice-President.

CHAS. H. V. LEWIS, Cashier.
H. J. ROSENCRANS, Ass't Cashier.

NO. 3637.

UNION NATIONAL BANK.

CAPITAL, \$600,000.

KANSAS CITY, Mo., October 1st, 1889.

Jas N Patterson Esq
Lexington Ky

DEAR SIR:

ENCLOSED WE BEG TO HAND YOU OUR DRAFT
NO. 40389, ON THE NATIONAL BANK OF COMMERCE
NEW YORK CITY, FOR \$ 98.=-, IN PAYMENT OF
SEMI-ANNUAL DIVIDEND NO. 5, OF FOUR PER CENT (4 %) ON
7 SHARES OF THE CAPITAL STOCK
OF THIS BANK NOW STANDING IN YOUR NAME.

WE ALSO ENCLOSE DIVIDEND STATEMENT NO. 5, SHOWING
THE CONDITION OF THE BANK AT THE CLOSE OF BUSINESS,
SEPTEMBER 30, 1889.

VERY RESPECTFULLY YOURS,

CHAS. H. V. LEWIS,
CASHIER.

THE EGAN COMPANY,

— MANUFACTURERS OF —

Patent Wood Working Machinery,

Nos. 232, 234, 236, 238, 240, 242, 244, 246, 248 and 250 WEST FRONT ST.

Perlin's Celebrated Band Saw Blades,
 Scroll Saw Webs,
 Genuine Babbitt Metal,
 Round Corner Files,
 Rolled Silver Solder,
 Friezing and Molding Bits, &c., &c.

Cincinnati, Oct 1 - 1889.

Order No. P 3040 Sold to State College of Kentucky,
3065 Cincinnati, R.R. Lexington, Ky.
 Shipped via Cinti' Lon. R.R.

1	Pulley 18 X 8 1/2 for Emery Grinder	6 60	
1	" 34 X 6 1/2 " Scroll Saw	12 90	
1	" 34 X 10 1/2 " Universal "	19 10	
	Less 45% Disc.	3 860	
		17 37	
3	Slip Collars 1 5/16" with Set Screws per ea.	2 25	
1	pr Straight Bits 5" long	1 25	
6	Cylinder Collars with nuts & washers ea.	2 10	
			26 83

MONTHLY STATEMENT.

Folio *221*

Cincinnati, 10/1

1889.

On State College of Kentucky,

Lexington, Ky.

To THE EGAN COMPANY, Dr.

BUILDERS OF

Patent Wood-Working Machinery

232, 234, 236, 238, 240, 242, 244, 246, 248 and 250 W. Front St.

PERIN'S
Celebrated Band Saws
SCROLL SAW WEBS, &C.
Band Saw Files.
Rolled Silver Solder.
Molding & Friezer Bits.

Sept 9

To Mdse.

1002

Please remit at maturity, or otherwise we will make Sight Draft on
for Please protect same on presentation.

Lexington, Ky.,

Oct 1 1889

M

State College

To JAS. M. BYRNES, Jr

BOOK AND JOB PRINTER, BOOK BINDER, STATIONER.

No. 11 North Mill Street.

Sept 4	To 500 Circulars	225	
6	5 Records	25	
17	500 Reports	407	
28	1000 Blanks @ 4.75	500	1475

Lexington, Ky.,

Oct 1 1889

M

Prof. Jas R Pattison

To **JAS. M. BYRNES, Jr**

BOOK AND JOB PRINTER, BOOK BINDER, STATIONER.

No. 11 North Mill Street.

Aug 13	To Make so far bill paid	19 15						
Sept 25	& Shubs Blistering paper	25	1940					

W. Plunkett, Sole Proprietor.

C. C. Pearson, Stationery Dep't.

D. N. Zimmerman, Printing Dep't.

Lexington, Ky., Oct 1st 1889.

M State Wrd M College

To W. Plunkett & Co., Dr.

Fine Job Printers, Wholesale and Retail Society Stationers,

No. 48 East Main Street.

1889.

Left r6 To 1 Desk Pad

\$ 1 13

1889.	Nov.	College in account with Jas R Patterson	Dr,
Sept.	23	To Amount brought forward	\$ 104.53
"	"	To Cash, Cont'd, Oliver's order	13.00
"	24	" " Larue Herald, advertising	3.00
"	27	" " Freight, foot hammer	2.61
"	28	" " Dolan, Kaske's order	2.30
"	29	" " Cleaning Cistern	5.00
Oct.	1	" " Expressage	1.83-
"	"	" " Cont'd, Oliver's order	4.00
"	2	" " Postage	1.00
"	"	" " Stamping Keys	25-
"	"	" " Expressage	35-
Total			\$ 204.93
Credit by warrants Aug 1 1889, \$2.00			
Balance due Oct 4 1889			\$ 4.93

W^m College
Lynchburg Va
Ch^d 1889

Pres J. K. Patterson.
To R. L. Cowherd.

" Work done in shop
and boiler house
Number of hours 32 @
12½ per hour

\$ 4.00
\$ 4.00

R. L. Cowherd.

Perlin's Celebrated Band Saw Blades,
 Scroll Saw Webs,
 Genuine Babbitt Metal,
 Round Corner Files,
 Rolled Silver Solder,
 Friezing and Molding Bits, &c., &c.

THE EGAN COMPANY,

— MANUFACTURERS OF —

Patent Wood Working Machinery,

Nos. 232, 234, 236, 238, 240, 242, 244, 246, 248 and 250 WEST FRONT ST.

Cincinnati, Oct 4 1889.

Order No. 3045 Sold to State College of Kentucky,
 Shipped via Adams Exp Lexington, Ky.

1	Auger Bit, 1/2" shank ea. 1/4 5/16 3/8	51 gr @ 25¢	12 75	
	7/16 1/2 9/16 5/8 11/16 3/4 13/16 7/8 15/16 1 1 1/16 1 1/8 1 3/16 1 1/4	trimming 1/4 shank @ 15¢	2 55	
1	Twist Drill ea. 7/8 3/16 1/4 5/16 3/8 7/16 1/2	16.00		
	9/16 5/8 11/16 3/4 3" long 1/2" dia. st. shank	2 @ 40¢ = 8.00	8 00	
18	Set Screws 2 1/2 x 3/8 sq. head.	@ 15¢ ea	2 70	
18	" " 3 x 7/16 " "	@ 15¢ "	2 70	
				28 70

C. C. CALHOUN, Principal.

OFFICE OF THE

COMMERCIAL, SHORT-HAND & TELEGRAPH DEPARTMENTS,
STATE A. & M. COLLEGE.

No. 50 North Broadway.

Post Office Lock Box 97.



A LIFE SCHOLARSHIP

IN BOOK-KEEPING,
EMBRACING

Merchants,
Co-Partnership,
Compound Company,
Commission,
Joint Stock,
Mining, Cotton,
Farming,
Lumber, Banking

AND ALL CONCURRENT BRANCHES,
\$25.00.

MERCHANTS BOOK-KEEPING ALONE
\$15.00.

Our Merchant Course is more
complete than the full course
in most colleges.

THE ONLY PURELY
SHORT-HAND SCHOOL

IN THE SOUTH,
In charge of Practical Teach-
ers, Verbatim Reporting
is the Standard.

COMPLETE SCHOLARSHIP
—IN—

Short-Hand,
Type-Writing, &c.,
\$25.00.

TYPE-WRITING ONLY,
\$10.00.

Business Men furnished com-
petent Phonographers
without charge.

OUR

TELEGRAPH DEPARTMENT

Offers especial advantage
to those wishing
a practical and thorough
knowledge of this busi-
ness. The Prof. in
charge is man of

SEVEN YEARS

Experience and is assisted by
by a competent lady
teacher.

FULL COURSE 35 DOLLARS,

Tuition and Practice

—BY THE MONTH—

EIGHT DOLLARS.

All of our graduated students
have positions.

Lexington, Ky., Oct. 1, 1889

J.K.Patterson P.Hd.

President State A. & M.College Lexington Ky.

Dear Sir:-

The following is a list of the furniture and supplies ,
with tabulated statement of same, which were necessary to furnish
the rooms,at the State College,for this Department.

One ash table, for teachers desk.-----	\$8.00
Two dozen chairs, for Bok-keeping room.-----	\$11.00
Four ash Tables, at \$ 2.50 apiece.-----	\$10.00
ONE half dozen Ink Stands. -----	.70
One Bottle Ink. -----	.33
Total. -----	\$ 30 .03,

Due fifteen [15.00] dollars, as one half on the above.

Please submit this to the Executive Committee at your earliest
convenience, and greatly oblige,

Your obedient servant,

C.C.Calhoun.

1889	July 16	College in account with Jas K Patterson	Dr,	
	July 30	To cash, Hardin, Murray's order		\$1.10
	"	" " " " Alley, Kasler's "		1.00
	Aug 2	" " " " Houshee Sundries		2.10
	"	" " " " Dr Long, oil		.40
	"	" " " " Hodges Advertising		15.00
	"	" " " " Martin & Co, Emery		.15
	" 3	" " " " Cowherd, Murray's order		3.50
	"	" " " " Dolan, Kasler's "		4.50
	" 10	" " " " " " "		5.00
	"	" " " " Wood, Sundries		4.45
	"	" " " " Stevens Cracking rock		4.00
	"	" " " " Wood, Asphalt,		3.00
	"	" " " " Houshee, Turpentine		.60
	"	" " " " Sollee, Coal oil		.15
	" 14	" " " " Page, Kasler's order		2.20
	"	" " " " Stationery,		.50
	"	" " " " Whetstone		.25
	"	" " " " Brooms		833
	"	" " " " Stevens Cracking rock		3.50

61.90

1889. A. & M. College in account with Jas R Patterson 52,

Aug 16	To	Amount brought forward	\$ 61.90
"	"	" " " " " " " " " " " "	.10
"	17	" Cash, Dolan, Kastler's order	6.00
"	"	" " " " " " " " " " " "	4.50
"	19-28	" " " " " " " " " " " "	2.93
"	23	" " " " " " " " " " " "	2.91-
"	24	" " " " " " " " " " " "	6.00
"	"	" " " " " " " " " " " "	2.50
"	"	" " " " " " " " " " " "	2.50
"	"	" " " " " " " " " " " "	2.00
"	"	" " " " " " " " " " " "	2.00
"	"	" " " " " " " " " " " "	3.30
"	"	" " " " " " " " " " " "	1.10
"	"	" " " " " " " " " " " "	6.10
"	"	" " " " " " " " " " " "	1.00
"	"	" " " " " " " " " " " "	.25-
Sept. 4	"	" " " " " " " " " " " "	7.95-
"	5-	" " " " " " " " " " " "	.75-
"	"	" " " " " " " " " " " "	.35-
			\$ 117.18

1889	Nov. 11.	College in account with Jas. R. Patterson	Dr
	Sept. 5.	To amount brought forward	\$ 117.18
"	"	To Cash, Section,	1.20
"	7	" " Foster Orris, order	5.50
"	"	" " Dolan Rastler "	5.80
"	"	" " Smith Murray's "	4.00
"	10	" " Freight	.50
"	17	" " Stationery	2.10
"	14	" " Smith Murray's order	2.00
"	"	" " Hawkins " "	1.00
"	"	" " Dolan Rastler "	3.40
"	"	" " Garrod Ambrose's "	1.30
"	17	" " Postage stamps	7.00
"	21	" " Pencil Dusts.	.38
"	"	" " Worthwell, Murray's order	.70
"	"	" " Dolan Rastler order	2.00
"	"	" " Robbins, Brite work	5.50
"	"	" " White washing	5.80
"	"	" " Coal oil	.50
"	23	" " Cowhnd Oliver's order	4.00
			\$ 169.54

Miss M. E. Donovan's
Teachers' Bureau and Musical Agency,

30 & 32 East 14th St., bet. 5th Ave. & University Place,

ROOMS 4 AND 5. TAKE ELEVATOR AT No. 30 EAST 14TH STREET.

New York, O. N. G. 1887

Mr. Lewis H. H. H. H.

236. Greene Ave

Brooklyn, N. Y.

has applied to me for a position as
Teacher

giving your name as reference. Will

you kindly inform me as to your knowledge
of his character and ability, and

oblige

Yours, respectfully,

M. E. DONOVAN.

All communications confidential.

KENTUCKY AGRICULTURAL
EXPERIMENT STATION,
-AT-
State College of Kentucky.
A. SCOVELL, Director.

Lexington, Ky., Oct. 16 1888
to Jay 2 89

Dear J. K. Patterson

please pay to J. W. Harden	4.35-
J. W. Harden 32 1/2 hours	3.25-
J. H. Beard 5 1/2 "	56-
J. C. Brenblinger 1/2 "	46-
L. S. Barber 1 "	10

J. Murray

~~4.35-~~

47-M-64

KENTUCKY AGRICULTURAL
EXPERIMENT STATION
1881
S. S. SOVELL, Dir.

J. N. Hardin

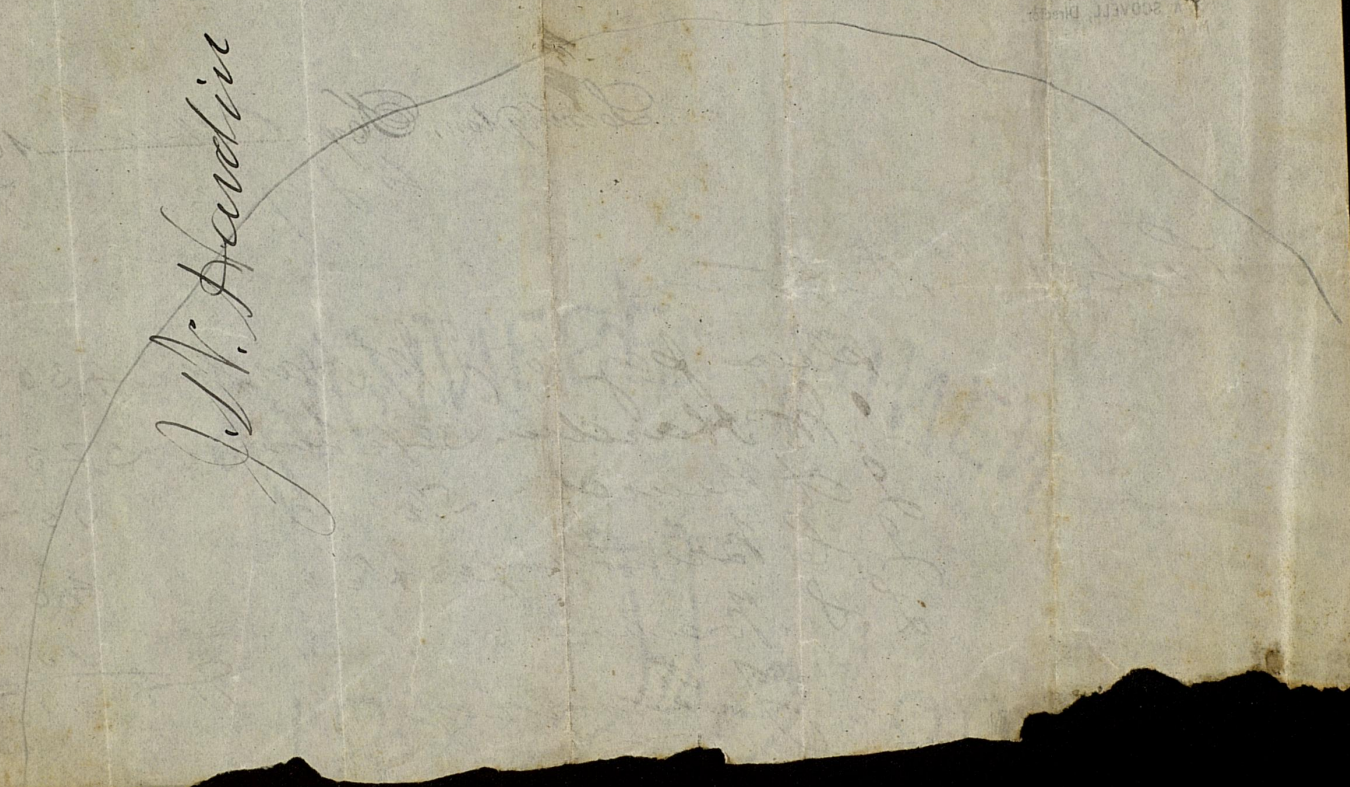

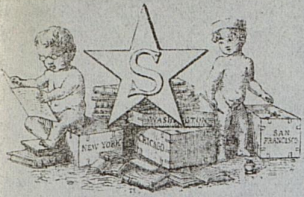

PROF. J. K. PATTERSON,
STATE COLLEGE OF KENTUCKY,
LEXINGTON. KY:

B. F. Stevens.
4. Trafalgar Square.
London, W.C. 1887

Abbreviated Address for Telegrams & Mails London.
19 OCTOBER 1887

DEAR SIR,

I HAVE THE PLEASURE TO ENCLOSE HEREWITH A STATEMENT OF
YOUR ACCOUNT TO THE 30TH SEPTEMBER LAST, SHOWING A BALANCE OF
£0.16.6 TO YOUR DEBIT, WHICH I TRUST WILL BE FOUND CORRECT.

RESPECTFULLY REQUESTING THE FAVOUR OF A REMITTANCE,
AND ALWAYS AT YOUR SERVICE,

I AM, DEAR SIR,

YOURS FAITHFULLY,

B. F. Stevens
[Signature]

OFFICE OF

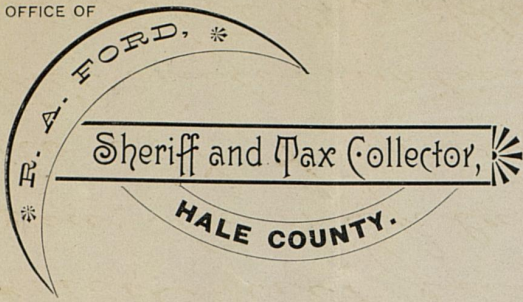

[with letter of Oct 27, 1889]

COUNTIES ATTACHED:
 SWISHER, BAILEY,
 LAMB, HOCKLEY,
 COCHRAN.



Plainview, Texas, Oct 22nd 1889

Eubank & Eubank

El Paso Texas

Gentleman

I have your letter of the 15th inst before me, inclosing New York exchange for \$1824 which is just enough to pay the tax on two sections. I will say that you will have to send 50.00^{cts} to pay exchange as I cant get drafts cashed here without paying exchange. also you must give Abat. No. Cert. No. & Sur. No. of each section. before I can issue receipt. I paid \$100 to a land agent last year to find out your Abat Nos. & asked you to replace it & you did not do it & now I want you to give me this information & exchange & I will give receipts promptly yours Truly R. A. Ford Sheriff & Tax Collector Hale Co

Lexington, Ky.,

Nov. 1 1889

M. Prof. Jas. R. Patterson

To James M. Byrnes, Dr.

Removed to 53 EAST SHORT ST.
Nearly Opp. Engine House.

Stationer, Job Printer, Publisher and Binder,

No. 11 North Mill Street.

July 8	To Bnd. 6 Vols Rome @ 145	870	870
"	" " 1 " Montague	145	85-
"	" " 2 Dictionaries	290	290
Aug. 13	" " 2 Vols. Em. 1/2 Morocco 125	250	200
"	" " 3 " Latin History @ 120	360	253-
Sept 25	" 13 Sheets Blotter	23	1910
			25-
			<hr/> 1725-

Paid Jas M Byrnes

The foregoing bill is subject to the conditions noted
If this be satisfactory you can collect the enclosed
check. If not return and I will explain in
person as I did before.

Yours truly

Jas R. Patterson

As I do not now remember the quotations given you
I suppose you are right. Some of the work we had to review
Respectfully
James M. Byrnes



C. L. CARTER,
Attorney at Law.

J. M. CARTER,
Abstractor of Titles and Notary Public.

Hale County Land and Judicial District is composed of Swisher, Hockley, Bailey, Lamb and Cochran counties.

Correspondents will please give county, abstract, survey, certificate and Block number.

Carter Bros.,

REAL ESTATE AGENTS.

Will examine and Perfect Titles to Lands, pay Taxes on lands in any part of Texas; will furnish abstract of titles, buy, sell and lease lands. Special attention given to Panhandle Lands.

Plainview, Texas, *11/5* 18 *89*

*Mr James L Patterson
Sixington Ky*

Dear Sir

Please find below statement of tax for 1889

<i>Acres</i>	<i>Cent</i>	<i>Sur</i>	<i>Orig</i>	<i>Grantor</i>	<i>Patented</i>	<i>acres</i>	<i>county</i>	<i>Tax</i>
<i>119.</i>	<i>149</i>	<i>27.</i>	<i>C & M Ry Co.</i>	<i>Margaret A. Stone</i>	<i>640.</i>	<i>Hale.</i>		<i>\$912</i>
								<i>\$100</i>
								<i>\$1012</i>

Our fee

*If you wish us to pay your tax remit
by money order on Plainview or by Bank draft.*

Yours Truly

Carter Bros

per C. L. C.

518892

Number of hours in the shop since
Nov 13th to Jan. 11, 87 1/2 - \$8.75 -

Demure screws & nuts

.20

9.45 -

Hardin

TAX OF 1889.

No. 126

County Treasurer's Office.

Burlington, Coffey County, Kansas,

Nov 18 18 89

RECEIVED OF

James K Patterson

November 27/1889

100 DOLLARS,

in full for

whole

Tax of the year 1889 on the following described property:

DESCRIPTION	Sec.	Twp.	Rng.	Valuation	School Dist.	Township	Part Paid	TOTAL TAX	Sold for Tax in	No. of Sale	Amount Sale
Personal Property, 1/2 NE & E 2 NW 4	18	23	16	510	4	Neo	all	19 76 49 19.27			

A. B. Cherry

County Clerk.

T. G. Ballinger

Treasurer.

Examine your Receipt at Once—Bring it with you next time you pay.

By

Deputy.

Tax Levy for 1889, Coffey County, Kansas.

FUND.	Rate per \$100
State	\$.40
Delinquent State.....	.05
County.....	.70
County Bond.....	.30
Sinking Fund for Bridge Bonds.....	.06 ¹ / ₄
Sinking Fund for Railroad Bonds.....	.13 ³ / ₄
Road.....	.30

MUNICIPAL FUNDS.

TOWNSHIP	Twp. Tax	Twp. Bond	TOWNSHIP	Twp. Tax	Twp. Bond
Avon	\$0.15	\$0.12	Pottawatomie.....	\$0.20
Burlington.....	.10	.25	Rock Creek25	\$0.60
California.....	.17	Spring Creek.....	.10	1.18
Hampden.....	.25	Star15
Key West.....	.25	.27	CITY	Library	Street
LeRoy.....	.20	1.61	Burlington.....	\$0.10	\$0.30
Liberty.....	.20	.36	LeRoy.....	City
Lincoln.....	.13	.02	Lebo.....	City Bond
Neosho.....	.15	.23	Waverly.....
Ottumwa.....	.15	.07			
Pleasant.....	.10			

SCHOOL DISTRICTS.

No. of District	Dist. Tax	Dist. Bond	No. of District	Dist. Tax	Dist. Bond	No. of District	Dist. Tax	Dist. Bond
1.....	\$1.00	\$0.25	35	\$1.20	69.....	\$0.50
2.....	1.00	.71	3660	70.....	1.25	\$0.31
3.....	1.10	37.....	1.10	71.....	1.00
4.....	.90	38.....	1.00	72.....	1.30	.06
5.....	1.00	39.....	1.00	73.....	.70
6.....	1.00	40.....	2.00	.37	74.....	1.50
7.....	.80	41.....	.90	75.....	.80
8.....	1.00	42.....	.80	76.....	1.00	.43
9.....	.50	43.....	1.15	77.....	.50
10.....	.70	44.....	1.10	78.....	1.25	.52
11.....	1.20	45.....	1.50	.65	79.....	.70	.45
12.....	.50	.33	46.....	1.00	.47	80.....	1.00	.50
13.....	1.70	47.....	1.10	.45	81.....	1.50	.60
14.....	1.10	48.....	.50	82.....	1.00	.30
15.....	.95	49.....	1.75	83.....	.70	.40
16.....	1.30	50.....	1.60	84.....	.50	.78
17.....	.80	51.....	1.50	85.....	1.10	.80
18.....	.90	52.....	.75	86.....	1.10	1.25
19.....	.40	53.....	.60	.24	87.....	1.00	.73
20.....	1.00	54.....	1.50	1.25	88.....	1.00	.45
21.....	2.50	55.....	1.00	89.....	1.50	1.10
22.....	.70	56.....	1.25	Joint 1.....	.40
23.....	.70	57.....	1.40	1.21	“ 2.....	1.25
24.....	.15	58.....	1.25	.50	“ 3.....	1.10
25.....	1.00	59.....	1.30	“ 4.....	1.20
26.....	.50	60.....	1.00	“ 16.....	.80
27.....	1.30	61.....	.90	“ 25.....	.90	.10
28.....	1.25	62.....	“ 29.....	.60
29.....	.50	63.....	1.00	“ 38.....	1.20	.50
30.....	.30	64.....	.40	“ 59.....	1.00	.25
31.....	1.00	65.....	.90	“ 69.....	1.50	.40
32.....	.60	66.....	.60	“ 90.....	1.70	.70
33.....	.50	67.....	1.30			
34.....	.70	68.....	1.50	.24			

STATE OF KANSAS, COUNTY OF COFFEY, SS.

I, H. B. Cheney, County Clerk, in and for said County, in said State, do hereby certify the foregoing to be a true and correct statement of all Levies for Taxes for the year A. D. 1889, duly made in accordance with the laws of the State of Kansas, on each One Hundred Dollars (\$100.00) assessed valuation of all taxable property in said County, in the amounts and for the purposes as above specified.

Witness my hand, and seal of said County, this 28th day of August, A. D. 1889.

H. B. CHENEY, County Clerk.

47-M-64

47-M-67

But in the mean time,
will do better for you if
I can

I have been figuring with
some other parties in regard
to a time lease but I presume
they would want a house
built expect to hear from
them soon

Yours very truly
C. C. Aiken

Richmond Kans 11/18/89

Mr J. K. Patterson
Dear Sir

Your favor received and
contents noted, Have made
no definite arrangements
yet with any one about
your land. It is a little
early yet I think to close
a bargain unless you
knew you had a good
thing. Young Logan
has been in this evening
and informs me that
you had written them
accepting their proposition
and instructed me to make
out the papers. But I do not

so understand your letter
I have questioned them as
to their proposition and
it is as follows viz
They will fence off 100 acres
to itself and break it out
for a 3 years lease of the
whole, and in case of sale
at the end of 1st year they
would ^{want} \$250 and sale at
end of 2^d year they would
want \$125.

Since you were here I
have thought I might
give you a racket on it
myself if you should
think best not to break
out any of it, and I think
this would be the least
trouble to you.

Where the grass is well
eaten out clover and blue

grass could be sown in the
spring and harrowed in
and if it was a favorable
spring you might get a
good set.

I can see Mr Smiley
and find out what
he would give for the
pasture.

I might tell you what I
thought I could do,
I will give you \$125
cash. (would prefer a little
time to make it out of
the pasture.) and will
sow what grass seed
you might want sown.
Now I don't care but I
think I could get some
cattle and make a little
something looking after it

Kentucky Military Institute,

NEAR
FRANKFORT, KENTUCKY.

THIS old and widely known Institution opened its 43d session September 10th, last, and will close June 19th, 1889.

The course of study embraces a wide field of literary and scientific training, with special departments of Civil Engineering and Analytical Chemistry. There is also a Commercial Course for those whose taste or time will not admit of a regular collegiate course.

The degrees of BACHELOR OF ARTS, BACHELOR OF SCIENCE and CIVIL ENGINEER will be given; also a certificate of proficiency in the Commercial Course.

An able Faculty gives instruction in the several branches of study.

The cadets board and lodge in the barracks of the Institute; and the utmost personal attention is paid to the studies, conduct, health, and general welfare of the cadet. This close supervision over the individual cadet—to make him a man and a gentleman, as well as a scholar, is the characteristic feature of the school. No institution in this country gives the cadet the same personal, FRIENDLY care.

The Superintendent, Professors and Cadets constitute a military corps. The discipline is firm, but kind; and the military drill is thorough and exact.

The location has long been noted for its healthfulness, beauty of scenery, and general desirability; and the buildings and grounds are admirably adapted to their purpose. The property was formerly a health resort, known as Franklin Springs.

The Tuition Fee is \$50.00, payable in advance; and the charge for Board, Lodging, Fuel, Lights, Washing and Medical Attendance, for the session, is \$200.00, payable half in advance, balance January 1st. Cadets entering after the opening of the session will be charged pro rata, for tuition, board, etc., only from the time of entrance.

The Uniform, consisting of Dress and Fatigue Suits, and Text-Books and Stationery, are estimated to cost about \$50.00, and must be paid for in advance.

The cadet must come well supplied with underclothing and an overcoat, and with the usual toilet articles. He must also bring with him, from his home, his own napkins and bed-linen, and a pair of blankets.

 Parents can spend the vacation here with their sons. They will find it a pleasant and healthful summer resort. It can be reached from Frankfort, on the Louisville and Nashville Railroad, or from Lawrenceburg, on the Louisville Southern Railroad, on a good McAdamized road—being about six miles distant from each point.

The Institute has Telephone and Telegraph communication with all parts of the country.

For further information, address

NOVEMBER 22D, 1888.

POST-OFFICE—FARMDALE, KY.

D. F. BOYD,

Superintendent.

No. 195

OFFICE OF THE TREASURER OF FRANKLIN COUNTY, KANSAS,

EXAMINE THIS RECEIPT CAREFULLY,
TO SEE THAT ALL YOUR PROPERTY IS ON IT CORRECTLY.

OTTAWA, KAS., Nov. 25, 1889.

Received of *J. A. Patterson* the sum of *thirty four* Dollars
in full ^{*due*} semi-annual payment of Taxes for the year 1889, on the following described Property, situated in Franklin County, Kansas, viz :

DESCRIPTION.	Sec.	Twp.	Range	Acres	Valuation	REBATE.	PENALTY.	TOTAL TAX.	SOLD FOR TAXES.
<i>Wfr 2</i>	<i>7</i>	<i>19</i>	<i>20</i>	<i>271</i>	<i>1280</i>	<i>89</i>		<i>35 84</i>	
PERSONAL PROPERTY.									
TOTALS.								<i>35 84</i>	
Penalty to be Added, or Rebate Deducted.								<i>89</i>	
								<i>34 95</i>	

J. A. Harrison, Treasurer. Amount Paid. *34 95*
Countersigned, *G. F. Auking*, County Clerk.

47-M-107

RATE OF TAX

ON EACH \$100 VALUATION,

—1889.—

State Tax.....	\$.41
County Tax.....	.78
Railroad Interest Tax.....	.36

\$1 55

Township Taxes.

Appanoose.....	20	Lincoln.....	30
Centropolis.....	35	Ottawa.....	20
Cutler.....	40	Ohio.....	20
Franklin.....	30	Peoria.....	25
Greenwood.....	40	Potawatomie.....	20
Harrison.....	20	Richmond.....	40
Hayes.....	30	Williamsburg.....	40
City of Wellsville.....	10	Pomona Township.....	15
City of Pomona.....	30	Homewood Twp.....	35

School Bond Taxes.

No. 1.....	20	No. 42.....	40	No. 76.....	40
2.....	30	43.....	1 00	77.....	30
9.....	70	51.....	40	78.....	30
14.....	50	53.....	40	81.....	50
19.....	1 00	57.....	60	82.....	60
20.....	10	60.....	50	86.....	1 50
35.....	60	64.....	40	87.....	10
38.....	50	69.....	90	91.....	30
39.....	70	73.....	70	94.....	30
49.....	30				

Road Tax on all property except the City of Ottawa, valuation of 1888, 25 cents.

School District Taxes.

No. 1.....	1 10	No. 48.....	1 25
2.....	80	49.....	40
3.....	80	50.....	80
4.....	60	51.....	1 25
5.....	1 20	52.....	1 00
6.....	1 00	53.....	1 25
7.....	1 20	54.....	80
8.....	85	55.....	75
9.....	90	56.....	60
10.....	75	57.....	1 50
11.....	50	58.....	40
12.....	1 25	59.....	1 25
13.....	1 25	60.....	80
14.....	1 50	61.....	50
15.....	1 00	62.....	75
16.....	70	63.....	1 10
17.....	80	64.....	70
18.....	1 25	65.....	75
19.....	1 00	66.....	1 00
20.....	1 20	67.....	1 00
21.....	50	68.....	1 00
22.....	1 20	69.....	1 00
23.....	60	70.....	50
24.....	30	71.....	1 50
25.....	40	72.....	80
26.....	80	73.....	1 70
27.....	1 00	74.....	1 00
28.....	1 20	75.....	1 50
29.....	60	76.....	50
30.....	1 37½	77.....	1 30
31.....	1 00	78.....	1 50
32.....	1 00	79.....	80
33.....	70	80.....	80
34.....	80	81.....	1 00
35.....	80	82.....	1 50
36.....	1 00	83.....	1 25
37.....	80	84.....	1 45
38.....	90	85.....	1 20
39.....	1 40	86.....	1 50
40.....	1 00	87.....	1 20
41.....	90	88.....	45
42.....	40	89.....	1 50
43.....	1 00	90.....	1 25
44.....	1 40	91.....	60
45.....	1 00	92.....	2 00
46.....	40	93.....	1 25
47.....	50	94.....	1 50

Joint School District Taxes.

48.....	1 00	58.....	70
85.....	1 40	88.....	70

On Receipts for One-half Tax One-half Valuation is Given.

with letter Nov. 28, 1889
 Treasurer's Office, Linn Co., Kas., Nov 26 1889

PAID OF *Joseph K. Patterson* by *E. D. Stambaugh* *President* 57 Dollars,
Full 100
 of all tax for the year 1889, on the following
 property, to-wit:

DESCRIPTIONS.	Sec.	Town.	Range.	Valuation.	TAX.
<i>2 E 1/4 Ex 138⁹/₁₀₀ RR</i>	<i>2</i>	<i>23</i>	<i>22</i>	<i>665</i>	<i>17 95</i>

Personal Property,			
TOTAL			<i>17 95</i>
Redeemed Taxes, \$			
Redeemed Sale	18		Rebate <i>44</i>
Redeemed Sale	18		Penalty
<i>J. A. Madden</i> Treasurer.			Advertising
<i>D. R. Lamorsan</i> Deputy.			Amount Paid <i>17 51</i>

Rate of tax on other side. Examine your Receipt and see that you pay on the right description and personal property.

Rate of Tax Levied on each \$100 Valuation of Taxable Property in Linn County, Kansas, for the year 1889.

State Tax.....	\$0 40
County Tax.....	45
Bridge Tax.....	15
LaCygne City Tax.....	1 00
Pleasanton City Tax.....	1 00
Pleasanton City Bond Tax.....	1 00
Mound City City Tax.....	1 00
Mound City Bond Tax.....	90
Blue Mound City Tax.....	90
Blue Mound Bond Tax.....	50
Prescott City.....	50

Lincoln Twp. Tax.....	\$0 30
Scott Twp. Tax.....	25
Liberty Bond, 55, Twp. 25.....	80
Centerville Bond, 45, Twp. 15.....	60
Paris.....	none
Valley Twp.....	10
Potosi Bond, 40, Twp. 20.....	60
Mound City Bond, 50, Twp. 05.....	55
Blue Mound Bond, 70, Twp. 10.....	80
Stanton Twp. Tax.....	35
Sheridan Twp. Tax.....	30

No. of School Dist.	Dist. S. Tax.	Bond Tax.	No. of School Dist.	Dist. S. Tax.	Bond Tax.
No. 1.....	\$ 80	\$	No. 52.....	\$ 1 20	\$
2.....	65	53.....	30
3.....	70	54.....	65
4.....	80	55.....	1 00
5.....	80	40	56.....	1 00
6.....	60	57.....	1 00
7.....	50	58.....	1 50	25
8.....	60	59.....	60
9.....	80	60.....	1 00
10.....	45	61.....	80
11.....	75	62.....	1 15
12.....	70	63.....	1 00
13.....	1 00	64.....	90
14.....	40	65.....	1 00
15.....	60	66.....	70
16.....	1 00	55	67.....	1 00
17.....	65	68.....	1 00
18.....	1 00	69.....	50
19.....	70	70.....	60
20.....	70	71.....	70
21.....	60	72.....	70
22.....	75	73.....	70
23.....	1 00	74.....	80
24.....	60	75.....	1 00
25.....	80	76.....	75
26.....	60	77.....	1 00
27.....	1 20	78.....	75
28.....	80	79.....	75
29.....	50	80.....	1 00
30.....	60	81.....	1 00
31.....	1 20	82.....	1 00
32.....	1 00	83.....	1 00
33.....	90	84.....	50
34.....	1 50	85.....	1 00
35.....	60	86.....	1 00
36.....	80	87.....	1 00
37.....	80	88.....	1 25
38.....	50	89.....	70
39.....	1 25	90.....	1 00
40.....	1 00	91.....	70
41.....	85	60	92.....	1 00	40
42.....	1 20	40	93.....	1 20
43.....	94.....	80
44.....	60	95.....	1 00
45.....	50	96.....	1 00
46.....	30	97.....	1 10
47.....	70	98.....	50	50
48.....	70	50	99.....	1 30	55
49.....	70	100.....	1 50	50
50.....	90	101.....	1 00	30
51.....	80	10 joint.....	90
			70 ".....	1 60
			92 ".....	50
			93 ".....	1 00
			84 ".....	1 00

47-M-64

A. J. HARDING, Genl. Agt.

A. F. DEAN, Asst. Genl. Agt.

Springfield F. & M.



Insurance Company

SPRINGFIELD,

MASSACHUSETTS.

1156

WESTERN DEPT.

118 LA SALLE ST.

G. D. STINEBAUGH,

Resident Agent.

CHICAGO.

RIALTO BUILDING

OTTAWA, KAN.

Ottawa Mo 11/30 1889

Prof Jas K. Patterson

Dear Sir.

I notice in your
tax receipt for Mch. 2-23-22 from
the executor 1³⁸ acres for Railroad right of
way, did you ever get your pay for
this, if not you are entitled to it, and
I have no doubt this paid in for you.
If you desire I will look it up. It is
no doubt a small amount but
worth looking after.

Yours Truly
G. D. Stinebaugh

Office of
 Eubank & Eubank,
 Attorneys at Law,
 Wells-Fargo Bank Building,

El Paso, Texas, Nov 30th 1889

Mrs. J. K. Patterson
 Lexington, Ky.

My dear friend; I'm
 glad to receive your letter
 of Nov. in Hale Co. Tex, Mr. A. A.
 Ford says \$150 is yet due when
 abstract No. Sur No. Name of Clerk
 is sent of Robt McKellan

Please have money sent by P.O.
 order to A. A. Ford Hamrick, Texas

I'm enjoying fine health,
 moderate success and very
 moral contentment of mind
 Kind regards to Mrs. Patterson
 J. W. & William

Very Truly
 B. P. Eubank

No. **51**

Treasurer's Office, Linn Co., Kas.

[with letter Dec. 9, 1889]
Nov 26 1889

RECEIVED OF

Joseph Patterson By *G.D. Stunbaugh* Eleven & ³¹/₁₀₀ Dollars,

being *in full* of all tax for the year 1889, on the following described property, to-wit:

No. Des.	DESCRIPTIONS.	Sec.	Town.	Range.	Valuation.	TAX.
<i>226</i>	<i>E 1/4</i>	<i>13</i>	<i>21</i>	<i>22</i>	<i>400</i>	<i>11 60</i>

Description..... Personal Property, _____

TOTAL..... *11 60*

Amount of Unredeemed Taxes, \$ *1.03*

Date of Unredeemed Sale..... *18 79*

Date of Unredeemed Sale..... *18*

J. A. Maddeu Treasurer.

D. R. Lamoreau Deputy.

\$ *11 31* Rate of tax on other side. Examine your Receipt and see that you pay on the right description and personal property. Amount Paid *11 31*

NOTICE.

Taxes become due November 1st.

On taxes unpaid a penalty of 5 per cent will attach on the 21st day of December, 5 per cent on the 21st day of March, and 5 per cent on the 21st day of June.

If one-half be paid on or before the 20th day of December no penalty will attach on the half unpaid before the 21st day of June.

If all be paid on or before the 20th day of December a rebate of 2½ per cent will be given.

Land for delinquent taxes will be sold on the first Tuesday in September.

Tax deeds may be issued three years from date of sale.

Tax warrants will be issued between the 10th and 15th of January and July.

J. H. MADDEN,
County Treasurer.

[with letter Dec. 9, 1889]

OFFICE OF

COUNTY TREASURER,

LINN COUNTY, KANSAS.

Mound City, Dec 7th, 1889

G. D. Stinebaugh Esq
Ottawa Kansas.

Dear Sir

In reply to yours of Dec 5th in relation to delinquent tax of 1879 on E¼ 13. 21. 22 and Railroad damage fund allowed for land taken from NE¼ 2. 23-22. would say that the delinquent tax was incorrectly marked against E¼ of 13. 21-22 on the 1889 Roll. the Sales Book showing it to be against another tract in same section

There is railroad damage fund in the Treasury to the credit of L. W. Patterson as owner of NE¼ of 2-23-22 for land condemned and taken for right of way for Kansas Nebraska & Dakota Railway Co's railroad across the same. by Commissioners appointed for that purpose. amounting to \$3219

If Mr L W Patterson will

execute the enclosed receipt before an officer authorized to take acknowledgments, with said officers certificate attached, and return to this office. the money will be paid to him or his order. or if it is less trouble to obtain power of attorney, will pay to attorney in fact. upon return of receipt properly executed, and power of attorney.

Very Respectfully
J H Madden

47-N-44

AGENCY OF THE

WESTERN & SOUTHERN DEPARTMENT CINCINNATI, O.
ESTABLISHED 1857.

PHOENIX

TIME TRIED &
FIRE TESTED.

0163

GEO. D. STINEBAUGH,
Resident Agent,
OTTAWA, KANS.

INSURANCE COMPANY of Hartford Conn.

Jas K Patterson
Pres State College
Lexington Ky
Ottawa Kan Aug 1889

Dear Sir,

I enclose you herewith
Communication from Treasurer of Scott County
which explain itself. You will see there is
nothing in the back tax business, and there is
also \$32.¹⁴ deposited for you right of way
and damages &c I enclose you herewith
receipt to sign which must also be acknow-
ledged before Notary Public or other officer
having Seal, or from Government execute
power of Attorney. If receipt you can use
blanks Acknowledgements enclosed, and
forward to me & I will collect & remit
to you. I would favor his letter & attached it
to this enclosed tax receipt.

The description is all right the E 1/4 of a
Section covers the same area as the E 1/2 of Sec 4 & E 1/2
of Sec 4. Supt Jas Reck G D Stinebaugh
(over)

47-M-64

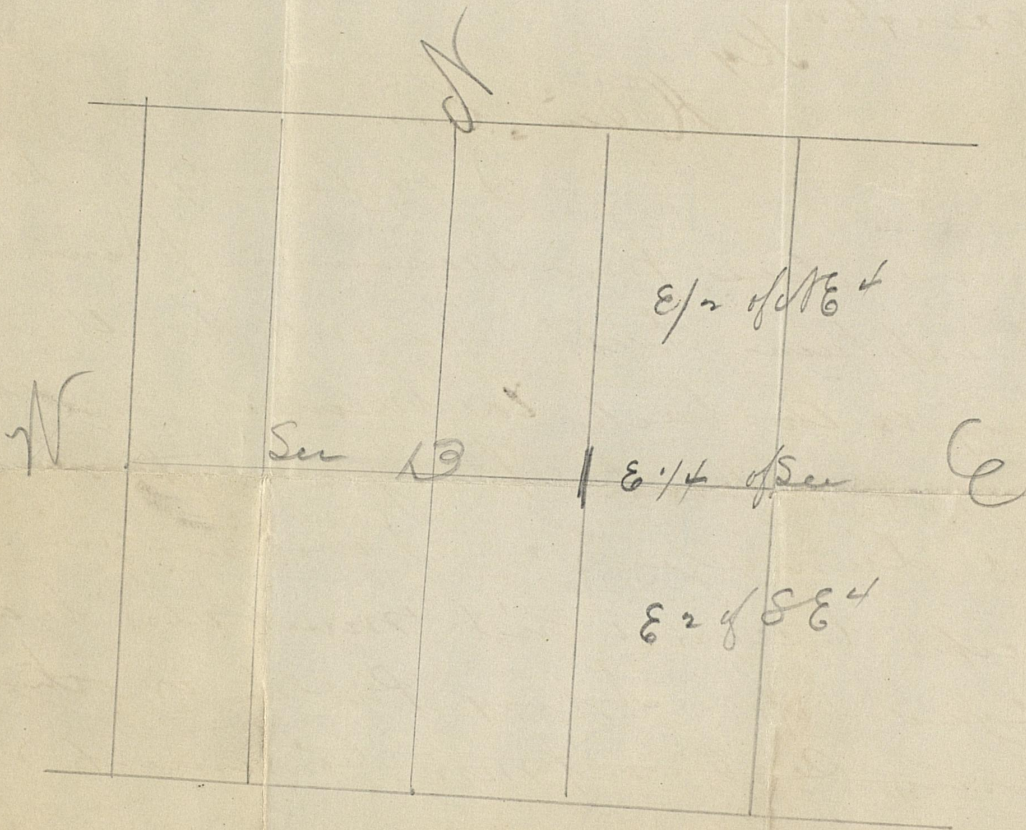

$\frac{S}{2}$



4. Trafalgar Square,
London. 14 Dec 1887
1886.

B. F. Stevens,

Prof Jas. K. Patterson

Public Opinion 1888 & postage	130
English Illus. Mag: do	80
Sunday Magazine do	88

£ 198

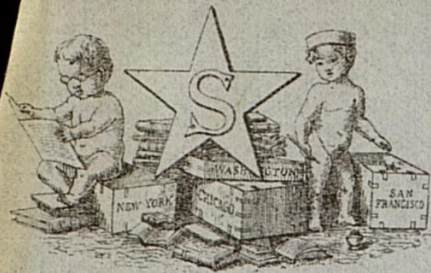

4, Trafalgar Square,
London, W.C. 10 Dec. 1889
Abbreviated Address for Telegrams - Udder London.

B. F. Stevens,

Prof. J. L. Patterson

Public Opinion, 1890 & postage 130

English Illus. Mag. do. 86

Sunday Magazine, do. 88
To Self.

Public Opinion, do. 130
To Mrs A's clay

£ 232



PROF. J. K. PATTERSON,
STATE COLLEGE OF KENTUCKY,
LEXINGTON,
KENTUCKY.

B. F. Stevens,
4. Trafalgar Square,
London, W.C. 188

Abbreviated Address for Telegrams. Uoda London.

DEAR SIR,

17 DECEMBER 1887

IN REPLY TO YOUR LETTER OF THE 30TH NOVEMBER I HAVE THE PLEASURE TO ENCLOSE AN INVOICE £1.9.8 FOR SUBSCRIPTIONS TO THE PERIODICALS ORDERED FOR 1888, WHICH HAVE BEEN DULY ENTERED.

I HAVE NOT YET BEEN ABLE TO FIND THE BOOK ENQUIRED FOR BUT AM LOOKING FOR IT. 2 COPIES OF WHITAKER'S ALMANAC WILL BE SENT WHEN PUBLISHED; AND ALWAYS AT YOUR SERVICE,

YOURS FAITHFULLY,

B. F. Stevens
mfB



PROF. JAS. K. PATTERSON,
STATE COLLEGE OF KENTUCKY,
LEXINGTON, KY:

B. F. Stevens.
4, Trafalgar Square,
London, W.C. 188

Abbreviated Address for Telegrams: Uoda London.

DEAR SIR,

18 DECEMBER 1889

I HAVE THE PLEASURE TO ACKNOWLEDGE THE RECEIPT OF YOUR
LETTER OF THE 3RD INSTANT, AND ENCLOSE HEREWITH AN INVOICE £2.3.2
FOR SUBSCRIPTIONS TO THE PAPERS ORDERED, WHICH HAVE BEEN DULY EN-
-TERED FOR THE YEAR 1890.

'WHITAKER'S ALMANAC' HAS BEEN SENT BY MAIL, AND I TRUST
WILL REACH YOU SAFELY IN DUE COURSE.

ALWAYS AT YOUR SERVICE,

YOURS FAITHFULLY,

B. F. Stevens
BFS

OFFICE OF

A. SANKEY,

NOTARY PUBLIC, REAL ESTATE **AND** INSURANCE

AGENT.

Blue Mound, Linn County, Kansas. December 1889

James K. Patterson

West State College Kentucky

Dear Sir

I have written to our County Surveyor in regard to surveying the timber in Centerville and inclose his reply. Mr Sabin has not settled the ballance of the rent yet - but I believe will by handling him carefully as he is anxious to rent for next year. he has offered sixty dollars for it and two dollars per acre for what is brotce, but I can do better as the grass if good will bring from 75 to 175 per acre that will do to mow. do you wish me to pay the taxes this year. you did not say whether you expected me to pay them out of the rent as I remember. I have had no offer for any of the timber land as yet. and I have heard of no one wishing to purchase. The partition fence on the south between you and Mr Ingersoll will have to be made as he has notified me that I will have to make half of the fence. Would you wish more brotce on that old Correll spot - there is 20 or 25

acres more that is not fit to leave for grass, as it
is eat entirely out by the sheep, and could be
plowed the same as old ground and a good
crop raised the first year, any instruction
you may give will be strictly attended to

I am very truly
Yours
A. Santory

WOLVERHAMPTON & WALSLEY

W. D. NICHOLAS, PRESIDENT.
LEXINGTON, KY.

ROBT. C. JAMES, TREASURER.
LEXINGTON, KY.

Jan 21 1889
J. E. ROGERS, SECRETARY.
LEXINGTON, KY.



BREWER SMITH, Supt.
CROWN HILL, WEST VA.

FOR STEAM AND GRATES.
266 EAST MAIN ST.
TELEPHONE NO. 24.

LEXINGTON, KY.

Jan 21st 1889

ST. LOUIS BANK NOTE CO. &

Per J. K. Patterson

Dear Sir

John has quite often
during the season been detained by my
failure to start from home in time, for him
to reach his class, and a no of
demerits charged to him on this account
should be taken off. How many I
can not say with any degree of
accuracy but it has occurred
quite often. Yours Respectfully
W. D. Nicholas

Please note that we make all Quotations and Contracts subject to the contingencies of Transportation, Strikes, or Lock-Outs at the Mines
and Advances in Mining or Rates of Transportation. Weights at Mines to govern Settlements. No Claim for Shortage will be allowed

Book J. W. Patterson
addressed

47-11-64

1889

State College of
Kentucky.
President's Room.

Lexington, Ky., 18

Martin Martin
" Sergeant
Adjutant
Sergeant Major

Mumcey
Sevill
Jales
Leath

Captains

Leathwood Co. D
Gunn Co. A
McFarlin Co. B

First Lieutenants

Hoey, Nicholas, Roddick

Second Lieutenants

Anderson Mulligan Wallis
Color Sergeant, Book

1st Sergeants

Ingram Davis Steadman

Second Sergeant

McConarty Williams Hraun

1889

State College of
Kentucky.
President's Room.

Lexington, Ky., 18

3rd Sergeants

Bryon Stangill Crenant

4th Sergeants

Oldham Pottinger Trigg

1st Corporals

Cox Brownworth Sr. Bryon Dew

2nd Corporals

Elkin Bartlett Asher H.H.

3rd Corporals

Berry Curtis ~~Coyne~~ ^{Celandy}

4th Corporals

~~Celandy~~ Reynolds Jackson

~~Page~~
Page

THE VICTORIA SERIES. *

An Entirely New Series of Choice Booklets.

Illustrated in Monotint.

True Comfort. . . .

A TOKEN OF SYMPATHY FOR THE
.. BEREAVED. . .



Reduced Specimen of Cover.
Appropriate Selections by SARAH GERALDINE
STACK, PAUL FLEMING, and others.
Price, 15c. each. \$1.50 dozen.

TRUE SERVICE. * *



Reduced Specimen of Cover.
CONTENTS.
Whose I am and whom I serve. The worker's prayer.
Tolling or rowing. What have I done for Jesus,
The worker's return.
By SARAH GERALDINE STACK, F. WHITFIELD and others.
Price, 15c. each. \$1.50 dozen.

NEW YEAR VOICES. - - -

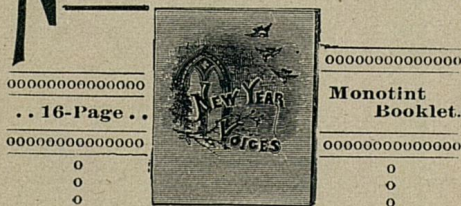

Reduced specimen of cover.
"What wilt thou do with the year,
That is dawning so fresh and clear,
Dawning on whiteness,
Dawning on brightness,
What wilt thou do with the year?"

Special Discount to Y. M. C. A.

47-M-64

the public, the Company has arranged for unusually large and handsome offices at New York and London.

LONDON OFFICES.

The Company occupies the entire building at No. 13 Pall Mall, in the heart of the fashionable portion of London, opposite the Athenaeum, Travelers' and Reform Clubs, and near the foot of Regent Street, and the principal Hotels and Theatres, and has fitted it up for the comfort of its passengers and of the American traveling public generally.

The building is admirably adapted for the purpose, there being on the ground floor a large office for giving information and booking passengers. On the same floor is a comfortable smoking-room and lavatory. Upon the first floor there is a large reading-room, furnished with files of the principal American newspapers, Directories of the principal American cities, and other books of reference needed by travelers, with every convenience for writing letters, etc. There is also a handsomely-fitted ladies' room adjoining it.

A register will be kept of Americans in London who may call at this office. Letters can also be addressed to the care of the Office, and instructions left for forwarding them to the Continent or elsewhere. A cable code is being arranged for the use of passengers by the Line, for economy in telegraphing between London and the United States.

Americans staying in London for a long or short period, will have the privilege of using these facilities.

The city offices of the Company, 99 Cannon Street and 76 Leadenhall Street, still remain in charge of Messrs. EIVES & ALLEN, and berths may be secured and information obtained there as heretofore.

NEW YORK OFFICES.

At New York the Company occupies the large brick mansion at No. 6 Bowling Green, and extensive alterations have been made.

Upon the first floor are the general offices of the Line, with a spacious and thoroughly lighted and ventilated room for booking passengers, displaying plans of steamers, etc. There is also a Ladies' room.

A very large room upon the second floor is devoted to the use of travelers as a reading and writing room.

Letters addressed to the care of the office will be retained until called for, or forwarded, according to instructions.

PETER WRIGHT & SONS,

GENERAL AGENTS.

Chas. L. Monsch,

GENERAL AGENT

European Steamship Agency,

Foreign Drafts & Money Orders a specialty.

S. W. COR. THIRD & MAIN,

LOUISVILLE, KY.

INMAN AND INTERNATIONAL STEAMSHIP CO.

(LIMITED).

INMAN LINE.

DESCRIPTION OF THE NEW STEAMSHIPS

"City of Paris" AND "City of New York"

10,500 TONS EACH.

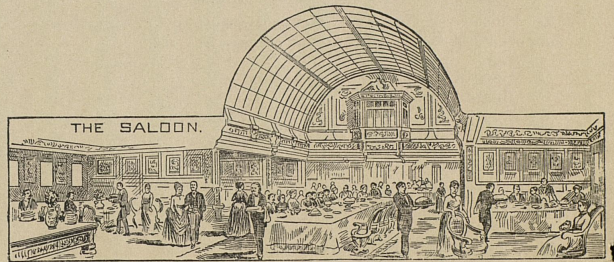

APPOINTED TO SAIL FORTNIGHTLY

BETWEEN

NEW YORK AND LIVERPOOL.

PETER WRIGHT & SONS,

General Agents,

No. 6 Bowling Green,

NEW YORK.

Class. II. Moonrath,
 GENERAL
European Steamship Agency
 Foreign Drafts & Money Orders a Specialty.
 S. W. COR. THIRD & MAIN,
 LOUISVILLE, KY.
INMAN LINE.

Inman and International Steamship Company

(LIMITED).

New York, January, 1889.

WE take pleasure in announcing that the Company's magnificent new twin screw Steamships, "CITY OF NEW YORK" and "CITY OF PARIS," have been appointed to sail as per enclosed schedule. These Steamships mark not only a distinct step in the history of the Line, but in that of ocean transportation. They have already been very specially and accurately described in the public prints of Great Britain and the United States, and we therefore recapitulate only a few of the principal facts of interest about their dimensions, construction, etc., etc.

	FEET.
Length over all,	580
Breadth, extreme,	63¼
Depth, from top of upper deck cabins to bottom of keel,	59¼

Designed and sub-divided with **Water-tight Bulkheads** to the Upper Deck, with no openings through them, making them **absolutely unsinkable**.

Arranged to accommodate comfortably 450 First Cabin Passengers and 200 Second Cabin Passengers.

The First-Class Passengers are berthed in Sleeping Cabins upon the Main and Upper Decks, as usual, besides which, there are 43 Cabins on the Promenade and Saloon Decks, furnished as Sitting-rooms during the day, and available also for sleeping, if desired. Fourteen of these rooms are arranged *en suite*, with Sitting-room, Bedroom, Bathroom, and Toilet-room.

The time has arrived when we can bring to the special attention of the traveling public several details of very great interest, which have not been elaborated upon in the former descriptions of these ships. Among these, and prominently, are the special means taken to secure ventilation and lighting of all the rooms, so that all are equally comfortable, and that it will be unnecessary for travelers by these ships to make, as is usual now, a selection of certain locations for their rooms.

An improvement which will be highly appreciated by travelers and by invalids, is the location of the Kitchens; these are below, entirely isolated in a separate steel compartment, out of sight, and ventilated directly into the main smoke-stacks, so that no smell of cooking will be perceptible anywhere about these ships. Hydraulic power is employed instead of steam for the daily work of these ships, such as steering, hoisting stores, ashes, etc., etc. The hydraulic machinery is almost absolutely noiseless.

Attention is particularly requested to the special accommodations which are provided for travelers, and especially families, desiring greater privacy than is now obtainable on ocean steamships. These are the Suites and Deck Cabins. The former consist of Sitting-rooms, Bedrooms, Bathrooms and Toilet-rooms, all connecting, and every room furnished in the manner of those in the best private houses. The Deck Cabins are unusually large rooms, in which the berths fold up somewhat in the manner of those in Pullman cars, making of the bedroom a sitting-room for day use. Passengers occupying the Suites and these special rooms can have their meals served there, and the ability to, in this way, entertain friends or acquaintances who may be fellow-voyagers, will furnish an attractive novelty in the daily routine of the voyage. The large number of regular staterooms are of greater size than usual, and they are all very elegantly furnished. Great attention has been paid to the needs of passengers in respect to convenient location of bathrooms and toilet-rooms. The plans show the liberality with which these accommodations have been provided.

A special feature of these ships is the accommodation for the **Second Cabin Passengers**, which is more complete than anything heretofore attempted. These passengers are carried on the same decks as the First Cabin, and have a special appropriation of 125 feet of the Promenade Deck, with a plentiful supply of seats and a spacious Smoking-room. They have their special Saloon on the Upper Deck, and all their rooms are fitted with electric lights and ventilated, while they have a plentiful supply of baths with hot and cold water and lavatories. Their Staterooms are superior to the First Cabin of many steamers.

The ventilation, sanitary arrangements, plumbing, etc., have received scientific care, and the usual natural ventilation now existing in the best passenger steamers is supplemented by fans driven by electricity, so that uniform liberal circulation of air is secured without dangerous drafts. All rooms are equally well ventilated.

Berths can now be engaged for the season of 1889, and intending passengers are recommended to make early application for berths and staterooms.

In connection with this great improvement in the fleet, and to provide commensurate facilities for the transaction of its business with

[1889]

Pres. Patterson,
Please pay the President
of the Mass Hall \$2.00
and oblige.

S. L. Pottinger

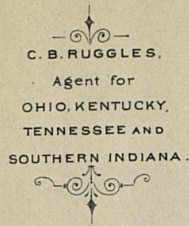

D. Appleton & Co.,
Publishers.

EDUCATIONAL
DEPARTMENT,
C. W. BROWN, MANAGER,
New York,
Boston,
Chicago,
Atlanta,
San Francisco.

237 Vine Street,

Cincinnati, O.

Nov. 16th, 188

Pres. James K. Patterson.
State College of Ky.
Lexington Ky.

Dear Sir:-

Your kind favor of the 9th. to D. Appleton & Co. New York has been forwarded to me as I am the agent of that house and have the state of Kentucky. I have read your communication with interest and I take pleasure in mailing you this morning a copy of "Eggleston's History of the U. S." Please accept this book with the compliments of the house. Would you have the kindness after examining this work to write me what you think of it? I should be very glad to get your opinion whether favorable or unfavorable. Inclosed I send you our special price list giving terms for first introduction of all our educational works. At any time when you desire to examine any of our books I shall take pleasure in furnishing them to you for that purpose. Hoping to hear from you at an early day, I remain,

Yours Most Truly,

C. B. Ruggles.



Jos. M. SCOTT.

T. T. SKILLMAN.

SCOTT & SKILLMAN,
DEALERS IN
Carpets, Oil Cloths,
WALL PAPER,
CURTAINS, &c.

Lexington, Ky., _____ 188

Mr. Prof. J. K. Patterson

Bought of SCOTT & SKILLMAN,

No. 9 West Main Street.

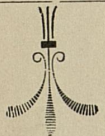

TERMS CASH.

188 Folio *215*

<i>Apr 11</i>	<i>90</i>	<i>2 Yds Papering</i>	<i>90</i>	<i>180</i>	
<i>Sept 15</i>	<i>10</i>	<i>Yds Program</i>	<i>70</i>	<i>700</i>	
		<i>4 Permits</i>	<i>64</i>	<i>22</i>	
<i>Oct 24</i>		<i>4 Yds Curtains</i>	<i>110</i>	<i>440</i>	
		<i>Packs 10 Gum Pad 25</i>		<i>31</i>	<i>1370</i>
<i>Jan 21 '86 Rec'd Pay Scott & Skillman</i>					

J. K. Patterson

111

13.74

47-N-64

100

JAMES M. SKILLMAN

James M. Skillman

LEUNG OYEN

CHIEF CLERK

MANAGER

CHIEF CLERK

MANAGER

CHIEF CLERK

MANAGER

W. PRUNKETT, Treasurer.
ALBERT ALLEN, Gen'l Manager.

Lexington, Ky., 188

M. J. K. Patterson



TRANSYLVANIA PRINTING COMPANY

STEAM **JOB** PRINTERS,

Book Binders and Blank Book Manufacturers,

CATALOGUES
A SPECIALTY

NO. 51 EAST MAIN STREET.

STATIONERS.

1887

March 22	To 1 Desk Pad	\$ 1.50	
May 13	" Ruler ^{25¢} , Env Opener ^{50¢} & Mucilage ²⁵	1.00	\$ 2.50
June 22	" Putting name on Diplomas		50
			\$ 3.00

Fol. 669

STATEMENT.

New York, Dec 31st 1888.

M. Kentucky State College
Lexington Kentucky
To **EIMER & AMEND, Dr.**

205, 207, 209 and 211 THIRD AVE., Cor. 18th St.

Aug 25	To Merchandise as per Bill rendered	165 26	
Sept 28		4 11	
Dec 19		<u>11 30</u>	180 67

C. B. France, President

E. Lindsay, Cashier

State National Bank.

St. Joseph, Mo., January 20, 1890.

DEAR SIR:

The stock of the State National Bank has all been placed, as previously advised by our broker, Mr. Wm. A. Wilson, who has also made the call for February 1st, and I will now ask you to please be kind enough to remit the same so it will arrive here by February 1st. I want the good wishes and hearty co-operation of every stockholder, and will ask you to feel free to command me at any time; and if you have at any time any suggestions to offer, do so, as it will be my aim, in conjunction with the Board of Directors, to run this bank for the benefit of the stockholders and the customers, in the most careful and conservative way possible. I will be gratified to have a personal visit from you at any time, and if you do so, I think you will be pleased with our city and your investment. Where and whenever it is possible to say a good word and influence business to our bank, please do so.

The first call is \$56.00 per share, and \$10.00 per share on the first of each month thereafter till paid up in full, as per terms of subscription. Receipts will be sent for each installment. Or, if parties desire to pay up in full on February 1st, they may deduct 62½ cents per share and remit in full. When shares are paid for in full, a stock certificate will be sent at once.

The number of shares awarded you is 30.

Respectfully,

Josh. Patterson
Lexington Ky

C. B. FRANCE,

President.

S. P. STRONG, Abstracter.

L. S. KINDER, County Atty.



STRONG & KINDER,

REAL ESTATE AND COLLECTING AGENTS.

LANDS RENDERED FOR NON-RESIDENTS, REDEEM LANDS SOLD FOR TAXES, TITLES ADJUSTED, AND A COMPLETE ABSTRACT TO LAND TITLES OF HALE COUNTY.

Plainview, Texas, Jan'y. 28 1889

Jas. Patterson Esq.
Lexington Ky.

Dear Sir-

We would like to know your price on your land in Hale County, as we have a considerable list of land in this part of the state for sale, and would be glad to place yours on our list and try to make sale for you.

Please let us hear from you and send description of your land as you have it.

Respectfully

Strong & Kinder

3052.

CAPITAL \$100,000.

THIRD NATIONAL BANK,
OF LEXINGTON.

Lexington, Ky., July 29 1890

President J. K. Patterson

ATM College Lexington Ky

Mr President

Sorry indeed to know
 you are tied up, I am been quite
 down myself - for a few days
 but am so busy I can't find
 time to lay up for repairs, your
 letter of 27th came in with our
 mail yesterday morning, I sent the
 money yesterday afternoon for \$64 call
 on St. Joe and will see that you
 get the \$405 M when you want it,
 we had to be discount - about
 10 M again yesterday and am
 carrying full up which by the way
 is as I see it the way a small bank
 must do to make money, there
 seems to be a lull in Northern &
 other local stocks except Fayette
 which since its 50¢ adv. is up to 180¢
 in good demand, I have a lot of 200,

J. W. BERKLEY, President.

W. J. LOUGHRIDGE, V. President.

J. H. SHROPSHIRE, Cashier.

3052.

CAPITAL \$100,000.

THIRD NATIONAL BANK,
OF LEXINGTON.

Lexington, Ky., 188.....

Bank & Farmers Bank for sale
at 32 & 31 respectively lent buyers
are very scarce I hope you
will soon be out & OK again
Yours Friend
J. H. Shropshire

- June 27 - 1890

State College Dr

To State College Bayonet
for one page advertisement June
No. for 57 Rates \$4⁰⁰ per page.
Received payment per page.

Keen & Foster manager.

20
38
36
34
36
27
38
38
36
17
36
20
34
36

20
38
36
21
35
36
33
32
33
36
38
38
34

815

J. B. MORTON,

578

JNO. M. GREENWAY,

A. R. MILLIGAN,

TELEPHONE NO. 126

Lexington, Ky. 1st July 1890

Agd + Mecht College

Bought of J. B. MORTON & CO.,

WHOLESALE AND RETAIL

Booksellers, Stationers and Druggists,

1890

No. 26, EAST MAIN STREET.

<i>Oct</i>	<i>4</i>	<i>10</i>	<i>Gospel Hymns 1, 2, 3, 4.</i>	<i>Main Bk of J. B. M.</i>	<i>7 50</i>		
		<i>30</i>	<i>" " " " 1, 2, 3, 4.</i>	<i>Writ 20</i>	<i>6 00</i>		<i>\$ 13 50</i>

578

Agri & Mecht College

7

J.B. Morton Co

\$13⁵⁰

POSTAGE

PAID BY ADDRESSEE

POSTAGE

PAID BY ADDRESSEE

POSTAGE

47-M-104
AD-W-14

J.B. MORTON & CO
1824 1/2 N. 1st St.
St. Paul, Minn.

No.

LEXINGTON, KY.

Oct. 27 1890

THIRD NATIONAL BANK

Pay to ^{order} J. C. Rogers S. T. C. or Bearer,

Three + 91/100

Dollars.

Taxes for 1890.

\$ 3 ⁹¹/₁₀₀

James K. Patterson,
by W. K. Patterson,
Attorney.

W. MANN CO. PRINTERS PHILADA.

J. C. Rogers J. F. C.

PAID

OCT 30 1890

The Phoenix Nat'l Bank.

LEXINGTON, KY.

457-M-64

ANNUAL STATEMENT JANUARY 1, 1902.

INCOME.	
Premiums	\$10,111,607 75
Amortization	6,136 43
Interest and rents	2,420,735 51
Total income	\$12,548,479 71
DISBURSMENTS.	
Claims by death	\$2,239,686 44
Matured endowments	497,659 41
Amortization	66 40
Surplus and unpaid policies	1,628,192 37
Dividends to policy holders	1,628,192 34
Total payments to policy holders	\$4,954,047 60
Taxes	133,044 67
Commissions agents' expenses and salaries	1,572,136 54
Medical examinations	116,276 50
Office salaries and expenses of trustees	189,711
Legal, loan and real estate expenses	115,235 30
Advertising	3,120 50
Supplies and postage	47,384 73
Exchange and printing	95,033 63
Fuel, gas, building, furniture, traveling	18,364 69
Premiums on bonds bought	14,041 17
Profit and loss	51 42
Total disbursements	\$4,400,357 95
ASSETS.	
Loans on bond and mortgage	\$40,715,767 44
Premium notes	1,262,191 88
Real estate	1,262,191 88
United States bonds, market value	1,262,191 88
State and municipal bonds, market value	1,262,191 88
Cash on hand and in banks	1,262,191 88
Accrued interest on bonds	1,262,191 88
Later accounts and bills receivable	1,262,191 88
Deferred premium (5 per cent. deduction)	1,262,191 88
Premiums in course of collection (60%)	1,262,191 88
Total assets	\$48,286,715 45
LIABILITIES.	
Loans and endowments on hand	\$ 1,000,000 00
Unpaid dividends, etc., (estimated)	100,000 00
Reserve for policyholders' insurance	15,000,000 00
Reserve for policyholders' interest	15,000,000 00
Reserve for policyholders' expenses (4 per cent.)	60,000,000 00
Total liabilities	\$78,000,000 00
Surplus on 4 per cent. basis	\$7,891,700 55

OFFICE OF THE
NORTHWESTERN MUTUAL LIFE INSURANCE CO.

MILWAUKEE, January 20th, 1902.

To the Trustees and other Policy-holders of the Northwestern Mutual Life Insurance Company.

The Executive Committee of the Board of Trustees submits its report of the business of 1901, found herewith in detailed statements, before entering upon which, however, a few words may be fitting:

The official investigation of a leading life insurance company, and widely published letters from the presidents of two other leading companies, mentioning reinsurance and more conservative methods of securing and transacting business, have largely centered interest in life insurance matters during the past few months, and have very naturally suggested to the public that reform is necessary in some of the methods and practices that have recently grown up in carrying on the life insurance business.

The Northwestern is an advocate of reform, first of all within itself if needed; then wherever and whenever needed. Believing it to be better and better for any institution to find its own opportunity for improvement, its practices always have been welcome reinsurance or amendment desirable, to benefit both the Company better in such regard. This Company has from the beginning aimed to conduct its affairs in all departments with a rigid adherence to sound and honest business principles and economy, and to continue in its service only those whose work here evidences efficiency and integrity.

Reform in life insurance methods is considered necessary, first, in the character and quality of business obtained; second, in the expense of securing business and administering company affairs; and third, in the investment of trust funds. Pledged as the Northwestern has been and is, to increase its strength and worthiness from year to year, let its executive policy the Company's record in the above particulars. The standard of membership in this Company has always been high; higher indeed, in 1901 with a new business of six-and-a-half millions than ten years before with a business of only fifteen millions. The average death rate of the Company during the past

twenty years was 1.86; during the past fifteen years, 1.47, during the past ten years, 0.97, during the past five years, 0.56; during the past year, 0.53, and lower during each period than the death rate of any other leading company.

The supremacy of the Northwestern among its principal competitors, in point of interest rate, continues. Comparison of this report with statement of last January, will show that the rate actually earned in 1901 was 5 1/2 per cent. on the assets at the beginning of the year*. The same well-known, careful and exact standard and methods govern the investment of its funds, and we think no other company can show its entire "reserve" invested in first mortgage bonds. In 1901 the amount added to surplus in the Northwestern exceeded that of any other company, while in 1901 this increase was fifty-two per cent. larger than in 1900. Figures on any of these points, in other companies, are not made public. Relative to the expense of securing new business, our Company has not for years, in a single instance, paid salary to any general or soliciting agent; while the grade and rate of commission paid for business is no higher than eight years ago. The "Ratio of Expenses and Taxes to New Business," during 1901 and 1900, was lower in the Northwestern than in any other regular company, and lower still in 1901; moreover, our Company, during each of the years 1900 and 1901, after deducting expenses, losses, endowments, dividends—in fact, all disbursements—had a larger percentage of income remaining for investment than any other company in the United States, with a single exception, one of the smaller companies. In 1901 the Northwestern had all the companies in this report, our ratio that year being fifty-three per cent. higher than the average of the ten largest companies, and twenty per cent. higher than that of the company standing second. The Company's record in this regard was six per cent. higher last year than in 1900. It is also proper to state in this connection that our Company, during 1901, in collecting nearly nine millions of dollars in premiums, lost through its agents only \$71.96, or less than one one-hundredth of one per cent. In 1901, in collecting over one million of dollars, it lost nothing.

Our policyholders have become willing to waive the distinction of belonging to the largest company in the world, to have experimentally found that such results as the foregoing, means not only increased and increasing solidity and strength, but annual and substantial benefits to them not equalled by any other company in the world.

Interest accrued but not due, extends some ten year ago but over \$10,000.

The Company, during the past year, paid dividends on its first ten-year term policy, issued in 1901, that proved very satisfactory, and justify the belief that, whatever the results under such policies may be in the future, they cannot fail to yield larger surpluses for premiums paid than any other form of life and investment insurance in this or in any other country.

The new business of the Company was larger in 1901 than during any previous year; the business each month of the year being larger than in any corresponding month in the Company's history. The steady growth in this regard may be seen from the following table:

YEAR.	NO.	AMOUNT.	PERCENT.
1897	11,900	\$20,148,905 00	\$1,200,132 68
1898	13,321	40,253,341 00	1,728,428 68
1899	14,631	40,025,272 00	2,084,023 99
1900	15,242	52,117,112 00	3,467,625 98
1901	16,824	64,262,201 00	4,213,114 47

Adding reinsurance, etc., as is done in the official reports of Insurance Commissioners, as well as in the advertisements of other companies, the amount of new business of the Company written in 1901 was \$8,398,472.

The work of the Loan Department shows a larger amount of money loaned than during any previous year, \$13,384,034.25. Following is a statement of loans made on bond and mortgage for five years last past.

YEAR.	LOANS ON BOND AND MORTGAGE.	TOTAL AMOUNT OF ASSETS.
1897	\$ 5,238,873 77	\$31,431,495 86
1898	6,445,373 68	37,762,737 01
1899	6,807,572 34	39,048,433 22
1900	8,219,701 31	44,646,025 41
1901	10,264,928 25	60,710,027 41

The assets January 1st, 1902, were \$48,286,715.45.

The income for 1901 was—

Premiums and Amortization	\$10,111,607.75
Interest and Rents	2,420,735.51
Total	\$12,548,479.71

The surplus over a four per cent. reserve is \$7,891,700.55.

The whole number of policies in force January 1st, 1902, was 113,038, amounting to \$775,674,570, an increase for the year of 10,000 policies and \$20,970,946 insurance; probably no other

large company can show such a proportion of insurance gained as compared with new business written during the year.

The death rate for the year was 0.53 of the mean amount at risk. The average rate of all companies reporting to the Massachusetts Insurance Department in 1901, was 1.54.

During the fifteen years the Company commenced business it has paid to the representatives of its insured policy holders, for death benefits, matured endowments, surrendered and liquidated, \$20,348,598 25. And to its living policy holders and hold-overs, \$10,700,624 74.

Total amount paid to policy holders and hold-overs for benefits, \$31,049,223 00.

Amount paid to policy holders and hold-overs for premiums received, \$11,135,593 91.

The payments to policy-holders added in the present assets amount to over eleven millions more than the entire premiums received.

The annual statement herewith shows the income and disbursements for the year 1901, and the amount of the assets, liabilities and surplus thereover. The assets have increased \$6,472,842.45 during the year, and the surplus, \$1,397,037.07. The statement shows that the securities in which the assets are invested are of the superior quality required by the charter and justified by the experience of the Company.

The examining committee of the Board of Trustees, consisting of Messrs. A. P. WATERMAN, GEO. F. WHEELER and P. F. ADAMS, are now engaged in the examination of the business for the six months ending on the 31st of December last, and will submit their report to the Board at the meeting to be held on the 6th inst.

H. L. PALMER, C. N. NASH,
MATTHEW REISNAU, W. F. McLELLAN,
GEO. W. WHEELER, CHARLES E. EYER,
WILLIAM MERRILL,
Executive Committee.

We have not completed a careful examination of the books and accounts and find that the accompanying statement of the condition of the Company on the thirty-first day of December, 1901, is correct.

A. P. WATERMAN,
GEO. F. WHEELER,
P. F. ADAMS,
Examining Committee of the Board of Trustees.

NORTHWESTERN MUTUAL LIFE INSURANCE COMPANY.

NEW POLICIES ISSUED DURING THE YEARS 1890-1901.

NO.	AMOUNT.	PERCENT.	STATE.	NO.	AMOUNT.	PERCENT.
1,001	\$1,000 00	100.00	New York	4,546	\$1,000 00	100.00
1,002	1,000 00	100.00	Wisconsin	4,547	1,000 00	100.00
1,003	1,000 00	100.00	Minnesota	4,548	1,000 00	100.00
1,004	1,000 00	100.00	Illinois	4,549	1,000 00	100.00
1,005	1,000 00	100.00	Pennsylvania	4,550	1,000 00	100.00
1,006	1,000 00	100.00	Iowa	4,551	1,000 00	100.00
1,007	1,000 00	100.00	Ohio	4,552	1,000 00	100.00
1,008	1,000 00	100.00	N. and S. Dakota	4,553	1,000 00	100.00
1,009	1,000 00	100.00	Mississippi	4,554	1,000 00	100.00
1,010	1,000 00	100.00	Alabama	4,555	1,000 00	100.00
1,011	1,000 00	100.00	Georgia	4,556	1,000 00	100.00
1,012	1,000 00	100.00	Indiana	4,557	1,000 00	100.00
1,013	1,000 00	100.00	Virginia	4,558	1,000 00	100.00
1,014	1,000 00	100.00	Kentucky	4,559	1,000 00	100.00
1,015	1,000 00	100.00	Tennessee	4,560	1,000 00	100.00
1,016	1,000 00	100.00	California	4,561	1,000 00	100.00
1,017	1,000 00	100.00	Connecticut	4,562	1,000 00	100.00
1,018	1,000 00	100.00	Massachusetts	4,563	1,000 00	100.00
1,019	1,000 00	100.00	Delaware	4,564	1,000 00	100.00
1,020	1,000 00	100.00	Washington	4,565	1,000 00	100.00
1,021	1,000 00	100.00	Oregon	4,566	1,000 00	100.00
1,022	1,000 00	100.00	Utah	4,567	1,000 00	100.00
1,023	1,000 00	100.00	Arizona	4,568	1,000 00	100.00
1,024	1,000 00	100.00	Idaho	4,569	1,000 00	100.00
1,025	1,000 00	100.00	Montana	4,570	1,000 00	100.00
1,026	1,000 00	100.00	Wyoming	4,571	1,000 00	100.00
1,027	1,000 00	100.00	Nebraska	4,572	1,000 00	100.00
1,028	1,000 00	100.00	Colorado	4,573	1,000 00	100.00
1,029	1,000 00	100.00	Missouri	4,574	1,000 00	100.00
1,030	1,000 00	100.00	Arkansas	4,575	1,000 00	100.00
1,031	1,000 00	100.00	Louisiana	4,576	1,000 00	100.00
1,032	1,000 00	100.00	Florida	4,577	1,000 00	100.00
1,033	1,000 00	100.00	South Carolina	4,578	1,000 00	100.00
1,034	1,000 00	100.00	Alabama	4,579	1,000 00	100.00
1,035	1,000 00	100.00	Georgia	4,580	1,000 00	100.00
1,036	1,000 00	100.00	Florida	4,581	1,000 00	100.00
1,037	1,000 00	100.00	South Carolina	4,582	1,000 00	100.00
1,038	1,000 00	100.00	Georgia	4,583	1,000 00	100.00
1,039	1,000 00	100.00	Alabama	4,584	1,000 00	100.00
1,040	1,000 00	100.00	Florida	4,585	1,000 00	100.00

OVER \$68,000,000 IN 1891.

The above table includes only new policies, including reissues, etc., as is shown in the official reports and as in the advertisements of other companies; the general list of business of the Department in January 1902 was \$100,000,000.



47-N-04
OLD AND SECOND-HAND BOOKS.

THE extensive experience of this Agency in the selection and purchase of rare old books and manuscripts is placed at the service of book Collectors in the United States. Book auctions are carefully watched and good knowledge kept of the stocks of the old booksellers of Europe. Lists of desiderata have the best attention, and in the selection of books the most careful comparison of copies is made.

Advance copies of sale catalogues, when they are printed in sufficient time for orders to be sent before the sale takes place, are supplied when desired.

Special attention is also paid to binding old books in the most appropriate manner by the best English and French binders.

Circulating Library copies of new books are usually to be had three to six months after publication at considerably reduced prices, and when put into half morocco binding make handsome books at low prices.

Engravings, Drawings and Paintings, Philosophical Apparatus, Scientific Instruments, and all other wants of libraries receive due attention.

This being a strictly ready-money commission business, it is necessary that orders should be accompanied by funds, and that current accounts should be kept well covered.

Remittances to B. F. Stevens, 4, Trafalgar Square, Charing Cross, London, England, may be made in sterling by Bankers' drafts, or Post Office orders on London; or in American currency at five dollars to the pound sterling, this being 25 cents to the shilling. For odd amounts send postage stamps.

The New York agents of B. F. Stevens are Messrs. TICK & LYNCH, 34 1/2, Pine Street, who will supply copies of this list, and receive payments on his account.

*B. F. Stevens, 4, Trafalgar Square,
Charing Cross, London, England.*



EUROPEAN NEWSPAPERS AND
MAGAZINES WITH PRICES OF
PUBLICATION AND POSTAGE
DIRECT FROM ENGLAND ON
DAY OF ISSUE

1889

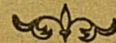

FOR PARTICULARS OF NEW AND OLD
ENGLISH BOOKS AT ENGLISH PRICES AT
TWENTY-FIVE CENTS TO THE SHILLING
AND MODE OF MAKING REMITTANCES

SEE LAST TWO PAGES



PRINTED AT THE CHISWICK PRESS FOR
B. F. STEVENS AMERICAN
LIBRARY AND LITERARY AGENT
4 TRAFALGAR SQUARE CHARING
CROSS LONDON ENGLAND



NEWSPAPERS AND MAGAZINES
AT ENGLISH PRICES.



EWSPAPERS and Periodicals at the price of publication and postage are mailed to subscribers in the United States on the days of issue, and so reach subscribers at the earliest possible day and at economical rates.

Subscriptions, payable in advance, may usually commence at any time and be taken for any period. Sample copies will be supplied upon application with remittance.

Remittances may be made by draft, P.O. Order or Currency direct to B. F. Stevens, or to his New York agents, Tice and Lynch. See last page.

Illustrated periodicals may be sent by mail, rolled, in cardboard tubes, at the additional cost of the tubes and extra postage.

The postage from London to any part of the United States on newspapers, magazines, and books is one halfpenny (one cent) for every two ounces up to four pounds weight.



DAILY PAPERS

With price of annual subscription, including postage, in sterling and federal money at \$4.87 to the £.



AILY NEWS. 52s. Liberal—Non-conformist.	\$12.65
Daily Telegraph. 52s. Largest daily circulation in the world.	12.65
Globe (Evening). 39s.	9.50
Manchester Guardian. 58s.	14.12
Morning Post. 52s.	12.65
Pall Mall Gazette (Evening). 39s.	9.50
" " weekly edition. 21s. 8d.	5.28
St. James' Gazette (Evening). 52s.	12.65
" " weekly edition. 32s. 6d.	7.92
Shipping and Mercantile Gazette. 104s.	25.30
Sporting Life. 42s. 9d.	10.42
Sportsman. 42s. 9d.	10.42
Standard, Conservative. 52s.	12.65
Times, with full Supplement. 120s.	29.22
" without Sup. 104s.	25.30
" weekly edition. 13s.	3.16
Mail (made up from the Times), tri-weekly. 39s.	9.50

B. F. Stevens, 4, Trafalgar Square,



WEEKLY NEWSPAPERS

With price of annual subscription (52 Nos.) including postage, in sterling and federal money at \$4.87 to the £.



ACADEMY. 17s. 4d.	\$4.22
Agricultural Gazette. 13s.	3.16
All the Year Round. 10s. 10d.	2.64
Amateur Photographer. 13s.	3.16
American Register. 20s.	4.87
Anglo-American Times. 21s. 8d.	5.28
Architect. 26s.	6.33
Army and Navy Gazette. 30s. 4d.	7.39
Athenæum. 17s. 4d.	4.22
Belfast Northern Whig. 9s. 1d.	2.22
Bell's Messenger. 26s.	6.33
Boys' Own Paper. 6s. 6d.	1.58
British Architect. 23s. 8d.	5.77
British Journal of Photography. 17s. 4d.	4.22
British Medical Journal. Thin paper, 30s. 6d.	8.03
" Thick paper, 33s.	8.03
Broad Arrow. 30s. 4d. Civil Services.	7.39
Builder. 26s.	6.33
Builder's Weekly Reporter. 13s.	3.16
Building News. 26s.	6.32
Bullionist. 30s. 4d.	7.39
Cassell's Saturday Journal. 6s. 6d.	1.58
Catholic Times. 8s. 8d.	2.12
Chambers's Journal. 8s. 8d.	2.12
Chemical News. 20s. 3d.	4.93
Chemist and Druggist. 11s. 6d.	2.80
Christian. 7s. 3d.	1.77
Christian Age. 6s. 6d.	1.58
Christian Commonwealth. 8s. 8d.	2.12
Christian World. 8s. 8d.	2.12
Christian World Pulpit. 6s. 6d.	1.58
Church Bells. 6s. 6d.	1.58
Church Review. 6s. 6d.	1.58
Church Times. 8s. 8d. High Church.	2.12
Citizen. 8s. 8d.	2.12
Civilian. 15s. 2d.	3.70
Colliery Guardian. 30s. 4d.	7.39
Colonies and India. 17s. 4d.	4.22
Corn Trade Journal. 17s. 4d.	4.22
County Gentleman. 32s. 6d.	7.91
Court Circular. 26s.	6.33
Court Journal. 26s.	6.33
'Cyclist. 8s. 8d.	2.12
Dramatic Review. 8s. 8d.	2.12

Charing Cross, London, England.

English Newspapers with postage.

Dublin Nation.	17s. 4d.	£4.22
Economist.	42s. 10d.	10.44
Economist [and Investors' Monthly Manual].	57s. 6d.	14.00
Edinburgh Scotsman.	8s. 8d.	2.12
Electrical Review.	23s. 10d.	5.81
Electrician.	23s. 10d. Theoretical and applied.	5.81
Engineer.	Thin paper, 36s.	8.76
"	Thick paper, 40s. 6d.	9.86
Engineering.	Thin paper, 36s.	8.76
"	Thick paper, 40s. 6d.	9.86
Engineering Review.	6s. 6d.	1.58
England.	8s. 8d.	2.12
English Churchman.	8s. 8d.	2.12
English Mechanic.	13s. 3d.	3.22
Era.	34s. 8d. Theatrical and musical.	8.44
Family Churchman.	6s. 7d.	1.60
Family Herald.	6s. 9d.	1.64
Family Herald Supplement.	6s. 9d.	1.64
Field.	Thin paper, 41s. 6d.	10.10
"	Thin paper, 36s.	8.76
Figaro (including Christmas number).	6s. 8d.	1.62
Freeman.	9s.	2.19
Freemason.	17s. 4d.	4.22
Fun (and Almanac).	6s. 9d.	1.64
Funny Folks.	6s. 6d.	1.58
Garden.	23s. 10d. Illustrated and coloured plate.	5.80
Garden Work.	8s. 8d.	2.12
Gardeners' Chronicle.	17s. 4d.	4.22
Gardeners' Magazine.	13s. 6d.	3.28
Gardening.	6s. 6d.	1.58
Gas World.	19s. 6d.	4.75
Girls' Own Paper.	6s. 6d.	1.58
Glasgow Herald.	8s. 8d.	2.12
Graphic.	Including Christmas number, 36s. \$8.76. Thin paper, 31s. 7d. \$7.70. (Holiday number, 1s. 4d. extra.)	
Guardian.	30s. Liberal High Church.	7.31
Herapath's Railway Journal.	26s.	6.33
Illustrated London News.	Including Christmas number, 36s. 4d. \$8.84. Thin paper, 32s. \$7.80. (Summer number, 1s. 4d. extra.)	
Illustrated Medical News.	30s. 4d.	7.39
Illustrated Sporting and Dramatic News (inc. Christ. No.).	35s. 4d. \$8.61. Thin paper, 31s. \$7.55.	
Inquirer.	13s.	3.16
Investors' Guardian.	30s. 4d.	7.39
Iron.	32s. 6d. \$7.91. Thin paper, 30s. \$7.30.	
Jewish Chronicle.	13s.	3.16
Journal of Gas Lighting.	31s.	7.55
Journal of Horticulture, Cottage Gardener, and Country Gentleman.	17s. 4d.	4.22
Judy.	11s. 1d. (Including Almanac.)	2.70
Labour News.	6s. 6d.	1.58

B. F. Stevens, 4, Trafalgar Square,

English Newspapers with postage.

Ladies' Pictorial.	38s. 1d. (Christmas No. 1s. 4d. extra.)	£9.28
Lady, A Journal for Gentlewomen.	32s. 6d.	7.92
Lamp.	6s. 6d.	1.58
Lancet.	Thin paper, 34s. 8d. \$8.44. Thick paper, 41s. 2d. \$10.03. The leading journal of medical science.	
Land and Water.	34s. 8d. Journal of field sports.	8.44
Law Journal.	30s. 4d.	7.39
Law Times.	43s. 4d.	10.54
Leeds Mercury.	16s. 6d.	4.02
Life.	33s. 2d.	8.07
Light.	10s. 10d.	2.64
Literary Churchman (fortnightly).	9s. 9d.	2.37
Literary World.	6s. 6d.	1.58
Liverpool Mercury.	14s.	3.41
Live Stock Journal.	21s. 8d.	5.27
Lloyd's Weekly Newspaper.	8s. 8d.	2.12
Magnet.	19s. 6d. Agricultural.	4.75
Mail (three times a week).	39s.	9.50
Manchester Guardian.	9s.	2.20
Manchester Times.	9s.	2.20
Mark Lane Express.	17s. 4d. Agriculture.	4.22
Mechanical World.	8s. 8d.	2.12
Medical Press & Circular.	28s. 2d.	6.86
Methodist.	8s. 8d.	2.12
Mining Journal.	32s. 6d.	7.92
Modern Society.	6s. 6d.	1.58
Moonshine.	6s. 6d.	1.58
Musical Standard.	15s. 2d.	3.70
Musical World.	17s. 4d.	4.22
National Reformer.	10s. 10d.	2.64
Nature. Illustrated.	Special rate, 28s.	6.82
News of the World.	8s. 8d.	2.12
Nonconformist.	30s. 4d.	7.39
Notes and Queries.	20s. 7d. An organ for inter- change of knowledge among literary men.	5.01
Observer.	Issued on Sunday. 21s. 8d.	5.27
Pall Mall Budget.	Made up from the daily Pall Mall Gazette. 21s. 8d.	5.28
Patent Office, Official Journal.	23s. 4d.	5.69
Penny Illustrated Paper.	6s. 10d. (With Christ- mas No.)	1.65
People (The).	8s. 8d.	2.12
Pharmaceutical Journal.	21s. 8d.	5.27
Phonetic Journal.	6s. 6d.	1.58
Photographic News.	17s. 4d.	4.22
Pictorial World (including Christmas No.).	36s.	8.76
Post Magazine.	6s. 6d. Life and fire insurance topics.	1.58
Public Opinion.	13s.	3.16
Publishers' Circular (twice a month and Christmas No.).	8s. Lists of books during fortnight.	1.95
Punch.	15s. 6d., including Almanac.	3.77

Charing Cross, London, England,

English Newspapers with postage.

Queen. Thin paper, 39s.	\$9.50
" Thick paper, 44s.	10.72
Railway News. 30s. 10d.	7.50
Railway Times. 26s.	6.33
Referee. 6s. 6d. Sporting and dramatic.	1.58
Reporter. 30s. 4d. Public companies.	7.39
Rock. 8s. 8d. Evangelical.	2.12
St. James' Budget. 32s. 6d.	7.91
St. Stephens' Review. 32s. 6d.	7.91
Saturday Review. 30s. 4d.	7.39
School Board Chronicle. 17s. 4d.	4.22
Schoolmaster. 9s. 8d.	2.35
Scientific News. 17s. 4d.	4.22
Semaine Française. 10s. 10d.	2.64
Shipping Gazette and Lloyd's List. 30s. 4d.	7.39
Society. 6s. 6d.	1.58
Society of Arts' Journal. 30s. 4d.	7.39
Solicitors' Journal. 30s. 4d. without Reporter.	7.39
Solicitors' Journal and Reporter. 60s.	14.58
Spectator. 30s. 4d.	7.39
Sporting Times. 10s. 10d.	2.64
Stage. 13s.	3.16
Statist. 30s. 4d.	7.39
Sunday School Chronicle. 6s. 6d.	1.58
Sunday Words. 6s. 6d.	1.58
Tablet. 26s. Roman Catholic ecclesiastical news.	6.33
Temperance Record. 6s. 6d.	1.58
Timber. 17s. 6d.	4.26
Times, weekly edition. 13s.	3.16
Tit Bits. 6s. 6d.	1.58
Topical Times. 6s. 6d.	1.58
Truth. 32s. 6d. \$7.91; on thin paper, 30s. 4d. \$7.39. (Christmas No., 1s. 2d. ex.)	
Umpire. 6s. 6d.	1.58
United Service Gazette. 30s. 4d.	7.39
Vanity Fair. Caricature portraits. 32s. 6d.	7.91
Weekly Dispatch. 8s. 8d.	2.12
Weekly Freeman (Dublin). 10s. 10d.	2.64
Weekly Register and Catholic Standard. 17s. 4d.	4.22
Weekly Times. 8s. 8d.	2.12
Whitehall Review. 32s. 6d. Portraits of Aristocracy.	7.91
World (The). 30s. 4d. (Christmas No. 1s. 2d. extra).	7.39
Young Ladies' Journal. 6s. 8d.	1.62
Youth. 6s. 6d. (A paper for boys.)	1.58

Any other Newspaper can be supplied, and prices will be given on application.

* * See particulars of supply of NEW AND OLD ENGLISH BOOKS on last two pages.

B. F. Stevens, 4, Trafalgar Square,



ENGLISH MAGAZINES

With prices of annual subscription including Postage, in sterling and federal money at \$4.87 to the £.



LL the Year Round, monthly parts. 13s. 6d. including Christmas No.	\$3.28
Alpine Journal of the Alpine Club. 6s. 6d. Quarterly.	1.58
Analyst. Monthly. 6s.	1.46
Animal World. Monthly. 3s.	0.73
Annals of Botany. Quarterly. 21s.	5.12
Annals and Magazine of Natural History. Monthly. 37s. including 2 double Nos.	9.00
Anthropological Institute Journal. 21s.	5.12
Antiquary. Monthly. 14s.	3.41
Archæological Journal. Quarterly. 33s.	8.03
Archæological Review. Monthly. 21s.	5.12
Argosy. Monthly. 8s. 8d. (Christmas No. included.)	2.11
Art Journal. Monthly. 21s. \$5.12; on boards, 24s.	5.84
Artist, The. Monthly. 7s.	1.71
Asiatic Quarterly Review. 21s. 8d.	5.27
Assurance Magazine (Institute of Actuaries). Quarterly. 10s. 8d.	2.60
Atalanta. (Every Girl's Magazine.) 8s.	1.95
Baily's Mag. of Sports & Pastimes. Monthly. 20s.	4.87
Band of Hope. Monthly. 1s. Temperance tales for children, illustrated.	0.25
Band of Mercy Advocate. Monthly. 1s.	0.25
Bankers' Magazine. Monthly. 24s.	5.84
Baptist Magazine. Monthly. 7s.	1.71
Baptist Messenger. Monthly. 1s. 6d.	0.37
Belgravia. Monthly (including Christmas and Holiday Nos.), 17s.	4.14
Bible Treasury. Monthly. 3s. 6d.	0.85
Blackwood's Magazine. Monthly. 32s. 6d.	7.91
Board of Trade Journal. Monthly. 8s. —	1.95
Book Worm. Monthly. 7s. 6d.	1.82
Bookseller. Monthly (including Christmas). 6s. 6d. List of books published during the month, prices, literary news, publishers' advertisements, &c.	1.58
Bow Bells. Monthly. 8s.	1.95
Boys' Own Paper. Monthly. 8s.	1.95
Brain. Quarterly. 15s.	3.05
Braithwait's Retrospect of Medicine. Half-yearly. 13s. 8d.	3.32
British Chess Magazine. Monthly. 6s.	1.46
British and For. Evan. Review. Quarterly. 16s.	3.89
British Journal of Homœopathy. Quarterly. 13s.	3.16

Charing Cross, London, England.

English Magazines with postage.

British Trade Journal. <i>Monthly.</i> 10s.	\$2.43
British Workman. <i>Monthly.</i> 1s. 6d.	0.37
British Workwoman. <i>Monthly.</i> 1s. 6d.	0.37
Cassell's Magazine. <i>Monthly.</i> 9s.	2.20
Cabinet Maker. <i>Monthly.</i> 8s. 2d.	2.00
Catholic World. <i>Monthly.</i> 27s.	6.58
Chambers's Journal. <i>Monthly parts.</i> 9s. 6d.	2.31
Chatterbox. <i>Monthly.</i> 4s.	0.98
Chemical Review. <i>Monthly.</i> 12s.	2.92
Chemical Soc. Journal. <i>Monthly.</i> 33s.	8.03
Chess Monthly. 11s.	2.70
Child's Companion. <i>Monthly.</i> 1s. 8d.	0.41
Child's Own Magazine. <i>Monthly.</i> 1s.	0.25
Child's Pictorial. <i>Monthly.</i> 2s. 6d.	0.61
Children's Friend. <i>Monthly.</i> 1s. 6d.	0.37
China's Millions. <i>Monthly.</i> 1s. 6d.	0.37
Christian Treasury. 7s. 6d.	1.82
Christian World Pulpit. <i>Monthly.</i> 7s. 6d.	1.82
Church Builder. <i>Quarterly.</i> 1s. 4d.	0.33
Church Missionary Gleaner. <i>Monthly.</i> 1s. 6d.	0.37
Church Missionary Intelligencer. <i>Monthly.</i> 7s. 6d.	1.82
Church Quarterly. 24s.	5.84
Church Worker. <i>Monthly.</i> 1s. 6d.	0.37
Classical Review. <i>Monthly.</i> 11s.	2.68
Colburn's United Service Mag. <i>Monthly.</i> 14s. 6d.	3.53
Congregational Review. <i>Monthly.</i> 14s.	3.41
Contemporary Review. <i>Monthly.</i> Theological, literary, and social articles and reviews by high-class writers. <i>Special rate,</i> 30s.	7.30
Cornhill Magazine. <i>Monthly.</i> 8s. Illustrated.	1.95
Cottager and Artisan. <i>Monthly.</i> 1s. 6d.	0.37
Curtis's Botanical Magazine. <i>Monthly.</i> 43s. \$10.46. Plain, 31s. \$7.55. Coloured plates of new and rare plants.	
Decoration. 7s. 6d.	1.82
Dublin Journal of Medical Science. <i>Monthly.</i> 22s.	5.36
Dublin Review. <i>Quarterly.</i> 26s. Roman Catholic.	6.33
Edinburgh Medical Journal. <i>Monthly.</i> 26s.	6.33
Edinburgh Review, <i>Liberal.</i> <i>Quarterly.</i> 24s.	5.85
Educational Times. <i>Monthly.</i> 7s.	1.70
English Etchings. <i>Quarterly.</i> On boards, 15s. 10d.	3.86
English Historical Review. <i>Quarterly.</i> 21s. 8d.	5.27
English Illustrated Magazine. 8s.	1.96
Entomologist. <i>Monthly.</i> 6s. 6d.	1.58
Entomologist's Monthly Magazine. 6s. 6d.	1.58
Evangelical Christendom. <i>Monthly.</i> 7s.	1.70
Expositor. <i>Monthly.</i> 14s.	3.41
Family Friend. <i>Monthly.</i> 1s. 6d.	0.37
Family Herald. <i>Monthly parts.</i> 7s. 6d.	1.82
Fireside (The). <i>Monthly.</i> 8s.	1.95
Foreign Church Chronicle. <i>Quarterly.</i> 6s. 8d.	1.62
Fortnightly Review. <i>Monthly.</i> A monthly mag. of political and literary criticisms. <i>Special rate,</i> 30s.	7.30

B. F. Stevens, 4, Trafalgar Square,

English Magazines with postage.

Friendly Leaves. <i>Monthly.</i> 1s. 6d.	\$0.37
Friendly Visitor. <i>Monthly.</i> 1s. 6d.	0.37
Furniture Gazette. <i>Monthly.</i> 6s.	1.47
Genealogist. <i>Quarterly.</i> 10s. 8d.	2.60
Gentleman's Magazine. <i>Monthly,</i> and Christmas Number, 15s. 9d.	3.96
Geographical Society's Proceedings. <i>Monthly.</i> 20s.	4.87
Geological Magazine. <i>Monthly.</i> 19s. 6d.	4.75
Geological Soc. Quarterly Journal. <i>Quar.</i> 21s.	5.12
Girls' Own Paper. <i>Monthly.</i> 8s.	1.95
Glasgow Medical Journal. <i>Monthly.</i> 22s.	5.36
Good News for Young and Old. <i>Monthly.</i> 1s. 6d.	0.37
Good Words. <i>Monthly</i> (incl. Christmas). 8s. 6d. Novels, essays, and literature of a religious nature.	2.07
Hardwicke's Science Gossip. <i>Monthly.</i> 5s.	1.22
Home Friend. <i>Monthly.</i> 1s. 6d.	0.37
Homiletic Magazine. 14s.	3.41
Homilist. <i>Monthly.</i> 7s.	1.70
Homœopathic World. <i>Monthly.</i> 7s.	1.70
Horological Journal. <i>Monthly.</i> 4s.	0.98
Ibis. <i>Quar.</i> 25s. 4d. Coloured plates of ornithology.	6.17
Illustrated Missionary News. <i>Monthly.</i> 2s. 6d.	0.62
Illus. Naval & Military Magazine. <i>Monthly.</i> 34s.	8.28
Infant's Magazine. <i>Monthly.</i> 1s. 6d.	0.37
Iron and Steel Institute Journal. <i>Half-yearly.</i> 33s. 8d.	8.20
Israel's Watchman. <i>Monthly.</i> 3s.	0.73
Jewish Intelligence. <i>Monthly.</i> 1s. 6d.	0.37
Journal of Anatomy. <i>Quarterly.</i> 6s. a number and 3d. postage, or annual 22s. incl. postage.	5.36
Journal of Botany. <i>Monthly.</i> 13s. 6d.	3.30
Journal of Decorative Art. 8s. 6d.	2.08
Journal of Mental Science. <i>Quarterly.</i> 15s. 4d.	3.73
Journal of Philology. <i>Half-yearly.</i> 9s. 6d.	2.31
Journal of Physiology. 21s.	5.12
Journal of Soc. of Chemical Industry. <i>Monthly.</i> 30s.	7.30
Knowledge. Scientific. <i>Monthly.</i> 7s. 6d.	1.82
Ladies' Gazette of Fashion. <i>Monthly.</i> 9s.	2.20
Ladies' Magazine. 14s. 6d.	3.53
Lamp. <i>Monthly.</i> 7s. 6d.	1.82
Law Journal Reports. <i>Monthly.</i> 5s. or 10s. a number and postage.	
Law Magazine. <i>Quarterly.</i> 22s.	5.36
Law Quarterly Review. 11s.	2.68
Law Reports [of all the British Courts]; the four series, Common Law, Equity, Appellate, and Statutes, with the Weekly Notes, 92s. 6d. a-year including postage.	22.52
Law Student's Journal. <i>Monthly.</i> 7s.	1.70
Leisure Hour. Part, <i>nthly.</i> 8s. Illustrated.	1.95
Library Chronicle. <i>Monthly.</i> 8s.	1.95
Life of Faith. <i>Monthly.</i> 3s.	0.73
Linnæan Society's Transactions (Botany and Zoology). <i>Irregular.</i>	

Charing Cross, London, England.

English Magazines with postage.

Little Folks. <i>Monthly.</i> 7s. 6d.	\$1.82
Little Wideawake. 4s.	0.98
Local Preachers' Magazine. <i>Monthly.</i> 3s.	0.73
Local Preachers' Treasury, 5s.	1.23
London and Paris Ladies' Magazine of Fashion. <i>Monthly.</i> 13s.	3.16
Lond., Edin., and Dub. Philosophical Magazine. <i>Monthly.</i> (Two double Nos.) 37s. 4d.	9.09
London Quarterly Review. <i>Quarterly.</i> 17s. 4d.	4.22
London Society. <i>Monthly.</i> 14 Nos. a year, 17s. Fiction and other light reading, illustrated.	4.14
Longmans' Magazine. <i>Monthly.</i> 8s.	1.95
Lucifer. <i>Monthly.</i> 15s.	3.65
Lyceum (Dublin). <i>Monthly.</i> 6s.	1.47
Macmillan's Magazine. <i>Mthly.</i> Literary, political, and social subjects, fiction, poetry, &c. 14s. 6d.	3.53
Magazine of Art. <i>Monthly.</i> 14s. 6d.	3.53
Marine Engineer. <i>Monthly.</i> 7s. 6d.	1.82
Men and Women of the Day (on boards). 37s.	9.00
Messenger of Mathematics. <i>Monthly.</i> 12s. 6d.	3.04
Metropolitan Tabernacle Pulpit. <i>Monthly.</i> 7s.	1.70
Microscopical Science, Qurtly. Jour. of, 10s. 4d. a no.	2.51
Microscopical Society's Journal. <i>Bi-monthly.</i> 32s.	7.80
Midland Naturalist. <i>Monthly.</i> 7s.	1.70
Mind. <i>Quarterly.</i> 12s.	2.92
Mission Field. <i>Monthly.</i> 3s. Illustrated.	0.73
Missionary Herald. <i>Monthly.</i> 1s. 6d.	0.37
Month, and Catholic Review. <i>Monthly.</i> 27s.	6.57
Monthly Packet of Evening Readings, including Christmas number. 15s. 10d.	3.85
Mother's Help. <i>Monthly.</i> 1s. 6d.	0.37
Murray's Magazine. <i>Monthly.</i> 15s.	3.65
Musical Times. <i>Monthly.</i> 5s. 6d.	1.34
Myra's Journal of Dress. <i>Monthly.</i> Coloured plates of fashions, patterns, &c., and Christmas Number. 9s.	2.19
Nautical Magazine. <i>Monthly.</i> 14s.	3.41
Nineteenth Century. <i>Monthly.</i> Special rate, 30s.	7.30
Notes and Queries. <i>Monthly parts.</i> 20s. 8d.	5.03
Numismatic Chronicle. <i>Quarterly.</i> 21s.	5.11
Observatory. <i>Monthly.</i> 14s.	3.41
Old Jonathan. <i>Monthly.</i> 1s. 6d.	0.37
Onward. 1s. 6d.	0.37
Ophthalmic Review. <i>Monthly.</i> 13s.	3.16
Orchid Album. <i>Monthly.</i> 60s.	14.61
Our Darlings. 4s.	0.98
Parliamentary Papers. £12 12s. per annum. Exclusive of freight or postage.	61.32
Penny Post. <i>Monthly.</i> 1s. 6d.	0.37
Pharmaceutical Journal. <i>Monthly.</i> 21s.	5.12
Portfolio. <i>Monthly.</i> 33s. (on boards, 36s. \$8.76). Fine art subjects, with original etchings, edited by P. G. Hamerton.	8.03

B. F. Stevens, 4, Trafalgar Square,

English Magazines with postage.

Practitioner. <i>Monthly.</i> 20s.	\$4.87
Printers' Register. <i>Monthly.</i> 5s. 6d.	1.35
Printing Times and Lithographer. <i>Monthly.</i> 8s.	
Illustrated Technical and Fine Art Journal.	1.95
Private Schoolmaster. <i>Monthly.</i> 3s. 6d.	0.85
Prize. <i>Monthly.</i> 1s. 6d.	0.37
Quarterly Journal of Pure and Applied Mathematics. 15s. 6d.	3.77
Quarterly Review. 26s.	6.33
Quiver. <i>Monthly,</i> and Christmas No. 8s. 8d.	2.12
Railway Engineer. 27s.	6.58
Reliquary. <i>Quarterly.</i> 11s.	2.68
Reporters' Magazine. 5s.	1.23
Royal Agricul. Soc. of Eng. Journ. <i>Hf-yrly.</i> 13s.	3.16
Royal Asiatic Society Journal. <i>Irregular.</i>	
Royal Geographical Socy., Proceedings. <i>Monthly.</i> 20s.	4.87
Royal Society, Proceedings. <i>Irregular, varies.</i>	
Royal Unit. Serv. Instit. Journ. <i>Irregular, varies.</i>	
Sanitary Record. <i>Monthly.</i> 14s.	3.41
Scottish Review. <i>Quarterly.</i> 17s. 6d.	4.26
Season, The. <i>Monthly.</i> Fashions, &c. 14s.	3.41
" " without plates. 7s. 6d.	1.82
Sotheran's Price Current (of Books). <i>Monthly.</i> 7s.	0.85
Stationer. <i>Monthly.</i> 7s. 6d.	1.82
Statistical Society's Journal. <i>Quarterly.</i> 21s. 4d.	5.20
Sunday. <i>Monthly.</i> 4s.	0.68
Sunday at Home. <i>Monthly.</i> 7s. 6d. Illustrated.	1.82
Sunday Magazine. <i>Mthly.</i> and Christmas No. 8s. 8d.	2.11
Sunday School Teacher. <i>Monthly.</i> 3s.	0.73
Sunday School Times. <i>Monthly.</i> 4s.	0.68
Sunshine. <i>Monthly.</i> 1s. 6d.	0.37
Sword and Trowel. <i>Monthly.</i> 4s. Edited by C. H. Spurgeon.	0.98
Sylvia's Home Journal. <i>Monthly.</i> 8s. 8d.	2.12
Teacher's Storehouse and Treasury. <i>Monthly.</i> 1s. 6d.	0.37
Temple Bar. <i>Monthly.</i> 14s. 6d. Popular literature.	3.53
Theatre, The. <i>Monthly,</i> with Photograph. 14s.	3.41
Time. <i>Monthly.</i> 14s.	3.41
Times, Palmer's Index. <i>Quarterly.</i> 41s.	9.98
Tinsley's Magazine. <i>Monthly.</i> 7s. 6d.	1.83
Tract Magazine. <i>Monthly.</i> 1s. 6d.	0.37
United Presbyterian Magazine. <i>Monthly.</i> 5s.	1.22
Universal Review. 35s.	8.50
Veterinarian. <i>Monthly.</i> 20s.	4.87
Veterinary Journal. <i>Monthly.</i> 20s.	4.87
Welcome. 7s. 6d.	1.82
Wesleyan Methodist Magazine. <i>Monthly.</i> 8s.	1.95
Westminster Review. <i>Monthly.</i> 33s.	8.03
Woman's World. 14s. 6d.	3.53
Work and Leisure. <i>Monthly.</i> 4s.	0.98
World of Fashion. <i>Monthly.</i> 14s. Coloured plates.	3.41
Young England. 5s. 6d.	1.35

Charing Cross, London, England.

English Magazines with postage.

Young Ladies' Journal. *Monthly.* 13s. \$3.16
 Zoologist. *Monthly.* 14s. 8d. 3.57

Any other Newspaper or Magazine can be supplied, and prices will be given on application.

TRANSACTIONS OF THE LEARNED SOCIETIES, Annual Publications, Almanacs, Calendars, &c. &c., supplied on the same terms.

PUBLICATIONS OF PRINTING SOCIETIES (Early English Text, Chaucer, New Shakespere, Ballad, Index, New Sydenham, &c.) supplied at price of subscription and postage with ten per cent commission.



FRENCH PERIODICALS

With prices of annual subscription, including postage. Subscriptions for less than a year are liable to be charged at a slightly higher rate.



ANNALES de Chimie et de Physique. *Monthly.* 32s. \$7.80
 Annales d'Hygiène publique. *Bi-monthly.* 22s. 5.36
 Annales Industrielles. *Weekly.* 35s. 8.52
 Annales des Mines. *Bi-monthly.* 25s. 6.09
 Annales des Ponts et Chaussées. *Monthly.* 20s. 4.87
 Annales des Sciences Naturelles (Botanique). *Bi-monthly.* 28s. 6.82
 Annales des Sciences Naturelles (Zoologie et Paléontologie). 28s. 6.82
 Annales Télégraphiques. *Bi-monthly.* 14s. 6d. 3.54
 Archives Générales de Médecine. *Monthly.* 22s. 5.36
 Art (l'). *Fortnightly.* 45s. 10.96
 Artiste (l'). *Monthly.* 56s. 13.62
 Bibliographie de la France. *Weekly.* 22s. 5.36
 Bulletin Astronomique. *Monthly.* 18s. 6d. 4.52
 Bulletin de la Société Chimique de Paris. *Fortnightly.* 24s. 5.85
 Bulletin de la Soc. de Géographie. *Monthly.* 22s. 5.36
 Bulletin des Sciences Mathématiques et Astronomiques. *Monthly.* 18s. 4.40
 Caricature (la). *Weekly.* 21s. 5.12
 Comptes Rendus hebdomadaires des séances de l'Académie des Sciences. 30s. 7.30
 Electricité (l'). *Monthly.* 14s. 3d. 3.47

B. F. Stevens, 4, Trafalgar Square,

French Periodicals with postage.

Figaro (le). *Daily.* 75s. \$18.28
 Figaro. *Weekly.* 14s. 3.42
 France Illustré (la). *Weekly.* 24s. 5.85
 Galignani's Messenger. *Daily.* 80s. 19.48
 Gazette des Architectes. *Weekly.* 19s. 4.62
 Gazette des Beaux Arts. *Monthly.* 49s. 11.94
 Gazette Hebdomadaire de Médecine. 23s. 5.60
 Genie Civil (le). *Weekly.* 35s. 8.52
 Gil Blas. *Daily.* 57s. 6d. 14.00
 Illustration (l'). *Weekly.* 36s. 6d. 8.90
 Journal Amusant. *Weekly.* 19s. 4.63
 Journal d'Agriculture. *Weekly.* 20s. 4.87
 Journal d'Agriculture Pratique. *Weekly.* 18s. 6d. 4.50
 Journal des Débats. *Daily.* 75s. 18.27
 Journal des Economistes. *Monthly.* 35s. 8.55
 Journal de la Marine (Le Yacht). *Weekly.* 25s. 6.09
 Journal de Pharmacie et de Chimie. *Monthly.* 16s. 3.89
 Journal de Physique. *Monthly.* 13s. 6d. 3.28
 Journal des Sciences Militaires. *Monthly.* 40s. 9.73
 Livre (le). *Monthly.* 33s. 8.05
 Lumière Electrique (la). *Semi-weekly.* 50s. 12.18
 Magasin Pittoresque (le). *Monthly.* 11s. 6d. 2.81
 Mode Illustré (la). *Monthly.* 25s. 6.09
 Monde Comique (le). *Weekly.* 10s. 4d. 2.51
 Monde Illustré (le). *Weekly.* 23s. 5.60
 Moniteur de la Mode. 1re édition. *Weekly.* 32s. 7.80
 Moniteur de la Photographie. *Fortnightly.* 21s. 5.12
 Moniteur Scientifique. *Monthly.* 22s. 5.36
 Nature (la). *Weekly.* 27s. 6.09
 Nouvelle Revue. *Twice a month.* 50s. 12.18
 Paris Illustré. *Twice a Month.* 27s. 6.58
 Petit Journal pour rire. *Weekly.* 9s. 2.20
 Revue d'Artillerie. *Monthly.* 19s. 4.62
 Revue des Deux Mondes. *Twice a month.* 53s. 12.92
 Revue de Droit International. *Bi-monthly.* 16s. 3.89
 Revue et Gazette Musicale de Paris. *Weekly.* 30s. 7.31
 Revue générale de l'Architecture. *Bi-monthly.* 46s. 11.19
 Revue Historique. *Quarterly.* 30s. 7.31
 Revue Illustrée. *Twice a month.* 32s. 7.80
 Revue Internationale. *Monthly.* 36s. 8.77
 Revue Maritime et Coloniale. *Monthly.* 50s. 12.18
 Revue Militaire de l'Etranger. *Twice a Month.* 14s. 3.40
 Revue de la Mode. *Weekly.* 25s. 6d. 6.21
 Revue Mycologique. *Quarterly.* 13s. 6d. 3.30
 Revue Philosophique. *Monthly.* 29s. 6d. 7.18
 Revue Politique et Littéraire. *Weekly.* 31s. 7.56
 Revue Scientifique. *Monthly.* 31s. 7.56
 Siècle (le). *Daily.* 58s. 14.13
 Technologiste (le). *Weekly.* 25s. 6.09
 Tour du Monde (le). *Weekly.* 25s. 6.09
 Univers (l'). *Daily.* 57s. 13.89
 Vie Moderne (la). *Weekly.* 33s. 8.05
 Vie Parisienne (la). *Weekly.* 30s. 7.31

Charing Cross, London, England.

German Periodicals with postage.

GERMAN PERIODICALS

With prices of annual subscription, including postage. Subscriptions for less than a year are liable to be charged at a slightly higher rate.



ALLGEMEINE Zeitung (Augsburg). 8os.	\$19.48
Annalen der Chemie (Liebig's). Monthly. 27s. Supplements extra.	6.57
Annalen der Physik und Chemie. Monthly.	35s. 8.52
Archiv für Experimentelle Pathologie. Mhly. Price varies.	
Archiv für Pathologische Anatomie (Virchow). Monthly. 5os. 6d.	12.30
Bazar (der). 48 Nos. a year. 15s. 6d.	3.77
Bibliographie für Deutschland. 9s. 2d.	2.23
Botanische Zeitung. Weekly.	30s. 7.30
Civilingenieur (der). 8 Nos. a year. 32s.	7.79
Deutsche Rundschau. Monthly.	28s. 6.80
Fliegende Blätter. Weekly.	17s. 4d. 4.22
Gartenlaube. Monthly.	11s. 2.70
Globus. Illustrierte Zeitschrift. Weekly.	30s. 7.30
Hermes. Quarterly.	13s. 3.16
Historische Zeitschrift. Bi-monthly.	25s. 6.09
Illustrierte Welt (Die). Bi-monthly.	13s. 3.16
Illustrierte Zeitung. Weekly.	40s. 9.74
Jahresbericht in der gesammten Medicin. 39s. 6d.	9.61
Journal für Buchdruckerkunst. 48 Nos. a year. 15s.	3.65
Journal für Mathematik (Crelle). Four parts to a volume. 15s.	3.65
Journal für Praktische Chemie. 23s.	5.60
Kladderatsch. Weekly.	15s. 3.65
Kölnische Zeitung. Daily.	7os. 17.03
Kunst für Alle. Monthly.	19s. 4.63
Literarisches Centralblatt für Deutschland. Wkly.	39s. 9.50
Mathematische Annalen. Quarterly.	23s. 5.60
Mittheilungen aus dem Gebiete des Seewesens. 17s.	4.14
Mittheilungen aus Perthes geographischer Anstalt. Weekly.	27s. 6.58
Modenwelt (die). Fortnightly.	7s. 6d. 1.82
Polytechnisches Journal (Dingler's). Fortnly.	40s. 9.73
Preussische Jahrbucher. Monthly.	23s. 5.00
Schmid's Jahrbucher der Medicin. 12 parts a year. 37s.	9.00
Ueber Land und Meer. Weekly.	19s. 6d. 4.75
Volksbote (der). Monthly.	9s. 2.19
Zeitschrift für analytische Chemie (Fresenius). Quarterly.	17s. 4.15
Zeitschrift, neue, für Musik. Weekly.	15s. 3.65

Prices of other English, French, German, Italian, Spanish, or other Periodicals will be supplied on application.

B. F. Stevens, 4, Trafalgar Square,
Charing Cross, London, England.



EVERY READER HIS OWN IMPORTER OF
ENGLISH BOOKS AT ENGLISH PRICES AT
TWENTY-FIVE CENTS TO THE SHILLING.

B. F. STEVENS'S American Library and Literary Agency was established in London in 1864 for the supply of European books to Public Libraries and private collectors in the United States. The facilities and economies offered by this agency to book buyers in America include:—

Prompt execution of orders. All books are despatched by early mail or steamer.

NEW BOOKS are charged at trade prices, which are usually twenty-five per cent off the price of publication.

OLD OR SECOND-HAND BOOKS are charged at lowest nett prices.

Commission of ten per cent on trade and nett prices.

Book postage to America is only one halfpenny for every two ounces up to four pounds weight.

Small quantities of books may be included in B. F. Stevens's weekly shipments to his New York agents, each package being charged with its proportion of freight, expenses and clearance at the Custom house, exclusive of duty, thus making the cost of transit very moderate. Larger shipments are consigned as the buyer instructs.

The discount off publication price is about equivalent to the cost of freight or postage and commission; hence in making purchases of new books it is safe to estimate that the books would be received at a cost of 25 cents to the shilling (publication price) exclusive of duty, if any.

Priced lists of current publications, with publishers announcements and literary notices, are printed in the *Publishers' Circular*, issued fortnightly, and in the *Bookseller*, monthly. Special attention is paid to forwarding catalogues of English and Continental publishers and booksellers when desired.

Superior Library Binding can be done in half levant morocco in a few days, and costs considerably less than in the United States.

The United States duty of twenty-five per cent is taxed on the nett prices of books printed within twenty years. All older books are duty free.

Public Libraries, Colleges, Academies, and other incorporated institutions are entitled to make all their importations free of duty.

47-M-64

CHEMICALS.

This Set is adequate for the performance of most of the Experiments in Text Books on Chemistry.

PRICE \$7.50.

- | | |
|--------------------|-------------------------|
| Muriatic Acid. | Potassium Ferrocyanide. |
| Nitric " " | Silver Nitrate. |
| Oxalic " " | Sodium. Carbonate. |
| Sulphuric " " | " Sulphate. |
| Tartaric " " | Strontium Chloride. |
| Ammonium Chloride. | " Nitrate. |
| " Nitrate. | Sulphur. |
| Sulphide. | Saltpetre. |
| Ammonia Aqua. | Bone Black. |
| Alcohol. | Fluor Spar. |
| Antimony. | Calcined Magnesia. |
| Arsenious Acid. | Caustic Potash. |
| Barium Chloride. | Platinum Wire. |
| " Nitrate. | Granulated Zinc. |
| Borax. | Magnesium Ribbon. |
| Calcium Sulphate. | |
| | Chlorate. |
| | Bi-Chromate. |

1889. NEW PRICE LIST

ALL PREVIOUS LISTS SUPERSEDED.

Terms, 30 days, thus giving you time to Examine Goods, which if not satisfactory, can be returned at my expense.

Prices Subject to Change without Notice.

W. A. OLMSTED,

182 WABASH AVENUE,
CHICAGO.

ESTABLISHED,

1878.

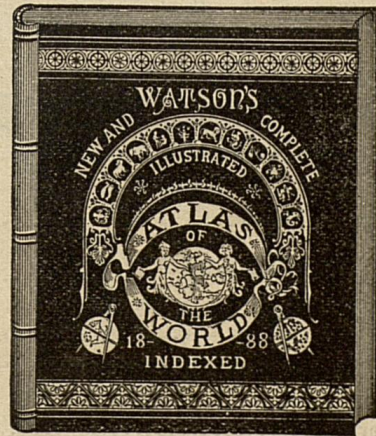

ATLAS OF THE WORLD, WATSON'S, - \$2.50
UNIVERSAL FAMILY ATLAS, CRAM'S 3.75

BROOMS.

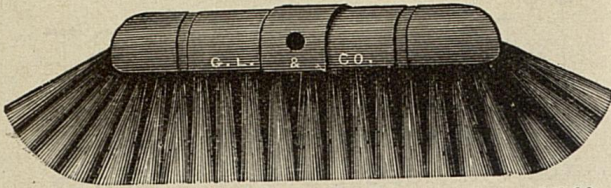

No. 4, 12 inch, all Russia Bristles and handles	\$2 00
" 6, 14 " " " "	3 50
" 8, 16 " " " "	4 00
" 14, 14 " Gray Bristles	1 25
" 16, 16 " " "	1 50

BELLS.

No. 52, Call Bell, Pure Bell Metal	50
" 62, " " "	75
" 31, " " "	1 00
" 32, " " "	1 25
" 95, " " "	1 50
" 6, Hand Bell, " "	1 25
" 10, " " "	3 19
" 12, " " "	4 81
" 6, " Common Metal	85
" 10, " " "	2 25
" 12, " " "	3 00
Electric	1 25

BASKETS.

Rattan, 8 inch, Fancy	60
" 9 " " "	65
" 8 " Closewove	70
" 9 " " "	75
Willow, 11 " "	50
" 13 " " "	60

CRAYONS.

White, per gross	10
" " 24 gross case	2 16
" " 50 " "	4 20
" " 100 " "	8 00

CRAYONS.—Cont'd.

Enameled, pink, per gross	\$ 12
" 50 gross case	5 00
Dustless, per gross	3 00
Alpha, per gross	50
Standard, per 100	30
Assorted colors, per gross	1 00
Assorted.....per box, 2 doz.	25
Pastels, per box, 18 shades	15
Scarlet, per doz	15
Blue, per doz	15
Yellow, per doz	15
Conte Charcoal, box	25

CLOCKS.—WARRANTED.

Eight Day, Drop Octagon Time, 12 inch dial	6 00
Eight Day, Regulator, 31 inches	7 00

CLUBS—INDIAN, MAPLE.

2lb, per pair	60
3lb, " "	80
4lb, " "	1 00

COUNTERS—FORM AND COLOR.

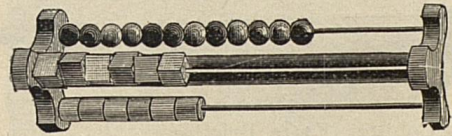

No. 1	25
No. 2	15

DICTIONARIES.

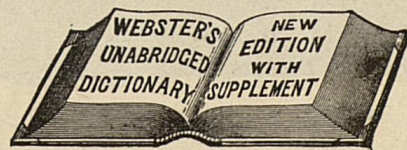

Webster's Unabridged, latest	8 50
" " " indexed	9 00

DICTIONARIES.—Cont'd.

Webster's National Pictorial.....	\$5 00
“ Common School.....	75
Worcester's Indexed.....	9 00
Lippincott's Biographical.....	8 00
Webster's Condensed.....	1 80
“ Academic.....	1 50

DICTIONARY HOLDERS.



Brass Wire, Tilting Top.....	5 00
White “ “ “.....	3 00
“ “ level “.....	2 50
No. 19, adjustable on castors like cut.....	5 00

DUSTERS.



No. 1, Counter, Extra Bristles.....	30
“ 2, “ “.....	40
“ 3, “ “.....	50
Turkey Feather Dusters, 10 inch.....	35
“ “ “ 12 “.....	45
“ “ “ 14 “.....	50
Ostrich Feather Dusters, No. 5.....	3 50

DUMB BELLS (MAPLE).

Weight each $\frac{1}{2}$ to $\frac{3}{4}$ lb,	1 lb,	2 lb,	3 lb,	4 lb.
Price per pair, 30c.	40c.	50c.	60c.	75c.
Iron, per pound.....	05			

ERASERS.

Novelty, price per doz..	\$1 50
National “	1 50
Andrews' wool, per doz.....	1 80
Carpet, per doz.....	1 80
Boston “	4 00

ENCYCLOPÆDIAS.

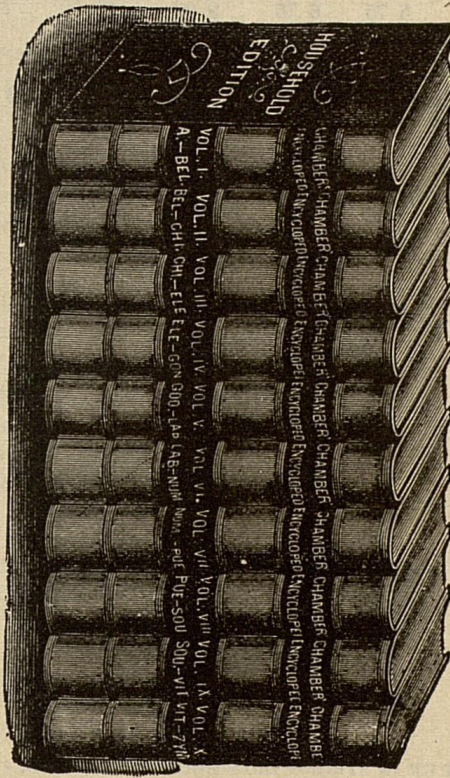

Chamber's, 10 vols., sheep.....	\$15 00
“ 10 “ cloth.....	12 00
Zell's condensed, 1 vol., sheep.....	6 50
Peoples', 3 vols., sheep.....	16 00
Young Folks' Persons and Places.....	2 00
“ Common Things.....	2 00

GEOLOGICAL SPECIMENS.

60 Pieces, in three trays, in case.....\$15 00
 60 Pieces, smaller, no case..... 6 00

GONGS.

6 inch	7 inch	8 inch	10 inch	12 inch	15 inch
\$4 30	5 75	6 75	9 00	15 00	28 00

GAZETTEERS.

Lippincott's, sheep.....\$ 8 00

HEKTOGRAPHS.

Note	Letter	Cap
\$ 2 00	3 50	5 00

BEST SCHOOL INK.

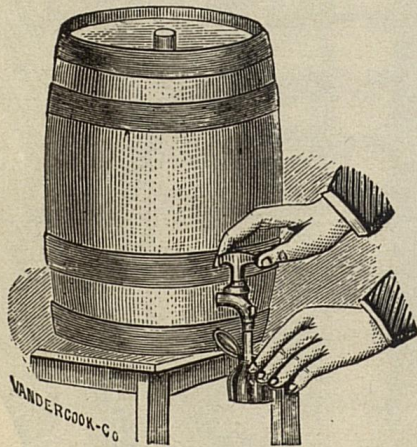

PUT UP IN STRONG IRON HOOP KEGS WITH FAUCET.

3 Gallon Kegs.....	\$ 2 25
5 " "	3 50
10 " "	6 50
20 " Barrel.....	12 00
40 " "	21 00

INK WELLS

Common, Complete. Doz.....	\$ 1 00
Glasses "	35
Air Tight, Gifford's "	2 00

MONEY (TOY.)

100 Dollar Pieces.....	\$ 20
" Half Dollar Pieces.....	15
" Quarter Dollar Pieces.....	12
" Ten Cent "	10
" Five " "	10
" Two " "	10
" One " "	10
Assorted Set in Tray with cover.....	25
Currency, 15 bills, per sheet.....	20

MICROSCOPES.

No. 514 A. Power 80 to 375 Diameters.....	\$32 50
" 500 Magnifying Power from 50 to 125 Diameters... ..	10 00
" 501. Same as 500 with Achromatic Doub- let.....	12 00
Household. 20 to 80 Diameters.....	5 00
Microscope Objects. Doz.....	90

MAGNETS.

3 inch	4 inch	6 inch	8 inch	10 inch	12 inch
15	18	40	1 00	1 50	3 00

MEASURES.

Liquid, 5 Pieces.....	70
Dry "	80

PENCILS (LEAD.)

Prang's Drawing, per gross	\$ 3 00
Olmsted's " "	3 00
Faber's No. 400 with Rubber, per gross.....	1 75
Faber's Telephone "	1 25
Faber's F "	1 00

PENCILS (SLATE.)

No. 7 German Pointed. Per 100.....	\$ 15
“ 7 “ Union, Pointed. Per 100.....	25
“ 7 “ Gold, „ „	35
“ 940, Cedar Plain, per gross.....	1 25
“ 60 Cedar Polished “	1 25

PENS.

No. 404, Gillott's, per gross.....	50
“ 303 “ “	90
“ 604 “ “	70

PORTRAITS

Longfellow.....	\$1 00.	In frame with glass	\$ 2 75
Bryant.....	1 00	“ “	2 75
Emerson.....	1 00	“ “	2 75
Nath'l Hawthorne	1 00	“ “	2 75
A. D. Mayo.....	1 00	“ “	2 75
John Eaton.....	1 00	“ “	2 75
George Peabody	1 00	“ “	2 75
D. N. Lowell... ..	1 00	“ “	2 75
O. W. Holmes..	1 00	“ “	2 75
John D. Philbrick	1 00	“ “	2 75
Frederick Froebel	1 00	“ “	2 75

PAPER.

Fools Cap, per ream 10lb, 12lb, 14lb, @ 17c. per lb	
Letter “ “ “ “ “ 17c. “	
Legal Cap “ “ “ “ “ 17c. “	
Note “ 5lb, 6lb, “ “ 17c. “	
Examination, with Printed Heading, pr ream	\$1 80
“ Plain “	1 50
Exercise, 4 space, Manilla “	50
“ 2 space “	50
“ 4 space, White “	60
“ 2 space “	60
“ Per Tablet.....	05
Botany paper per doz. sheets.....	10
Drawing paper, Boston white, 22x28, pr sheet	04
Drawing paper, extra Manilla, 6x9, pr 100 “	10
“ “ “ 8x11 “ “	15
Blotters, per 100	30

FORRESTER PENCIL SHARPENER.

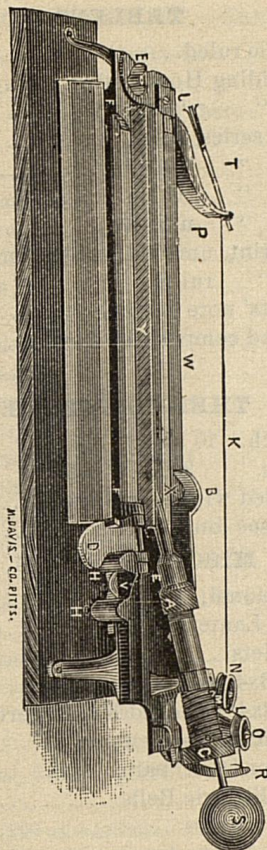

For Lead and Slate Pencils	\$ 8 00
New Files.....	60
New Cords.....	10
Pencil Sharpeners, Faber's.....	10

REGISTERS.

No. 1.	No. 2.	No. 3.	No. 4.	No. 5.
50c.	\$1.00.	\$1.25.	\$1.75.	\$2.00.

RULERS.

Softwood, per doz.....	\$ 07
Hardwood, Metric Scale, per doz.....	20
Blackboard, 36 inch hardwood, ea.....	20
“ 24 “ “ “	15

TABLETS.

261, quadrille ruled.....	\$	05
272, Red Riding Hood, ruled.....		05
277, " " " ".....		10
2211, Signal series, ruled.....		05
2212, " " unruled.....		05
2215, " " ruled.....		05
2216, " " unruled.....		05
1643, Foot print, unruled and perforated....		05
1644, " " ruled " ".....		05
2217, Students' note books.....		05
1830, 10 leaved composition books.....		05
1836, 28 " " " ".....		10

THERMOMETERS.

7 inch. 8 inch. 10 inch. 12 inch.		
10c. 15c. 20c. 25c.		
Best, graduated with special care.....	\$	1 00
Standard, to see long distances.....		3 00

MISCELLANEOUS.

Apples, Fractional.....	\$	1 00
Astronomical Lanterns.....		4 50
Addition Tablets.....		3 00
Blackboards 3x4, music lines.....		2 50
" 3x4, Checked Kindergarten.....		3 50
Book Scientific Amusements.....		75
Book Racks for Desk, pair.....		50
Batteries for Electric Bells.....		1 25
Bands, Rubber, gross.....		15
" " Home Assortment.....		10
" " $\frac{1}{4}$ lb, assorted.....		65
Balls, Foot.....		1 50
" " Rugby.....		4 00
Charts, Color.....		2 00
" Music Primary.....		1 25
" " Normal, 1st series.....		10 00
" " " 2d series.....		10 00
" Blank Manilla for Making Reading Charts.....		1 00

MISCELLANEOUS.—Cont'd.

Charts, Geographical Definitions.....	\$3	50
Chart, Geological.....	7	00
Constellations and how to find them.....	1	25
Clock Dials.....		50
Class Books.....		30
Compasses, Pencil.....		15
Cones, Dissected.....	1	00
Clay for Modeling, per lb.....		03
Chamois Skins.....		15
" " Smaller.....		10
Dissecting Knives.....		75
Dissecting Needles.....		15
Dissecting Scissors.....	1	50
Dissecting Forceps.....		15
Drawing Instruments, 10 pieces.....		75
Dividers, 6 inch.....		25
Drawing Book, slate....		10
Desk Spindles for papers.....		05
Diplomas.....	10c. to	1 00
Dividers, Blackboard for School Crayons....		1 00
Door Scrapers.....		09
Door Mats, Cocoa, 22x36.....		1 50
" " Wire ".....		4 00
" " " 18x30.....		3 00
" " " 16x24.....		2 50
Door Numbers, 3 inch, plated.....		15
Easels, best.....		2 00
Experiments, 200 chemical.....		10
Fasteners, McGill, No. 2, per 100.....		25
" " " 3 ".....		30
Grube's Method.....		30
Globes, 6 inch wire stand.....		25
Hooks, Wardrobe, extra heavy. per doz.....		30
Ink Vents.....		20
Ink Cans, glass, for filling wells.....		50
Ink Stands, Teachers, Desk.....		12
Kindergarten Songs and Games.....		2 00
" " ".....		90

MISCELLANEOUS.—Cont'd.

Kindergarten Slates, ruled.....	\$ 15
“ “ checked.....	20
“ Tables, 3 feet long 20 in. high..	3 00
“ “ 6 ft x 2½ ft.....	6 50
“ chairs, 12 in. high, per doz.....	5 50
“ “ 14 “ “.....	6 50
Letters, word making, per box.....	10
Map Drawing Sheets.....	05
Markers for Ruling Slates.....	75
Magnifiers.....	35
“ Botanist's.....	50
Manual Calisthenics.....	20
“ “ Watson's, 144 pages.....	1 20
Mucilage and brush.....	07
Medals.....	40
Maps, U. S., dissected.....	50
Maps, any state, “.....	50
Maps, U. S., Relief.....	40
Meter sticks.....	30
Mottoes, set.....	30
Polygraph, for Drawing and Designing.....	25
Prisms, 4 inch.....	35
Pencils, six assorted colors in box.....	12
Pens, for ruling.....	15
Pens, for making charts.....	12
Penholders, per gross.....	35
Report Cards, per 100.....	35
Record Examinations.....	50
Rubber Erasers, per lb, 80 pieces, wedge shape	1 25
Rings for Calisthenics, pair.....	50
School Government, set.....	90
Schedules, quire.....	40
Schedules, Wrappers, doz.....	25
Scales and Weights, ¼ oz. to 25 lbs.....	3 00
Sentence Builders, small.....	40
“ “ Teachers.....	3 00
Sand Glasses.....	20
Sponges, per oz.....	12
Wax, Sealing, per stick.....	08
Wire for Electric Bells, lb.....	40
Wands, 4 ft. maple, each.....	25

Outlines in Natural Science.....	.10
Manikins.....	3.00
Silent Teacher.....	.50
Drawing Models, 4 inch Sphere.....	.40
“ “ 4 “ Cone.....	.40
“ “ 4 “ Cube.....	.40
“ “ 4 “ Pyramid.....	.30
“ “ 4 “ Cylinder.....	.30
Drawing Cards (8 in set), each 8x5½.....	.10
Superintendent's School Ledger. Will last 15 years for School of 600 pupils.....	10.00
Bailey's Cosmosphere, diam. 30 inches.....	100.00
Dissected Skull, 14 parts.....	25.00
Historical Map, U. S., in case (60x64).....	13.50
Microscope with society screw, takes any objective, ¼ inch and 1 inch furnished, 80 to 375 diameters.....	25.00
Esterbrook's School Pens, No. 444, per gross,	.50
Holmes' new Drawing Books, 3 numbers,..... each	.25
Holmes' Wall Charts, for drawing, 10 num- bers..... per set, \$10.00. Single	1.25
Drawing Pencils.....gross	2.40
O. N. C. Crayon, enameled . . .per gross	.10
Electric Motor.....	2.50
Historical Atlas (31 maps).....	.75
Elements of Static Electricity.....	1.50
Contains full description of Toepler Holz ma- chines and their mode of operating.	
Pointers, Tarr's, per doz	2.00

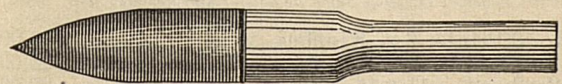

WITH RUBBER TIP ATTACHMENTS.

Pointers, plain hickory.....	1.00
Pointers, with rubber pencil tips.....	1.25
Flash Ink Wells, per doz.	1.50

THE EDISON MIMEOGRAPH.

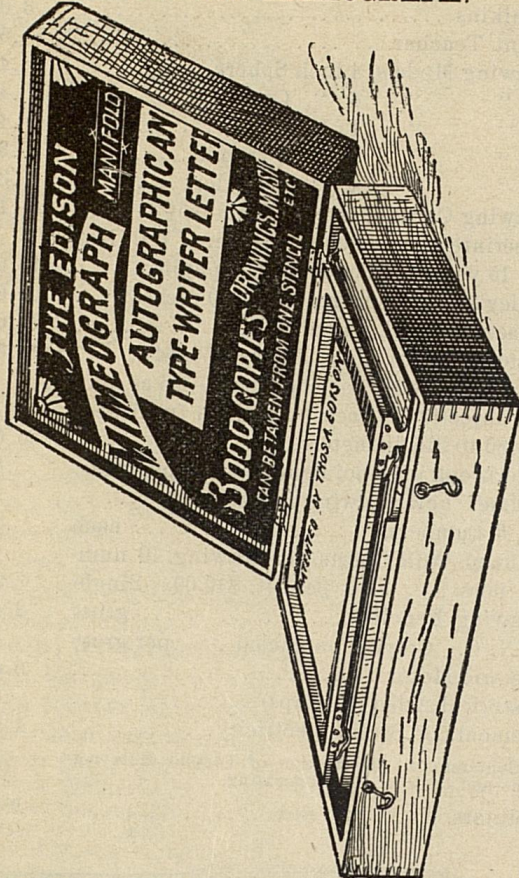

No. 0 Prints	6 x 8 inches.	\$12.00
" 1 "	9 x 12 "	15.00
" 2 "	11 x 16 "	20.00

EXTRA SUPPLIES.

Stencil Paper, for No. 0, per quire60
" " " " 1, "75
" " " " 2, "	1.00
Black Ink, per 6 oz. Tube60
Stylus15

SUCCESS AT LAST.

WE CAN NOW OFFER YOU

DUSTLESS CRAYONS.

NO GRIT. NO SCRATCHING. NO DUST. ERASES EASILY:

PRICE PER DOZEN, 25 CENTS. PER GROSS, \$3.00.

There are many so called **DUSTLESS CRAYONS** in the Market but these are **ABSOLUTELY DUSTLESS.**

One gross will outlast many gross of ordinary Crayons. Common Crayons cannot be used on the same board with the **Dustless**, as **Dustless Crayons** leave the surface too smooth for ordinary **Crayons**, whereas the board never gets too smooth for the **Dustless Crayons.**

Should you ever desire to use the ordinary crayons again, you can remove the smooth surface on the blackboard with a small quantity of ammonia, but you will never want to see the dusty Crayon again, as relief from **dust** can only be obtained by using our **Dustless Crayons.**

NOW READY!

NORTH AMERICA

SIZE, 52 by 43 inches. Scale, 113 miles to an inch.

In the preparation of this Map, which comprises the entire Continent of North America, and extends to the farthest known Northern Regions (Greely), all recent available material and information has been utilized. Within British Territory extensive compilations have been rendered necessary, as the result of Government Exploration, Railway and other Surveys. For the selection of names in the United States, the Government Census Tables, 1880, have been used, and all places of significance inserted. An Inset Map gives, on an enlarged scale, the Atlantic States between Washington and Boston. Mexico represents, so far as the scale would admit, the many modifications in topography which recent years have made known.

Throughout the Map, Railway connection between all places of importance is distinctly marked. The engraving has been carried out by experienced hands, and special attention has been given to the printing and coloring, in order to secure the best results.

On Muslin, Common Rollers	\$5.00
On Spring Roller, and enclosed in our new five ply birch veneer case	6.50

47-M-64

COLLINS' STUDENTS' REFERENCE BIBLES.
(WITH SCRIPTURE INDEX, TABLES, AND MAPS.)

PEARL TYPE.

- No. 528 S I. French Morocco, Divinity circuit \$1.10
- No. 552. Extra Levant, Divinity circuit, calf lined to edge, silk sewed, round corners 4.00

Catalogue page 9.

RUBY TYPE.

- No. 476 S I. French Morocco, Divinity circuit, round corners \$1.60
- No. 491. Extra Levant, calf lined to edge, silk sewed, round corners 4.50

By far the best value in a ruby Bible at present in the market. Catalogue page 10.

COLLINS' BOURGEOIS TYPE REFERENCE BIBLE.

- No. 368. Levant Morocco, Divinity circuit, calf lined, silk sewed \$7.00
- No. 369. Extra Levant, Divinity circuit, kid lined, silk sewed 9.00

The largest type reference Bible of its size. Catalogue page 12.

COLLINS' WIDE MARGIN BIBLE FOR MSS. NOTES.

- No. 399. Levant Morocco, Divinity circuit, red under gold edge, linen paper, calf lined, silk sewed. Catalogue page 13. \$9.00

A. D. MACLACHLAN,

COLLINS' BIBLE WAREHOUSE, 214 CLARENDON STREET, BOSTON, MASS.

[1889]

PRICE = LIST

OF THE

"COLLINS'" TEACHERS' AND REFERENCE BIBLES.

✱

A. D. MACLACHLAN,

COLLINS' BIBLE WAREHOUSE, 214 CLARENDON ST., BOSTON, MASS.

LONDON AND GLASGOW: WM. COLLINS' SONS & CO., LTD.

INDEX.

	PAGES.
CONTENTS OF COLLINS' TEACHERS' BIBLES	2- 3
TEACHERS' BIBLES	4- 8
STUDENTS' PORTABLE REFERENCE SERIES	9-12
COLLINS' WIDE MARGIN BIBLE FOR MSS. NOTES	13
BIBLES (Text Only)	15
REFERENCE BIBLES	16

PRICE = LIST

OF THE

"COLLINS'" TEACHERS' AND REFERENCE BIBLES.

A. D. MACLACHLAN,

COLLINS' BIBLE WAREHOUSE, 214 CLARENDON ST., BOSTON, MASS.

LONDON AND GLASGOW: WM. COLLINS' SONS & CO., LTD.

AIDS TO THE STUDENT OF SCRIPTURE

CONTAINED IN

COLLINS' TEACHERS' REFERENCE BIBLES.

THESE helps have been arranged with such care and fulness in detail that it is confidently believed the student of Scripture will find within the compass of his Bible every reference needed for its careful study. The best authorities on special parts and topics of the Bible have been called upon, and have contributed to form the most complete set of teachers' helps now offered. An enumeration of the entire contents is here impossible. A summary is given below, but the value and extent of the aids can only be justly estimated by their use. It will then be found that they give accurate and recent information on a most comprehensive range of biblical subjects.

Some of the more interesting and important articles are :

On HEBREW POETRY, by REV. T. K. CHEYNE, D. D., Oriel Professor of Interpretation, Oxford.
On MUSIC, DR. J. L. STAINER, M. A., Organist of St. Paul's Cathedral.
BIBLE ETHNOLOGY, REV. A. H. SAYCE, M. A., Oxford.
PLANTS, S. J. HOOKER, K. C. S. I., C. B., F. R. S.
ANIMAL CREATION, DR. TRISTRAM, LL. D., F. R. S.
JEWISH SECTS AND BIBLE CHRONOLOGY, REV. T. G. GREEN, D. D.

2

SUMMARY OF CONTENTS

of the Aids to the Student of the Holy Bible contained in Collins' Teachers' Bibles.

Concordance of Bible Words, with their Context (over 40,000 references).
Index to the Persons, Places, and Subjects of the Bible (16,000 references).
Dictionary of Proper Names, with their meanings and a revised pronunciation; by REV. T. K. CHEYNE, D. D.
The Symbolical Language of Scripture.
Glossary of Bible Words (with a table to find each psalm by its first line). REV. J. R. LUMBY, D. D.
Parables and Miracles in the Old Testament. Rivers of Scripture.
Miracles and Parables of Jesus. Bible Calendar.
Prophecies relating to Jesus Christ. Coins, Weights, Measures.
Prayers of Jesus. Trees, Shrubs, Herbs, Flowers.
Analysis of Sermon on the Mount. Birds, Reptiles.
Notes on the Lord's Prayer. Music, Poetry.
Physical Features of Palestine. Historical Epitome.
Remarkable Mountains and Hills mentioned in the Bible. Jewish Sects and Orders, etc., etc.

And COPYRIGHT MAPS from recent Surveys INDEXED on a new plan.
The whole revised and brought down to date.

SPECIMEN OF PAGE.

PEARL, 16mo. Size, 4 x 5 $\frac{1}{4}$ x 1 $\frac{3}{8}$.

<p><i>Of the labourers in the vineyard.</i> MATTHEW, 21. <i>Christ's entry into Jerusalem.</i></p> <p>went out early in the morning to hire labourers into his vineyard.</p> <p>2 And when he had agreed with the labourers for a penny a day, he sent them into his vineyard.</p> <p>3 And he went out about the third hour, and saw others standing idle in the marketplace.</p> <p>4 And said unto them, Go ye also into the vineyard, and whatsoever is right I will give you. And they went their way.</p> <p>5 Again he went out about the sixth and ninth hour, and did likewise.</p> <p>6 And about the eleventh hour he went out, and found others standing idle, and said unto them, Why stand ye here all the day idle?</p> <p>7 They say unto him, Because no man hath hired us. He saith unto them, Go</p>	<p>A. D. 53. CHAP. 20.</p> <p>The Roman penny is the eighth part of an ounce, which after five shillings the ounce is sevenpence halfpenny.</p> <p>17th Ed. 1784-1816 S. S. LAYTON continued one hour.</p>	<p>drink indeed of my cup, and be baptized with the baptism that I am baptized with; but to sit on my right hand, and on my left, is not mine to give, but it shall be given to them for whom it is prepared of my Father.</p> <p>28 And when the ten heard it, they were moved with indignation against the two brethren.</p> <p>29 But Jesus called them unto him, and said, Ye know that the princes of the Gentiles exercise dominion over them, and they that are great exercise authority upon them.</p> <p>30 But Jesus called them unto him, and said, Ye know that the princes of the Gentiles exercise dominion over them, and they that are great exercise authority upon them.</p> <p>31 But it shall not be so among you: but whosoever will be great among you, let him be your minister.</p> <p>32 And whosoever will be chief among you, let him be your servant.</p> <p>33 Even as the Son of man came not</p>
---	--	---

STYLES AND PRICES.

- No. 603. French Morocco, Divinity circuit, round corners, silk headband, lettered side and back, gilt edge \$1.65
- No. 610 Extra Levant Morocco, Divinity circuit, calf lined to edge, silk sewed, round corners 4.50

SPECIMEN OF PAGE.

RUBY, small 16mo. Size, 4 x 5 $\frac{7}{8}$ x 1 $\frac{5}{8}$.

<p><i>Christ sent to the Gentiles.</i></p> <p>thee by the way that thou shouldst go.</p> <p>18 O that thou hadst hearkened to my commandments! then had thy peace been as a river, and thy righteousness as the waves of the sea.</p> <p>19 Thy seed also had been as the sand, and the offspring of thy bowels like the gravel thereof; his name should not have been cut off nor destroyed from before me.</p> <p>20 ¶ Go ye forth of Babylon, flee ye from the Chaldeans, with a voice of singing declare ye, tell this, utter it even to the end of the earth; say ye, The LORD hath redeemed his</p>	<p>ISALAH, XLIX.</p> <p>B. C. 712.</p> <p>CHAP. 48.</p> <p>18th Ed. 1784-1816 S. S. LAYTON continued one hour.</p>	<p><i>The restoration of the church.</i></p> <p>and arise, princes also shall worship, because of the LORD that is faithful, and the Holy One of Israel, and he shall choose thee.</p> <p>8 Thus saith the LORD, In an acceptable time have I heard thee, and in a day of salvation have I helped thee; and I will preserve thee, and give thee for a covenant of the people, to establish the earth, to cause to inherit the desolate heritages.</p> <p>9 That thou mayest say to the prisoners, Go forth; to them that are in darkness, Show yourselves. They shall feed in the ways, and their pastures shall be in all high</p>
---	--	---

STYLES AND PRICES.

- No. 496. French Morocco, Divinity circuit, protecting edge, round corners, silk headband, lettered side and back \$1.88
- No. 499. Extra Levant Morocco, Divinity circuit, calf lined to edge, silk sewed, round corners 5.25

SPECIMEN OF PAGE.

RUBY, large 16mo. Size, 4 1/2 x 6 5/8 x 1 3/4.

<i>Conversion of Saul.</i>	ACTS, IX.	<i>He boldly preaches Christ.</i>
the slaughter; and like a lamb dumb before his shearer, so opened he not his mouth.	A. D. 34. CHAP. 8. v. 14, 17, 18, 25. 19: 1, 23. Col. 2: 17. 1 Pet. 1: 12, 13. 1 Cor. 10: 47. 1 Cor. 12: 13. 1 Cor. 15: 14. 1 Cor. 15: 18. 1 Cor. 15: 19. 1 Cor. 15: 20. 1 Cor. 15: 21. 1 Cor. 15: 22. 1 Cor. 15: 23. 1 Cor. 15: 24. 1 Cor. 15: 25. 1 Cor. 15: 26. 1 Cor. 15: 27. 1 Cor. 15: 28. 1 Cor. 15: 29. 1 Cor. 15: 30. 1 Cor. 15: 31.	for one called Saul, of ⁴ Tarsus; for, behold, he prayeth, 12 And hath seen in a vision a man named Ananias coming in, and putting his hand on him, that he might receive his sight. 13 Then Ananias answered, Lord, I have heard by many of this man, how much evil he hath done to thy saints at Jerusalem: 14 And here he hath authority from the chief priests to bind all ⁴ that call on thy name. 15 But the Lord said unto him, Go thy way: for ⁷ he is a chosen vessel unto me, to bear my name before ⁴ the Gentiles, and ⁴ kings, and the children of Israel:

STYLES AND PRICES.

- No. 463. French Morocco, Divinity circuit, round corners, silk headband, protecting edge \$2.50
- No. 463 1/2. Persian Morocco, Divinity circuit, protecting edge, round corners, leather lined, silk sewed 3.15

SPECIMEN OF PAGE.

MINION, 8vo. Size, 5 1/8 x 7 3/4 x 1 3/4.

<i>Christ healeth the palsy and</i>	MARK, III.	<i>the withered hand.</i>
ing one sick of the palsy, which was borne of four. 4 And when they could not come nigh unto him for the press, they uncovered the roof where he was: and when they had broken it up, they let down the bed wherein the sick of the palsy lay. 5 When Jesus saw their faith, he said unto the sick of the palsy, ⁴ Son, thy sins be forgiven thee. 6 But there were certain of the	A. D. 31. CHAP. 2. v. Gen. 22: 12 Heb. 4: 13 d Ps. 108: 3 Is. 53: 11 e Job 14: 4 Ps. 120: 4 Isa. 43: 23 Rom. 8: 23 1 Sam. 16: 7 1 Chr. 28: 17 Ps. 7: 9	disciples of John and of the Pharisees fast, but thy disciples fast not? 19 And Jesus said unto them, Can the children of ⁷ the bride-chamber fast while the bridegroom is with them? as long as they have the ⁹ bridegroom with them, they cannot fast. 20 But the days will come, when the bridegroom shall be taken away from them, and then shall they fast in those days. 21 No man also seweth a piece of

STYLES AND PRICES.

- No. 378 T B. Persian Seal, Divinity circuit, leather lined, silk sewed, protecting edge \$5.00
- No. 388 T. Levant Morocco, Divinity circuit, silk sewed, calf lined, round corners, protecting edge 6.00

SPECIMEN OF PAGE.

BOURGEOIS. Size, 8½ x 5½ x 1¾.

Judgment of the wicked.

JOB, XXII.

Eliphaz reproves Job.

18 They are as stubble before the wind, and as chaff that the storm⁶ carrieth away.

19 God layeth up⁷ his iniquity for his children: he rewardeth him, and he shall know *it*.

20 His eyes shall see his destruction, and he shall drink of the

B. C. 1520.

CHAP. 21.

6 *scattered*

Ps. 1, 4.

Ps. 35, 5.

Isa. 17, 13.

Isa. 25, 5.

Hosea 13, 3.

7 That is,

2 Can^a a man be profitable unto God,¹ as he that is wise may be profitable unto himself?

3 *Is it* any pleasure to the Almighty, that thou art righteous? or *is it* gain to him, that thou makest thy ways perfect?

4 Will he reprove thee for fear of

STYLES AND PRICES.

No. 365 T. Persian Seal, Divinity circuit, leather lined, silk sewed, round corners, protecting edge \$6.25

No. 368 T. Levant Morocco, Divinity circuit, kid lined, silk sewed, round corners 8.00

Containing about 60,000 original and selected parallel references and marginal readings, and 75 pages of valuable aids to the study of the Bible.

SPECIMEN OF PAGE.

PEARL, 16mo.

Size, 6 x 4¾ x 1.

<i>Exhortations to praise God.</i>	PSALMS 97-102.	<i>Majesty of God's kingdom.</i>
1 <i>Majesty of God's kingdom.</i>	PSALM 97.	1 <i>The king's strength also loveth judgment: thou dost establish equity, thou executest judgment and righteousness in Jacob.</i>
2 <i>The church rejoices at God's judgments upon idolaters.</i>	1 many, 66, great idea.	2 <i>Exalt ye the Lord our God, and worship at his footstool: for he is holy.</i>
3 <i>The Lord reigneth: let the earth rejoice: let the multitude of isles be still thereof.</i>	2 <i>Heaven and earth are round about him: righteousness and judgment are the habitation of his throne.</i>	3 <i>Moses and Aaron among his priests, and Samuel among them that call upon his name: they called upon the Lord, and he answered them.</i>
4 <i>Will he reprove thee for fear of</i>	3 <i>A fire goeth before him, and burneth</i>	4 <i>He spake unto them in the cloudy</i>

STYLE AND PRICE.

No. 528 S I. French Morocco, Divinity circuit, protecting edge, silk headband, gilt edge, elastic band \$1.10

No. 552. Extra Levant Morocco, Divinity circuit, calf lined to edge, silk sewed, round corners 4.00

SPECIMEN OF PAGE.

RUBY, 16mo. Size, 4 x 6¼ x 1¼.

Moral virtues	PROVERBS, XV.	and contrary vices.
1 Judeth it not: but knowledge is easy unto him that understandeth.	B.C. 1000.	29 He that is slow to wrath is of great understanding: but he that is hasty of spirit exalteth folly.
7 Go from the presence of a foolish man, when thou perceivest not in him the lips of knowledge.	CHAP. 14.	30 A sound heart is the life of the flesh: but envy the rottenness of the bones.
8 The wisdom of the prudent is to understand his way: but the folly of fools is deceit.	Eccl. 17, 24.	31 He that oppresseth the poor reproacheth his Maker: but he that honoureth him hath mercy on the poor.
9 Fools make a mock at sin: but among the righteous there is favour.	1 La. 12, 30.	32 The wicked is driven away in his wickedness: but the righteous hath hope in his death.
10 The heart knoweth his own bitterness: and a stranger doth not intermeddle with his joy.	1 Cor. 3, 19.	33 Wisdom resteth in the heart of him that hath understanding: but that which is in the midst of fools is made known.
11 The house of the wicked shall be overthrown: but the tabernacle of the upright shall flourish.	Eccl. 10, 23.	
12 There is a way which seemeth	1 Job 8, 15.	
	Eccl. 16, 23.	
	J. Rom. 6, 21.	
	4 Eccl. 2, 2.	

STYLE AND PRICE.

- No. 476 S I. French Morocco, Divinity circuit, protecting edge, silk headband . . . \$1.60
 No. 491. Extra Levant, Divinity circuit, calf lined to edge, silk sewed, round corners . . . 4 25

SPECIMEN OF PAGE.

MINION, 8vo. Size, 8 x 5¼ x 1¼.

The people murmur.	EXODUS, XVII, XVIII.	Amalek discomfited.
30 So the people rested on the seventh day.	B. C. 1491.	7 And he called the name of the place Massah, and Meribah, because of the chiding of the children of Israel, and because they tempted the LORD, saying, Is the LORD among us, or not?
31 And the house of Israel called the name thereof Manna: and it was like coriander seed, white; and the taste of it was like wafers made with honey.	CHAP. 16.	8 ¶ Then came Amalek, and fought with Israel in Rephidim.
32 ¶ And Moses said, This is the thing which the LORD commandeth, Fill an omer of it to be kept for your generations; that they may see the bread wherewith I have fed you in the wilderness, when I brought you forth from the land of Egypt.	Numb. 11, 7.	9 And Moses said unto Joshua, Choose us out men, and go out, fight with Amalek: to-morrow I will stand on the top of the hill with the rod of God in mine hand.
	Ex. 9, 4.	
	9 ch. 25, 16, 21.	
	ch. 40, 29.	
	Numb. 17, 10.	
	Deut. 10, 9.	
	1 Ki. 8, 9.	
	c. Numb. 33, 38.	
	Deut. 8, 2, 3.	
	Neh. 9, 20.	
	John 6, 31.	
	49.	
	d. Josh. 5, 12.	

STYLE AND PRICE.

- No. 388 S I. Levant Morocco, Divinity circuit, calf lined, silk sewed, protecting edge . . . \$5.75

SPECIMEN OF PAGE.

BOURGEOIS, 8vo. Size, 8½ x 6 x 1¼.

21 For what pleasure hath he in his house after him, when the number of his months is cut off in the midst?
22 Shall any teach God knowledge? seeing he judgeth those that are high.
23 One dieth in his full strength, being wholly at ease and quiet.
24 His breasts are full of milk, and his bones are moistened with marrow.
25 And another dieth in the bit-

ⁱ iniquity. Ex. 20, 5.
^s in his very perfection, or, in the strength of his perfection.
⁹ Or, milk yields.
^c Eccl. 9, 2.
^d Isa. 14, 11.
¹⁰ the tent of the tabernacles of the wicked.
^e Pro 16, 4.
^f Nahum 1, 2.
² Pet. 2, 9.

judgment?
5 Is not thy wickedness great? and thine iniquities infinite?
6 For thou hast taken a pledge from thy brother for nought, and stripped the naked of their clothing.
7 Thou hast not given water to the weary to drink, and thou hast withholden bread from the hungry.
8 But as for the mighty man, he had the earth; and the honourable man dwelt in it.

STYLES AND PRICES.

- No. 368. Levant Morocco, Divinity circuit, calf lined, silk sewed, protecting edge \$7.00
- No. 369. Extra Levant, Divinity circuit, kid lined, silk sewed 9.00

COLLINS' "WIDE MARGIN" STUDENTS' REFERENCE BIBLE,

FOR MSS. NOTES.

MINION, 8vo. Size, 6¼ x 9 x 1¼.

Tidings sent to David.

2 SAMUEL, XIX.

He mourns for Absalom.

Joab's armour compassed about and smote Absalom, and slew him.
16 And Joab blew the trumpet, and the people returned from pursuing after Israel: for Joab held back the people.
17 And they took Absalom, and cast him into a great pit in the wood, and laid a very great heap of stones upon him: and all Israel fled every one to

R. C. 1023.
CHAP. 18.
1 Joab. 7, 36
Jer. 22, 18, 19
1 Gen. 14, 17
1 ch. 14, 27
Job 18, 17, 19, 21
1 Ps. 49, 11

fell down to the earth upon his face before the king, and said, Blessed be the LORD thy God, which hath delivered up the men that lifted up their hand against my lord the king.
29 And the king said, Is the young man Absalom safe? And Ahimaaz answered, When Joab sent the king's servant, and me thy servant, I saw a great tumult, but I knew not what

STYLE AND PRICE.

- No. 399. Levant Morocco, Divinity circuit, protecting edge, silk sewed, red under gold edges, kid lined \$9.00

PEARL. Size, 3½ x 5½ x 1.

<i>Prayers for deliverance</i> PSALMS 140-143 <i>from enemies.</i>	
14 I will praise thee, for I am fearfully and wonderfully made: marvelous are thy works; and that my soul knoweth right well.	13 Surely the righteous shall give thanks unto thy name; the upright shall dwell in thy presence.
15 My substance was not hid from thee, when I was made in secret, and	PSALM 141.
	1 David prays that his suit may be acceptable, 2 his conscience sinore, 3 and his life safe from

- No. 924. French Morocco, limp, red under gold, fast back, lettered on side, round corners, \$.70
- No. 90/125. Persian Calf, new diced centre, section circle grain, red under gold, round corners 1.25
- No. 90/126. Persian Levant, gilt roll, red under gold, fast back, round corners 1.25

RUBY. Size, 5½ x 3½ x 1½.

<i>David professes</i> PSALMS XXV—XXVII <i>his trust in God.</i>	
3 He shall receive the blessing from the LORD, and righteousness from the God of his salvation.	LORD; for he shall pluck my feet out of the net.
6 This is the generation of them that seek him, that seek thy face, O Jacob. Selah.	16 Turn thee unto me, and have mercy upon me; for I am desolate and afflicted.
	17 The troubles of my heart are en-

- No. 892. French Morocco, limp red under gold, fast back, lettered side, round corners . \$.80
- No. 80/72. Persian calf, new diced centre with gilt border, circle grain, red under gold edges, round corners, lettered sides and back 1.65

SPECIMEN OF PAGE.

MINION, 12mo. Size, 6 x 4¼ x 1¼.

6 Remember, O LORD, thy tender mercies and thy loving-kindnesses; for they have been ever of old.	22 Redeem Israel, O God, out of all his troubles.
7 Remember not the sins of my youth, nor my transgressions: according to thy mercy remember thou me for thy goodness' sake; O LORD.	PSALM XXVI. <i>David's love to God's house.</i> <i>A Psalm of David.</i>
8 Good and upright is the LORD; therefore will he teach sinners in the way.	JUDGE me, O LORD; for I have walked in mine integrity: I have trusted also in the LORD; therefore I shall not slide.
	2 Examine me, O LORD, and prove me; try my reins and my heart.

STYLE AND PRICE.

- No. 807½. French Morocco, Divinity circuit, protecting edge, round corners, lettered side, silk headband \$2.00

REFERENCE BIBLES.

PEARL TYPE. Size, 4 x 6 x 1.

STYLE AND PRICE.

No. 50/130. Persian Calf, padded, new diced centre, section circle, red under gold, fast back \$1.65

RUBY TYPE. Size, 4 x 6 x 1 1/2.

STYLES AND PRICES.

No. 40/72. Persian Calf, padded, new diced centre, gilt lettering side and back, round corners, red under gold \$2.00
No. 40/73. Persian Levant, gilt roll, red under gold, round corners, fast back 2.00

FOR OTHER STYLES, SEE PORTABLE REFERENCE SERIES, PAGES 9 to 12.

THE COLLINS' BIBLES.

Special attention is called to the following popular numbers.

TEACHERS' BIBLES, RUBY TYPE.

No. 496. French Morocco, Divinity circuit, round corners \$1.88
No. 499. Extra Levant, calf lined to edge, round corners, silk sewed 5.25

We invite a comparison of the price and quality of these books with any other ruby type teachers' Bible on the market. (Catalogue page 5.)

BOURGEOIS TYPE.

No. 365 T. Persian Morocco, Divinity circuit, round corners, silk sewed \$6.25
No. 368 T. Levant Morocco, Divinity circuit, round corners, silk sewed 8.00

Just what is needed — a large type teachers' Bible at a moderate price. (Catalogue page 8.)

BIBLE, TEXT ONLY, EXTRA LARGE FACE MINION TYPE.

No. 807 1/2. French Morocco, Divinity circuit, round corners \$2.00
Very popular — a large type in a small book. (Catalogue page 16.)