

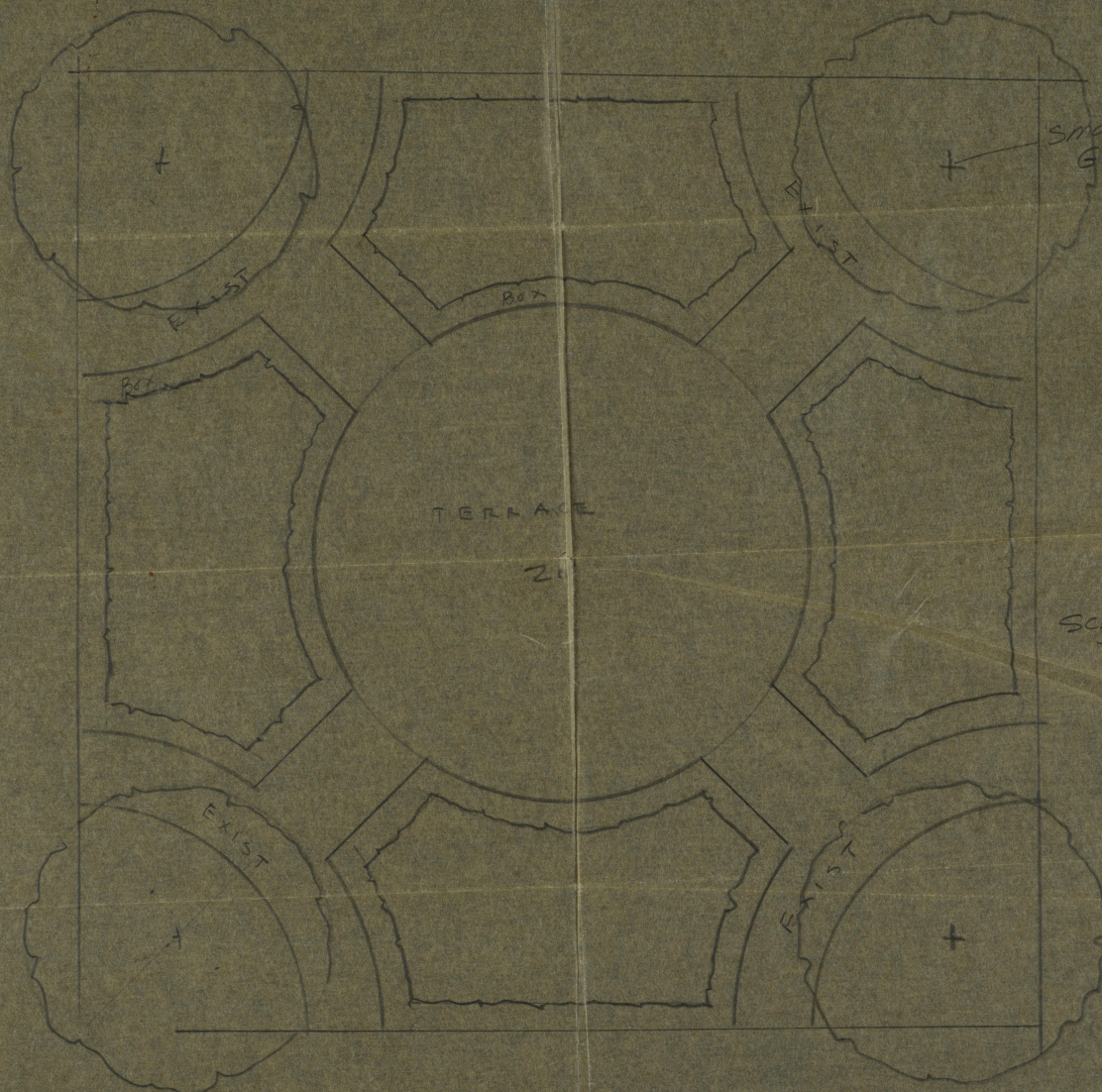

SCALE. 1"=4'-0"



SMALL TREES &  
Ground Cover -

TERRACE  
20

SCALE: 1" = 4'-0"

EXIST

EXIST

EXIST

EXIST

807

807



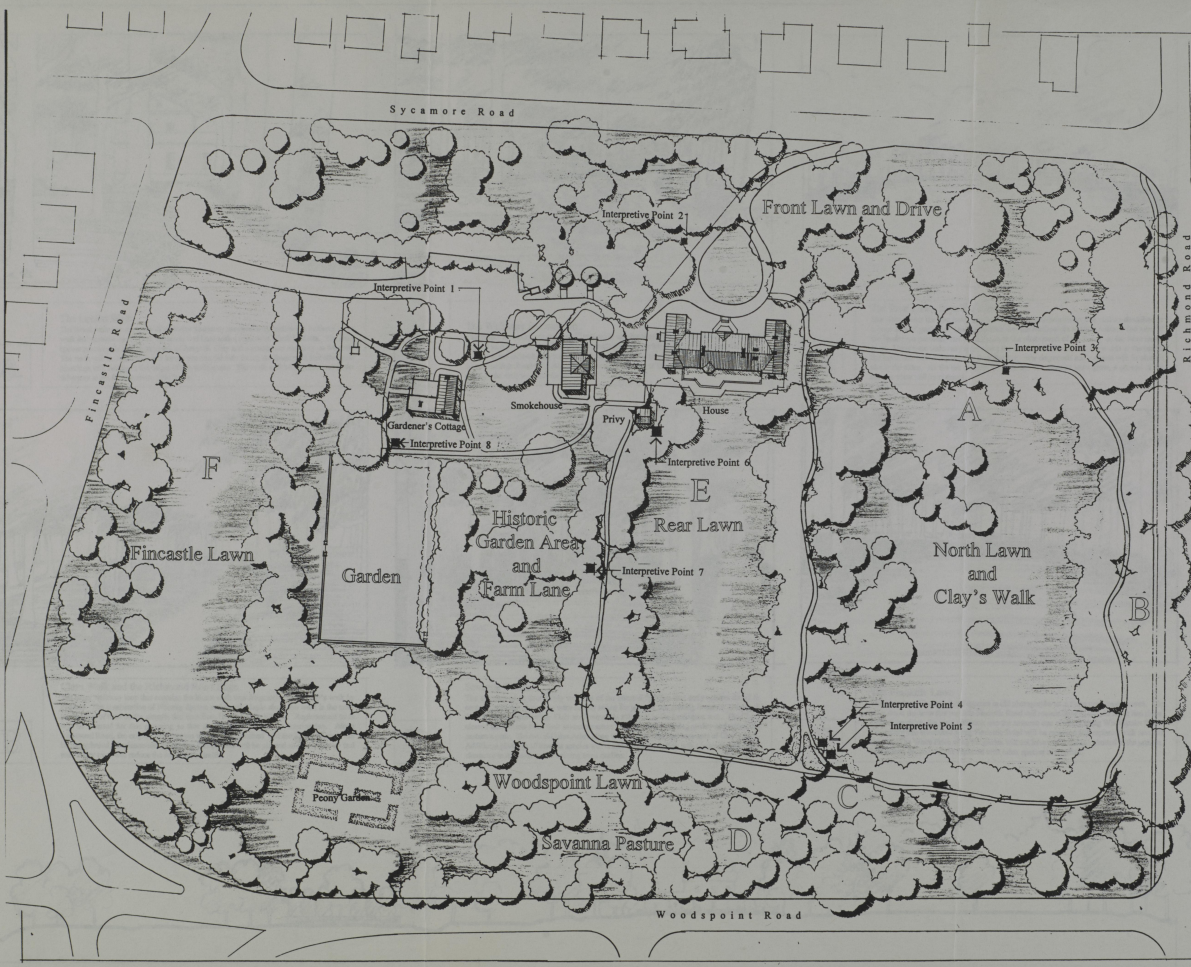

**A Plan to Preserve Ashland's Landscape**

*I am in one respect better off than Moses. He died in sight of without reaching the promised land; I occupy as good a farm as any that he would have found, if he had reached it. It has been acquired not by hereditary descent, but by my own labor.*

— Henry Clay in an 1847 letter to Rodney Dennis of Hartford, Connecticut.

**Introduction**  
Henry and Lucretia Clay and members of their family took immense interest in the development of Ashland as a landscape reflective of a progressive Kentucky farm. They delighted in the pleasure that the grounds near the house provided to their guests and Henry Clay extended frequent invitations to travelers to visit his farm and grounds.

Ownership of Ashland passed from the Clay family to Kentucky University, the McDowell family, the Bullock family, and finally to the Henry Clay Memorial Foundation. All the owners maintained the Clay legacy in the landscape to a great extent, and the basic configuration of the grounds represents the Clay family's work. The 20 acres that now comprise the estate include most of the original domestic landscape of Ashland. The grounds also include the edges of what were savanna pastures when the Clays and McDowell lived at Ashland.

Incremental change combined with disastrous storms in the 1990s have threatened the historic legacy represented in Ashland's grounds. Many trees that once defined the great lawns and pathways are gone. Remaining trees that were planted during Henry Clay's life are at an advanced age. A large number of the youngest trees on the grounds are volunteers and many are poor specimens of their species.

Restoration of the house and other buildings at Ashland was completed in 1993 leading to increased visitation and interest in the history of Ashland. This has created a greater need for interpretation of the grounds and their connection to what was historically a large farm.

These conditions precipitated the development of the master plan to guide the preservation and interpretation of the grounds.

**Historic Documentation**  
Historic sources that were consulted in the planning process included historic photographs, accounts written by visitors and residents of Ashland, and period descriptions of the estate by journalists and other authors. Reports of recent archeological reports studies and field observation of the site added to the body of information.

The historic information was used to understand the evolution of the Ashland landscape. Historic land uses and specific features were located on plans of the grounds and then correlated with historic photographs to develop a sense of landscape character in each location. Plant species were also identified in the photographs to supplement information for a historic plant list.

**Tree Inventory**  
An inventory was made of all trees on the Ashland grounds. The tree inventory required a major volunteer effort to record the location, species, and size of nearly 500 trees on plans of the grounds. An assessment was then made of the age and of any maintenance problems for every tree. The age of each tree was determined and then an assessment made of any maintenance conditions associated with the tree. The assessments determined maintenance activities that should take place to conserve the existing stock of historic trees, and they determined the need for planting replacements for specific trees at Ashland.

**Ashland Landscape Master Plan**  
Ashland, the Henry Clay Estate Lexington, Kentucky

The Henry Clay Memorial Foundation  
120 Ryanwood Rd., Lexington, Kentucky 40502

Ned Crankshaw, ASLA  
Landscape Architect  
Specialty: Landscape Preservation  
442 South Maple Street, Winchester, Kentucky 40391 (606) 744-0638

Jeff Singer, Certified Arborist  
2114 Shaping Ground Rd., Shaping Ground, KY 40379 (502) 513-6222

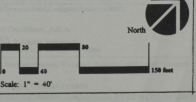



**The Locust Walk**  
The locust walk was a section of walkway frequently mentioned by visitors to Ashland. This walk that extended north from the house was lined with a number of black locusts. The trees appear prominently in a photograph of James B. Clay and a young boy standing on the path. The walk will be replanted with locust trees on the side facing the front yard and other new plantings will reinforce the edges of the walk space. The walk will be reconstructed to the driveway at the front corner of the house.

A

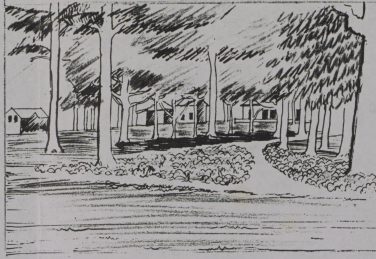

**The Walkway Intersection**  
The walkway intersection where Clay's walk and the walk around the rear lawn join once created an island that was planted with myrtle (probably what we know as periwinkle). The segment of the old walk can still be clearly seen on the ground. The walkway intersection will be re-established and new tree plantings along the corner of the north lawn will reinforce the edge of the walkway and the lawn.

C



**The Rear Lawn from the Terrace**  
The view across the rear lawn once looked into a savanna pasture that visitors described as a large area of parkland. During the time that the McDowell's lived at Ashland this view of the landscape persisted and can be seen in the photograph of the family on the lawn tennis court. There were underray trees along the sides of the lawn. The dogwoods at the end of the lawn will not be replaced as they decline; new dogwoods and redwoods will be planted along the sides. As the savanna trees on the Woodpoint lawn grow, a portion of the historic view will be restored.

E



**Clays Walk and the Richmond Road Edge**  
The larger walkway loop that contains the locust walk was frequently called Clay's walk by visitors. The combination of Norway Spruce and Sugar Maple along the walk is the most recent group of trees on the grounds that date from Henry Clay's lifetime. Replacement trees will be planted for this grouping so that it may continue without interruption. Along Richmond Road, the original walk curves will be reestablished, and the buffer of trees will be strengthened. Replacements for existing canopy trees will be planted and new canopy and understorey trees will reduce the intrusion of traffic.

B

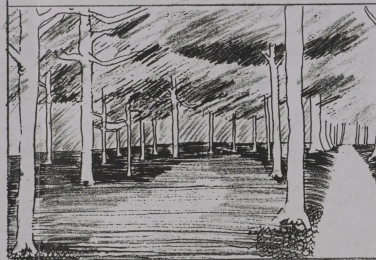

**Savanna Pasture**  
The savanna plant community was one of the unusual features that early settlers found in central Kentucky. Savanna were usually mowed for pasture, but grazing livestock prevented the trees from regenerating. Only small remnants still exist in the Lexington area. The Clays cleared underbrush from their savanna pasture to improve the grazing quality and called the pasture a park. The two old Blue Ashes along Woodpoint Road are remnants of Clay's park. Additional plantings of savanna species will create a long transition into a more savanna-like character in this area as the existing trees decline.

D



**The Fincastle Lawn**  
The area along Fincastle Road appears in old photographs as a more open pasture area. The view down the lawn that parallels Fincastle Road will remain open to the old fence line ridge. Behind the ridge, the view will look into the savanna tree planting along Woodpoint Road. Some poor tree specimens along Fincastle Road will be removed and replaced with savanna species. The White Pines along the garden will not have replacements planted at the present, but as they decline will be replaced with other species of conifers.

F

**Interpretation plan**  
A plan for site interpretation at Ashland has been developed that will communicate the range of events and activities on the property during all phases of its history. The plan does not prescribe a specific method for all interpretation, but focuses on interpretive themes and locations. The interpretive program will evolve over time and in keeping with experience and funding levels. Interpretive themes were linked to specific places on the site where each theme could be best communicated. The interpretive themes that will be linked to each interpretive location are listed below and keyed on the site plan:

- 1 Introduction  
Ashland grounds and farm  
Work area
- 2 Ashland, Lexington, and surrounding country c. 1815  
Trees and shrubs imported by Henry Clay  
The subdivisions of Ashland
- 3 Clay's walk and the locust walk  
Turnpikes and Richmond Road
- 4 Estates contemporary with Ashland  
Trees  
Social use of the grounds
- 5 Savanna and savanna pasture  
Ashland farm's extent  
Animal husbandry at Ashland
- 6 Existing interpretation  
Pool
- 7 Horticulture and agronomy at Ashland  
Garden locations  
Views of farm road, pasture, and barn
- 8 Henry Fincher Kenney  
Garden Club of Lexington  
Design motif and historic sources

**Preservation Plan**  
Preservation of the grounds is the most important part of the plan. Preservation activities will include planting replacements for trees that are aged or in poor condition, planting new trees that will help to restore the historic character of spaces in the landscape, bringing some walk segments back into their historic alignment, and restoring savanna tree species to the pasture remnant along Woodpoint Road. The plan makes recommendations for management of the landscape that will ensure that hedges, fence lines, and other historic remnants of the farm are protected. Unusual botanical features including patches of Running Buffals Clover and Trout Lily are protected in the plan. Additional research needs, particularly archaeological investigation, are also identified in the preservation plan. Preservation activities have been organized so that they are linked with the major landscape spaces on the Ashland grounds. This will allow funding and activity to be targeted to one area at a time in a concerted effort. These major spaces include the following:

- The Front Lawn and Drive
- Clay's Walk and the North Lawn
- The Rear Lawn
- The Woodpoint Lawn Savanna Pasture Area
- The Historic Garden and Farm Road Area
- The Fincastle Lawn

In each area, the need is great for protective maintenance and restoration of historic landscape character. Henry and Lucretia Clay left a tangible legacy in the landscape of their farm. It is our challenge in the present to act to preserve that legacy.

*...and though we might not live to behold the occurs which we ourselves have planted endure to be the patriarchs of the forest, yet all recipients should be the objects of a very pleasing attention which would well repay our labour; and others would possess the advantage of its magnificent growth and expansion which a timely foresight had taught us to anticipate.*  
— Henry Clay, Jr. in 1815 letter to his father.

**Ashland Landscape Master Plan**  
Ashland, the Henry Clay Estate Lexington, Kentucky

The Henry Clay Memorial Foundation  
130 Spymore Road, Lexington, Kentucky 40502

Neel Crankshaw, ASLA  
Landscape Architect  
Historic Landscape Preservation  
442 South Maple Street, Winchester, Kentucky 40391 (606) 744-0628

Jeff Elings, Certified Arborist  
2316 Saugus Court, Lexington, KY 40529 (502) 533-4222

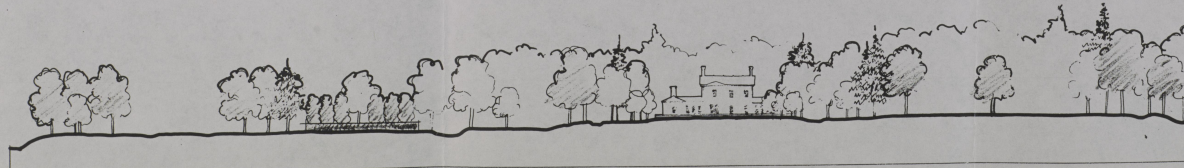

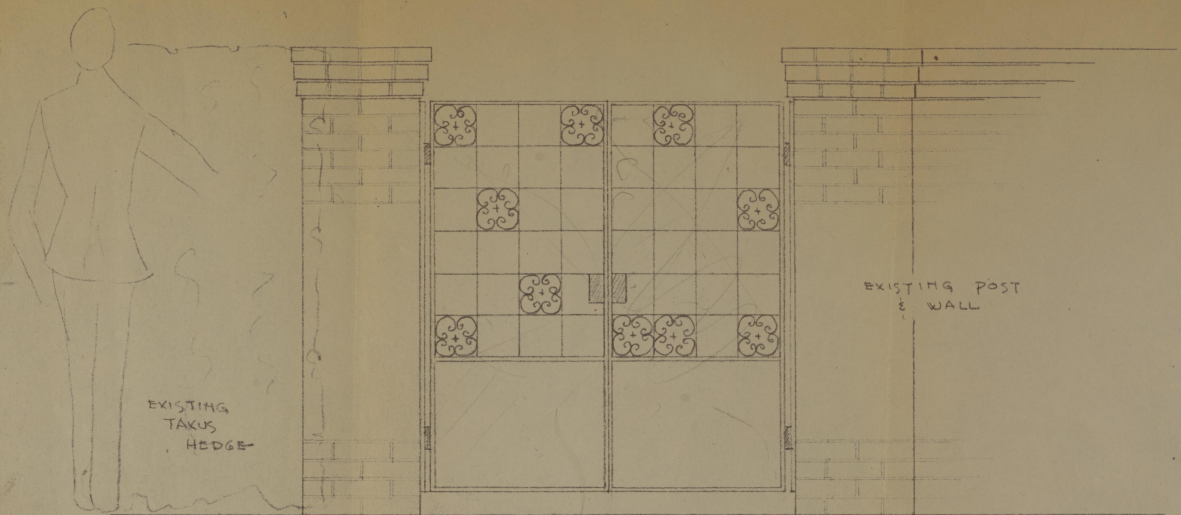

NEW POST

ELEVATION

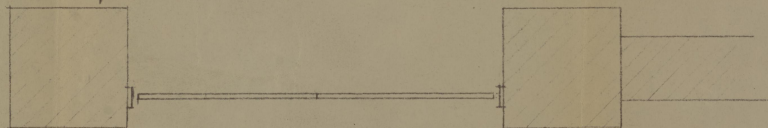

PLAN

GATE DETAIL FOR  
 ASHLAND - HOME OF HENRY CLAY  
 HENRY FLETCHER KENNEY LAND. ARCH.  
 SCALE: 3/4" = 1'-0" 12-58

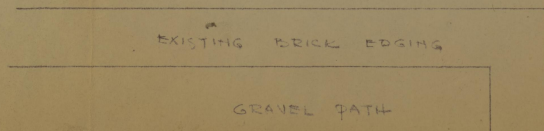

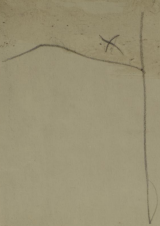

Lakewood Dam

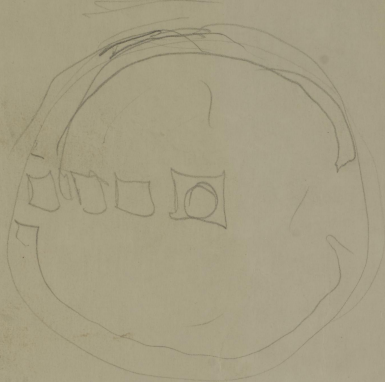

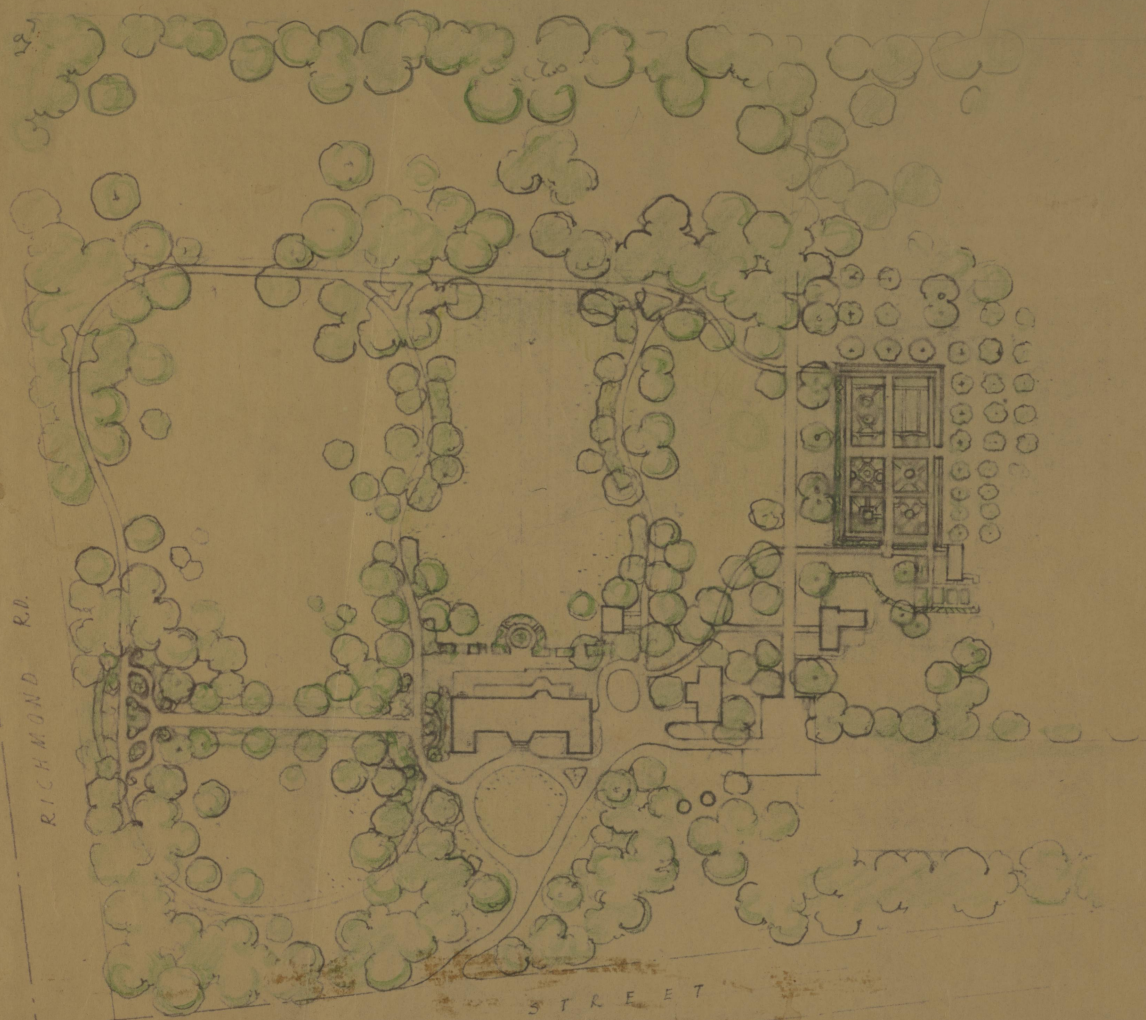

GENERAL LANDSCAPE PLAN  
FOR THE RESTORATION OF  
ASHLAND - HOME OF HENRY CLAY  
LEXINGTON KENTUCKY  
SCALE: 1" = 130' (APPROXIMATE)  
HENRY FLETCHER KENNEY - LANDSCAPE ARCHITECT



GARDEN

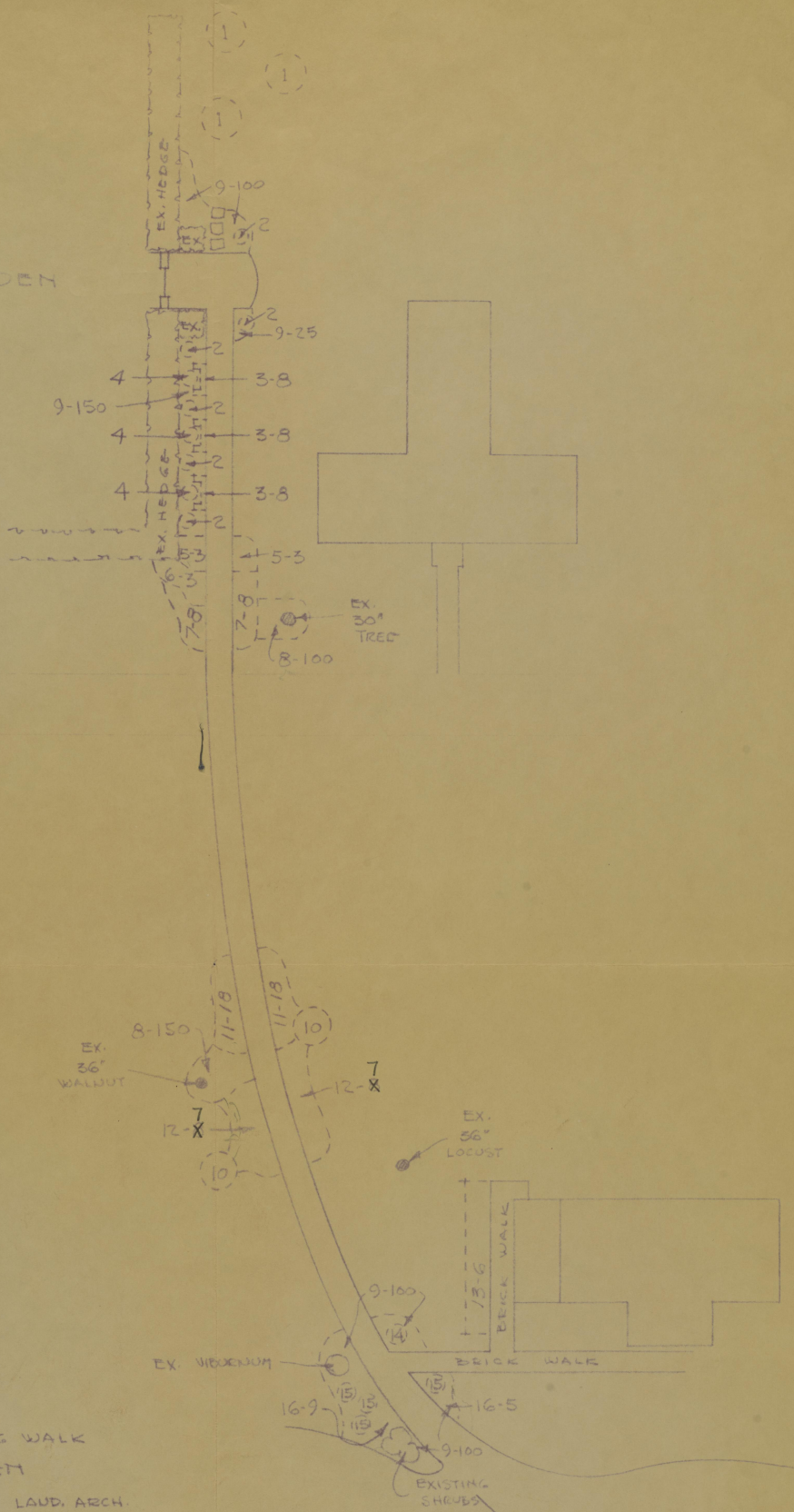

PLANTING PLAN - ALONG WALK  
ASHLAND GARDEN

HENRY FLETCHER KENNEY LAUD. ARCH.

SCALE: 1" = 20'-0" 10-65

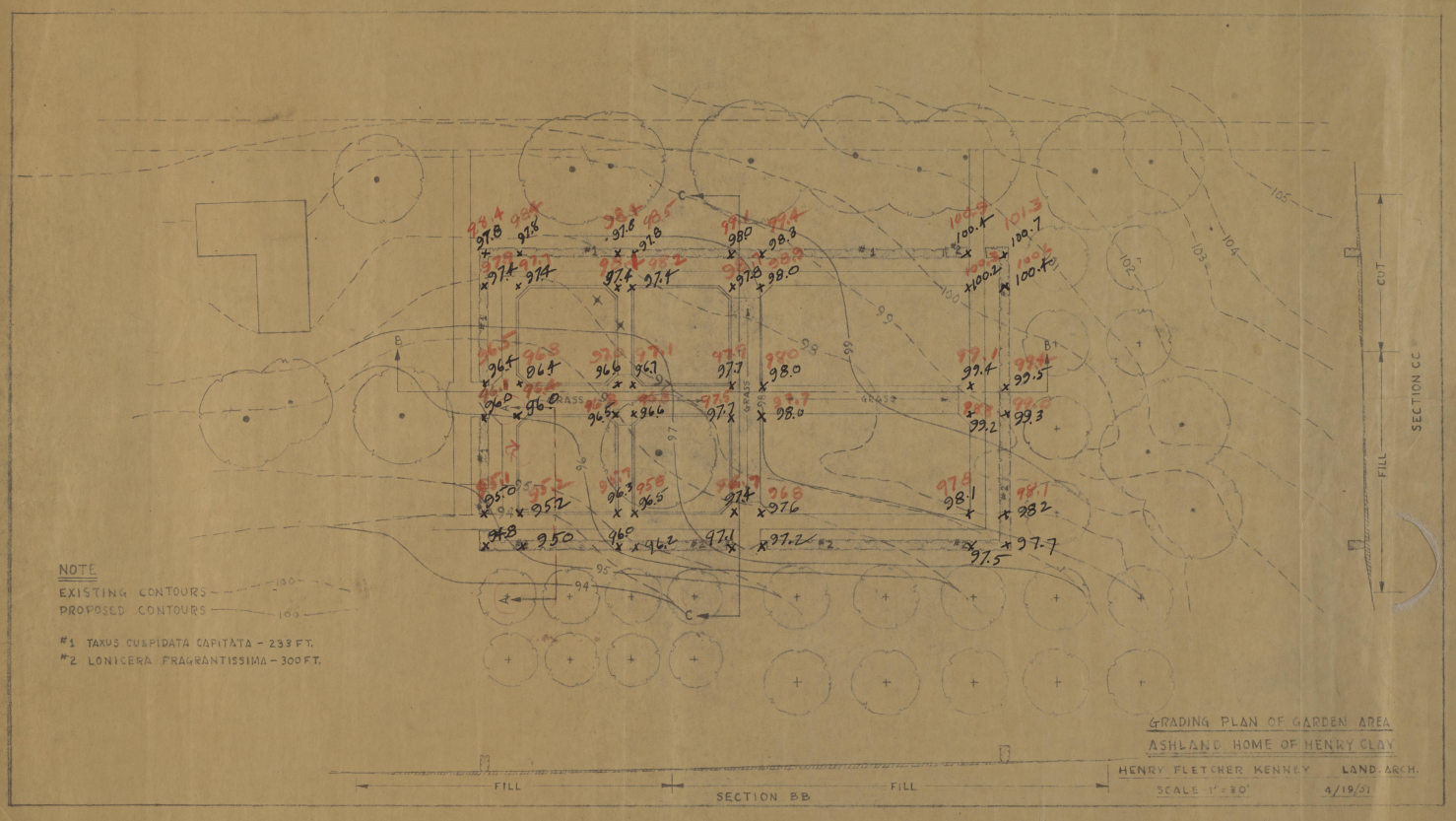

**NOTE**  
 EXISTING CONTOURS ———— 100  
 PROPOSED CONTOURS ———— 103  
 #1 TAXUS CUSPIDATA CAPITATA - 233 FT.  
 #2 LONICERA FRAGRANTISSIMA - 300 FT.

GRADING PLAN OF GARDEN AREA  
 ASHLAND HOME OF HENRY CLAY  
 HENRY FLETCHER KENNEY LAND ARCH.  
 SCALE 1" = 30'  
 4/19/31

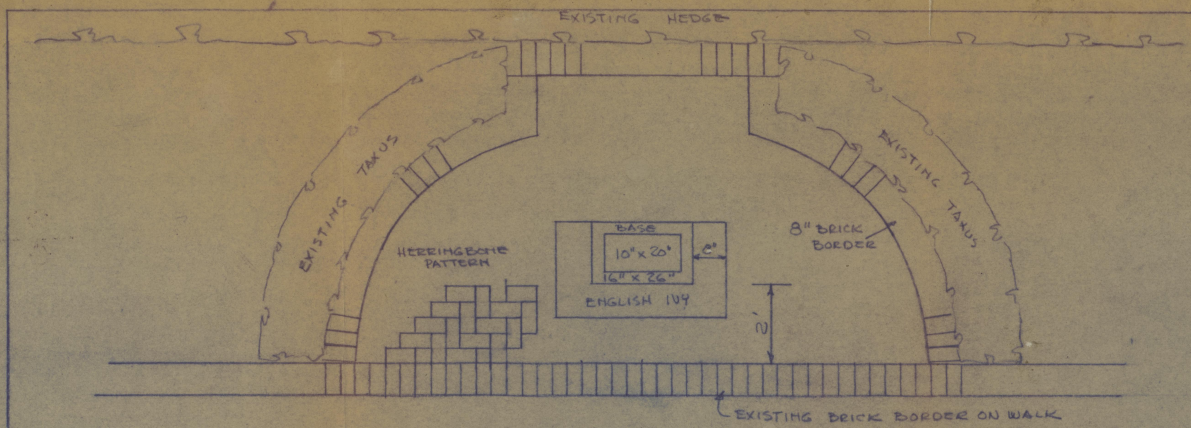

GRAVEL WALK

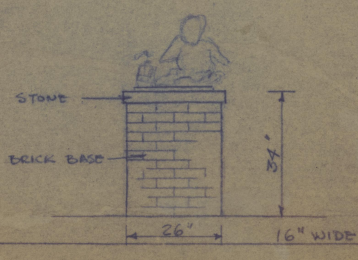
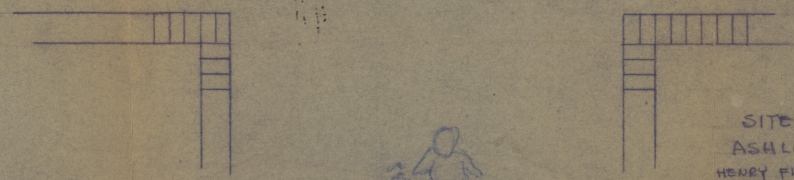

SITE FOR STATUE  
 ASHLAND GARDEN  
 HENRY FLETCHER KENNEY LAND ARCHTS.  
 WILLIS HANSON  
 NO EXACT SCALE 4-72

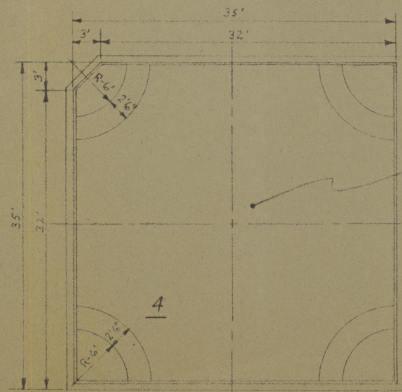
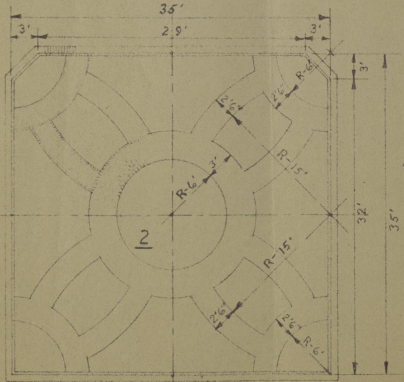
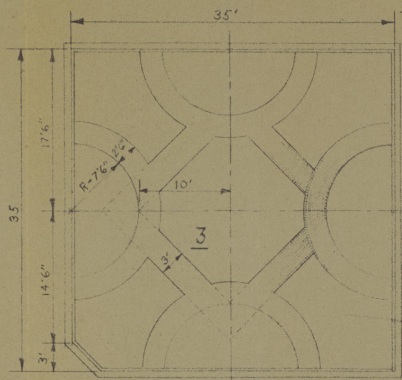
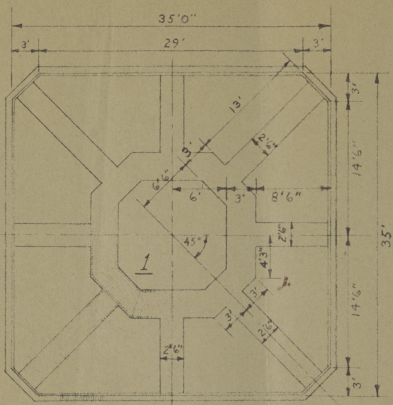

DETAIL OF CENTER TO BE SUPPLIED LATER

PARTERRE LAYOUT  
 ASHLAND HOME OF HENRY CLAY  
 HENRY FLETCHER KENNEY LAND ARCH.  
 SCALE - 1"=10' 10/1/51

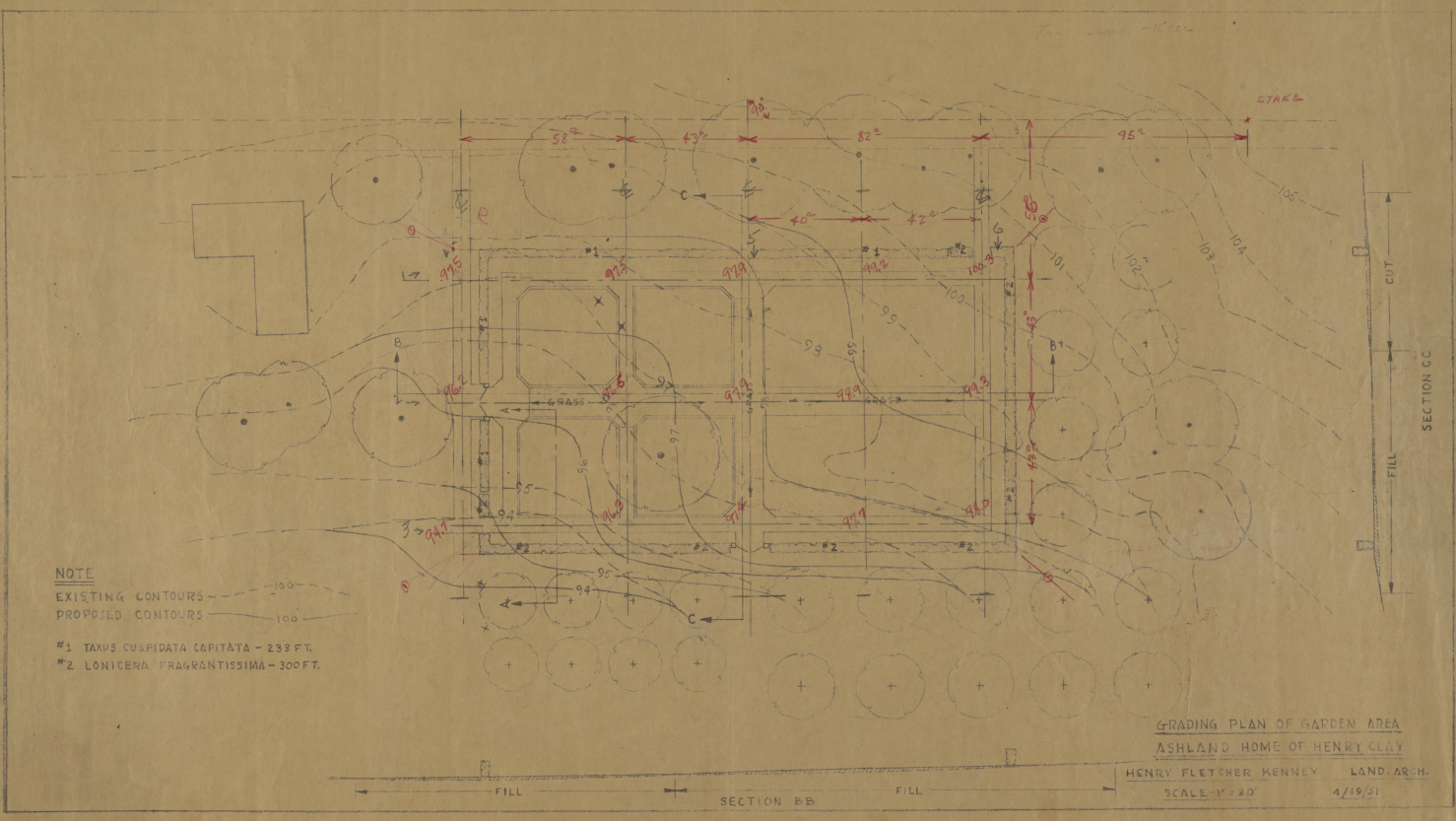

NOTE  
 EXISTING CONTOURS - 100  
 PROPOSED CONTOURS - 100  
 #1 TAXUS CUSPIDATA CAPITATA - 233 FT.  
 #2 LONICERA FRAGRANTISSIMA - 300 FT.

GRADING PLAN OF GARDEN AREA  
 ASHLAND HOME OF HENRY CLAY  
 HENRY FLETCHER KENNEL LAND ARCH.  
 SCALE 1" = 20'  
 4/19/21